

**VENOM V-SERIES & VENOM**

LUXURY FIFTH WHEEL TOY HAULERS



RECREATIONAL  
VEHICLES

# VENOM



**VENOM V-SERIES & VENOM**  
LUXURY FIFTH WHEEL TOY HAULERS



INTERIOR

VENOM V-SERIES

# ALL-NEW & AFFORDABLE

**VENOM V-SERIES** is an affordable 101-inch wide-body. Several versatile, spacious floorplans include cargo areas from 11 to 18 feet in length, and also offer a variety of living, kitchen and sleeping spaces.

Standards include:

- auto-leveling
- generator prep
- electric-tilt king beds
- residential kitchen

Options available:

- central vac
- 3rd 15,000 BTU A/C
- Party Patio Package



**ENTERTAINMENT CENTER**

- LED TV
- 40" wideview fireplace
- glass accent cabinets

V3815TK | Havana décor



V-Series **LUXURY BATHROOM** incorporates linen closet, bathroom drawers, stainless steel sink, 36-inch shower with shelf space and skylight. (V3815TK shown)



**THEATER SEATING** with heat, massage, and LED lighted cup holders (on select models) (V3815TK shown)







4013TK | Havana décor

## UPSCALE STANDARDS & LUXURIOUS OPTIONS

INTERIOR  
VENOM

**VENOM's** 101-inch wide-body toy hauler comes with standards like all-weather insulation, chef's kitchen, glazed maple cabinetry, a 40-inch fireplace and central vacuum system.

Venom is offered in several floorplans, some with washer/dryer prep, all with multiple spacious slides. And our 2-year hitch-to-bumper full-timer's warranty ensures complete peace of mind.

**KITCHEN** includes maple-glazed, hand-crafted solid wood cabinetry, large pantry, hutch, solid-surface countertops, deep stainless steel under-mount sink, and pull-down sprayer.



Enjoy **LUXURY SLEEP** with Venom's all-new 70 x 80-inch walk-around electric-tilt king bed with under-bed storage. Tilt beds improve circulation and breathing, decrease congestion, and improve digestion. (4013TK shown)



**COMFORTABLE BEDROOM** features generous cabinets, sold-wood slide-out fascia, mirrored sliding closet doors, under-bed storage, 32-inch flat-panel TV, designer valances, washer/dryer prep, and built-in dresser with **HIDDEN STORAGE FOR VALUABLES**. (4013TK shown)

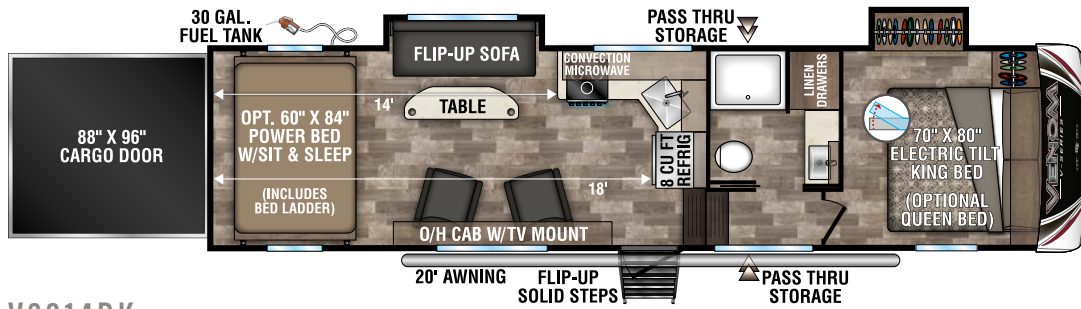

### V3214DK

UVW - 10,230 | Exterior Length - 35' 0" | Sleeps 7

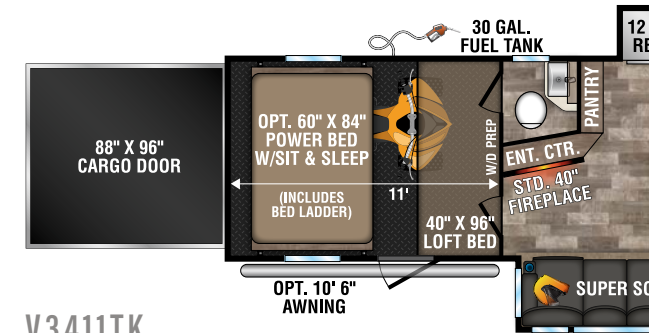

### V3411TK

UVW - 12,410 | Exterior Length - 38' 10" | Sleeps 8

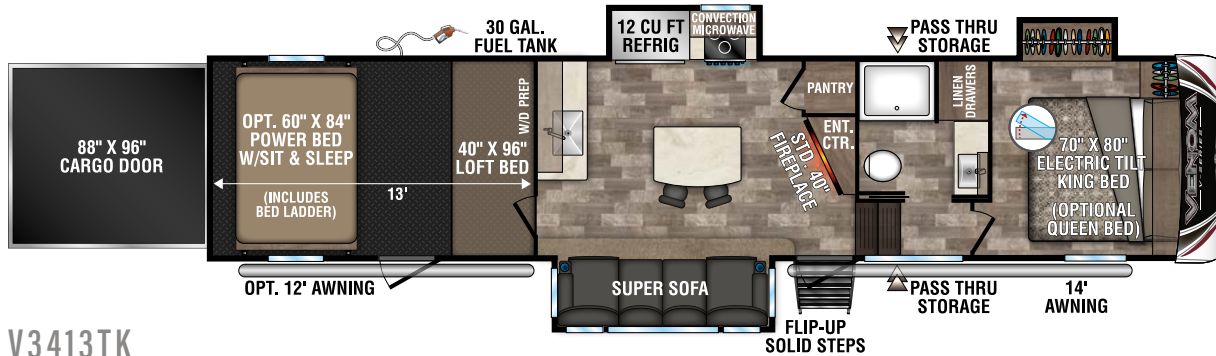

### V3413TK

UVW - 12,430 | Exterior Length - 40' 11" | Sleeps 8

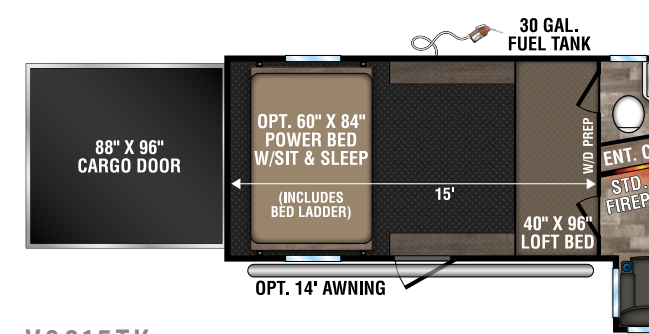

### V3815TK

UVW - 13,470 | Exterior Length - 42' 10" | Sleeps 8

#### CONSTRUCTION FEATURES

- 101" Wide-Body Construction
- Extra-Reinforced, Heavy Duty, High-Gloss Front Cap
- Radius Aerodynamic Front Cap (provides better turning radius & increased fuel economy)
- 2" x 3" Fully Welded Aluminum Floor Joists
- 2" x 2" Fully Welded Aluminum Sidewall Framing
- Lamilux® Gelcoat Fiberglass
- Double-Insulated & Heated Holding Tanks (R-38 above & below tanks)
- R-11 2" Sidewalls (w/EGS metal backing strips to hold up all interior cabinets)
- 1-Piece, Seamless, Walk-on, Tufflex Roofing Material w/15-Year Warranty
- Fully Vented Attic System
- 3/8" Roof Decking (fully walkable)
- 5/8" Tongue & Groove, Screwed & Glued Plywood Floor Deck
- Pex® In-Floor Heated Waterlines & Kitchen Gray Pipes (all waterlines & drains are located above all insulation)

- Fully-Enclosed & Heated Underbelly w/Directly Heated Holding Tanks

#### EXTERIOR FEATURES

- 7,000# Dexter® Axles w/Auto-Adjusting Brakes
- 8-Lug Heavy-Duty Aluminum Rims w/16" G-Range Nitro-Filled Radial Tires
- 100% Exterior LED Running Lights, Taillights & Backup Lights
- Electric Power Awning w/LED Lights
- Propane Bottles (2 x 30 LBS) on Same Side of Coach for Easy Access
- Side Slam Latch Baggage Doors (where applicable) w/Magnet Catches for Full Access to Storage
- 3" x 14" In-Floor Straight Line Heating System w/35,000 BTU Furnace
- 12 GAL Gas/Electric Hot Water Heater
- Ramp Door LED Lighting
- LED Docking Light & Sewer Hookup Light
- Dual Swing-Away Assist Grab Handle
- Underneath Spare Tire w/Hoist
- Roof Ladder

- Heated Water Convenience Center (includes black tank flush, power fresh tank water fill, winterizing system, outside shower)
- Fully-Finished, Heated & Sealed Basement Storage Compartment (only available w/All-Weather Insulation PKG)
- Heated & Enclosed Dump Valves
- Satellite Pre-Wire in Both the Convenience Center & Roof
- LED Lighted Outside Speakers
- LP Quick Connect

#### LIVING ROOM / KITCHEN FEATURES

- Built-In Silverware Drawer
- Storage Shelf under Kitchen Sink
- All Kitchen OH Cabinets have Shelf & Extra-Tall Slide Lips
- Heavy-Duty 100# Drawer Glides on Every Drawer
- Baltic Birch Drawer Boxes
- Decorative Lighting above Many Cabinets
- Window in Kitchen (in most models)

- 5" Stainless Steel Cabinet Hardware
- Window Roller Shades Throughout
- 3/8" Re-Bond Carpet Pad w/22 OZ Residential Carpet
- Stainless Steel Appliances
- Extra-Large Light Switches
- Ceiling Crown Molding
- 100% LED Ceiling & Cabinet Lights w/ Multiple On/Off Switches
- Deluxe Residential-Style Furniture
- Living Room HD Flat Panel TV on Bracket (includes exterior mount)

#### GARAGE / RAMP AREA FEATURES

- Built-In Dovetail
- Garage Entry Door (model specific)
- (2) Garage Ceiling Speakers

#### BATHROOM / BEDROOM FEATURES

- Skylight Over Shower
- Porcelain Foot-Flush Toilet
- Extra-Wide Hall (going up into bedroom & pocket door from hall into the bathroom - most models)
- Towel Bar in Bathroom (where applicable)

- 12V Fan in Bathroom
- Extra-Large Under-Bed Storage
- Luxurious Bedspread
- Padded Headboard w/Hidden Storage

#### OPTIONS (EXTERIOR)

- 3rd 15K BTU Ducted A/C
- Dual Pane Windows (frameless)
- Wireless Backup Camera System - Observation & Vision S
- "Off the Grid" Solar Package\*
- Roto Flex Rubberized Pin Box
- 2nd LED Lighted Power Awning (N/A V2913, V3214)
- Slideout Cover Package (double slides)
- Slideout Cover Package (triple slides)
- Party Patio Package (railing only)
- Three Season Patio Door IPO Screen Wall (N/A V2913)
- 7.0KW Gas Onan Generator
- 32" Exterior TV w/Bracket



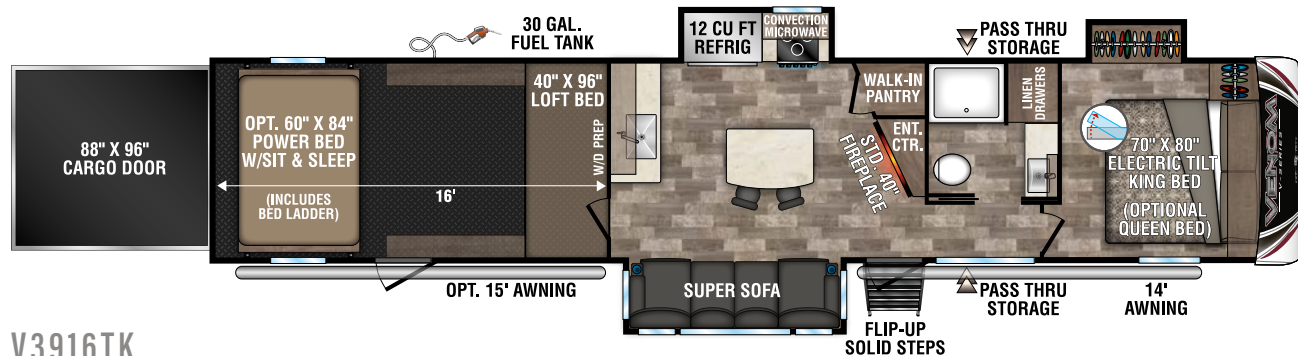
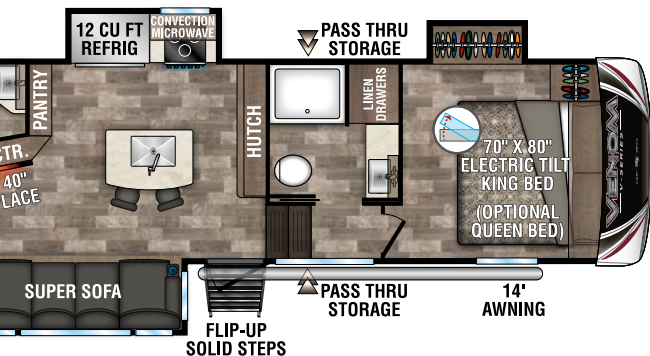
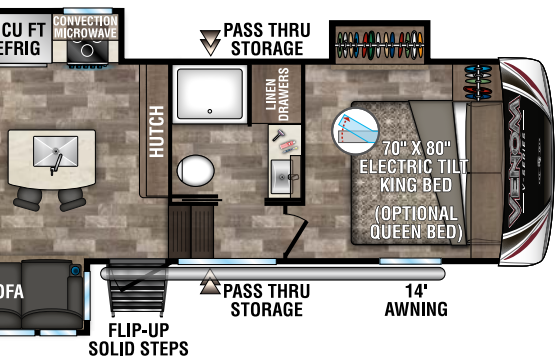

## V3916TK

UVW - 13,340 | Exterior Length - 43' 8" | Sleeps 8

### OPTIONS (INTERIOR)

- 32" Bedroom LED TV
- House Residential Refrigerator w/1200W Inverter IPO 12 CU FT Gas/Electric Refrigerator (N/A CSA option) (N/A V2913, V3214)
- Power Vent Fan in Bathroom
- Power Vent Fan in Garage (N/A 3rd A/C option)
- Queen Pillowtop Mattress 60" x 80" (electric tilt)
- Central Vac System
- Happi-Jac Power Bed w/Roll Over Sofas & Table

\*Cannot get House Residential Refrigerator w/"Off the Grid" Solar Package

### KZ ADVANTAGE PACKAGE (MANDATORY OPTION)

#### EXTERIOR

- 6-Point Electric Auto Leveling
- Polar White Gelcoat Exterior Fiberglass
- Partial Painted Fiberglass Front Cap
- 6-Sided Aluminum Framing
- Zero-G Ramp Door

- Flip-Up Entry Steps (main entry)
- 50 AMP Service
- (2) 15K Ducted A/Cs
- 5/8" Tongue & Groove Plywood Floor
- Key-Alike for Baggage & Entry Doors
- Friction Hinge Entry Door w/Shade Prep
- Screenshot Feature on Entry Door
- X-Large Folding Grab Handle
- Undermount Spare Tire
- Equa-Flex® Suspension
- Nitrogen-Filled Tires
- Battery Disconnect
- Black Tank Flush
- Backup Camera Prep
- Roof Mounted Solar Prep w/Connection
- All Weather Insulation Package (heated, insulated & enclosed underbelly plus foil in floor, roof, front, rear)
- Roof Ladder
- Fully Vented Attic System w/2 Attic Vents
- Toy Lok®
- Generator Prep w/30 GAL Fuel Tank & Pump Station
- Retractable Screen Wall
- Leash Latch w/Bonus Beverage Opener

### INTERIOR

- Maple Glazed Cabinetry
- Glazed Solid Hardwood Slideout Fascia
- Solid Surface Countertops w/Deep Undermount Stainless Steel Kitchen Sink w/Sink Cover
- Trash Can Under Sink
- Drop-In Cooktop w/Glass Cover & Oven
- 30" Convection Microwave
- Kitchen Skylight w/Shade
- Power Vent Fan in Main Area
- Super Sofa (select models)
- (3) Motion Sensor Lights (entry, closet, basement)
- 40" Wideview Fireplace
- LED TV
- Multiple Media Stereo w/DVD/Bluetooth
- 12V Dual USB Charging Station
- Night Roller Shades
- Residential Walk-In Shower
- Porcelain Foot-Flush Toilet
- Stainless Steel Bathroom Sink
- Plywood Bed Base
- Electric Tilt King Bed 70" x 80"

- 12 Gal. Gas/Electric Water Heater
- E-Track Tie-Down System in Cargo Area
- Pocket Door for Bathroom

### KZ CONVENIENCE PACKAGE (MANDATORY OPTION)

#### EXTERIOR

- KZ Engage Powered by OneControl w/5" Screen (Control System monitors tank levels & battery levels, controls slide rooms, leveling system, awnings, inside/outside lighting)
- Power Awning w/LED Light Strip
- 16" Tires w/Aluminum Wheels
- Magnetic Catches for Baggage Doors
- Omnidirectional HDTV Antenna w/Wi-Fi Prep
- LED Lights in Exterior Speakers

#### INTERIOR

- Residential Grade Linoleum
- 12 CU FT Gas/Electric Refrigerator w/Temperature Controls (8 CU FT gas/electric refrigerator in 2913, 3214 only)
- Matte Black Residential Kitchen Faucet w/Spring Sprayer

- Surfex Wood Step in FW Hallway
- Wood Accent Trim on Corners/Entry Doors
- (2) Bar Stools (island models)
- Vision S Prep (blind spot monitoring)

### BONUS FEATURES

- 2-year Limited Warranty (see flyer)
- One of the lightest weight high-profile, wide-body, luxury Toy Hauler fifth wheels in the industry
- KZ RV has won the coveted DSI award 19 years.
- KZ RV's 48 years of building experience, coupled with its stable and dedicated Amish workforce and commitment to superb quality, and low overhead, allows us to produce the lowest-priced fully-featured fifth wheel available.



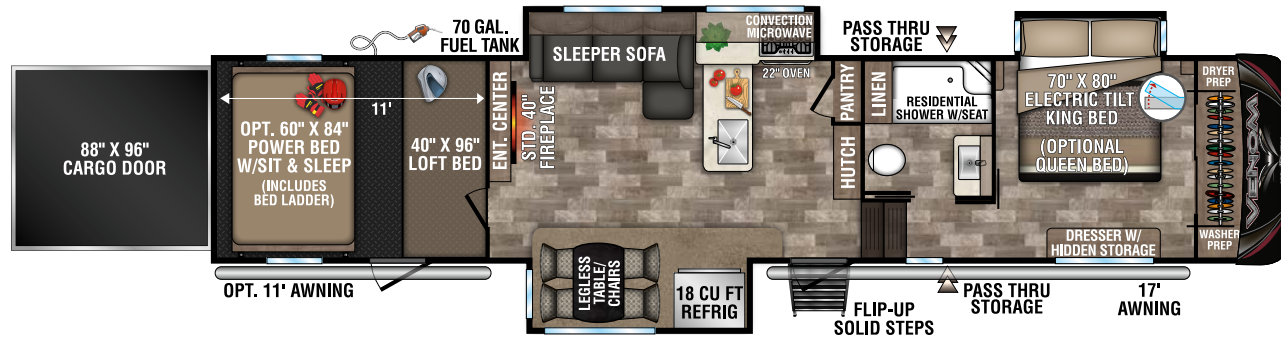

**3911TK**  
 UVW - 15,010  
 Exterior Length - 42' 8"  
 Sleeps 9

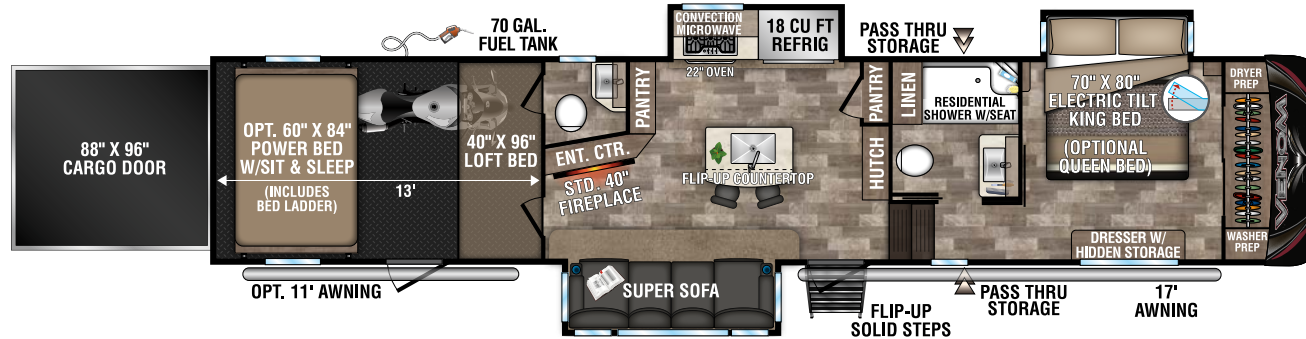
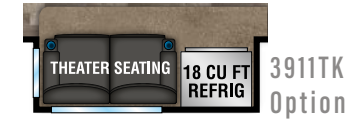

**4013TK**  
 UVW - 15,120  
 Exterior Length - 43' 6"  
 Sleeps 8

**CONSTRUCTION FEATURES**

- 101" Wide-Body Construction
- 6-Sided aluminum frame, including welded aluminum fore & aft floor joists, sidewall framing, & roof trusses
- Extra Reinforced Heavy-Duty Front Fiberglass Cap
- Radius Aerodynamic Front Cap
- 2" x 3" Fully-Welded Aluminum Floor Framing
- 2" x 2" Fully-Welded Aluminum Sidewall Framing
- 5" Welded Aluminum Roof Trusses
- Lippert® Hydraulic Slide System w/Selector Valves
- 12" Powder-Coated Steel I-Beam w/Drop Frame (160 SQ FT pass-thru storage)
- Lamilux 4,000° High-Gloss Fiberglass Sidewalls
- All Weather Insulation Package to R38 (roof, floor, garage floor end caps, holding tanks)
- Double Insulated & Heated Holding Tanks (R38 above & below tanks)

- Additional Outside Frame-to-Wall Floor Insulation
- R11 2" Sidewalls (w/EGS metal backing strips)
- One-Piece ABS Slideroom Bottoms
- 1-Piece, Seamless, Walk-on, Tufflex Roofing Material w/15-Year Warranty
- 45-Degree Radius Aluminum Roof Edge
- Fully Vented Attic System
- 3/8" Fully Walk-On Roof Decking
- 5/8" Tongue & Groove Screwed & Glued Plywood Floor Decking
- Pex® In-Floor Heated Waterlines & Kitchen Gray Pipes (all waterlines & drains located above all insulation)
- Fully-Enclosed & Heated Underbelly w/Direct-Heated Holding Tanks

**EXTERIOR FEATURES**

- 7,000 LB Dexter® Axles w/Self Adjusting Brakes & Height Adjusting Hangers
- 8-Lug Heavy-Duty Aluminum Rims

- w/16" G-Range Radial Tires
- 100% Exterior LED Running & Taillights
- Propane Bottles (2 x 30 LBS) on Same Side for Easy Access
- Sealed Battery Storage Compartment (no battery boxes required)
- Triple Front Slam-Latch Baggage Doors
- Side Slam-Latch Baggage Doors w/Dual Locks
- Fully Painted Front Cap w/LED Accent Lights
- Frameless Windows
- 35,000 BTU Furnace w/3" x 14" In-Floor Straight Line Heating System
- 12 GAL Gas/Electric Hot Water Heater
- Ramp Door w/LED Lighting
- LED Docking & Sewer Hookup Lights
- Sewer Hose Storage Tube
- Dual Swing-Away Assist Grab Handle
- Under-Frame Spare Tire w/Hoist

- Roof Ladder
- Heated Water Convenience Center (incl. black tank flush, power fresh tank water fill, winterizing system, outside shower, & dry-camping water siphon)
- Fully-Finished Heated & Sealed Basement Storage Compartment
- Camp Table & Patio Chairs Storage Compartment
- Heated & Enclosed Dump Valves
- Satellite Pre-Wire in Convenience Center & Roof
- LP Quick Connect

**KITCHEN FEATURES**

- Large Dining Table w/Removable Leaf & 2 Heavy-Duty Chairs (2 additional folding chairs 3911TK, 4114TK)
- Power Vent Kitchen Fan w/Wall Controls
- XL Residential Size Pullout Trashcan (where applicable)
- Removable Silverware Tray
- Under-Sink Storage Shelf
- OH Cabinets incl. Shelf & Extra-

- Tall Slide Lips
- Hidden Cabinet Door Hinges
- 5" Stainless Steel Cabinet Hardware
- Baltic Birch Drawer Boxes
- Heavy-Duty 100 LB Drawer Glides
- LED Kitchen Cabinet Toe-Kicks (where applicable)
- Kitchen Window (most models)

**INTERIOR FEATURES**

- 22 OZ Residential Carpet w/3/8" Re-bond Padding
- XL Ceiling Crown Molding
- 100% LED Ceiling & Cabinet Lights w/Multiple On/Off Switches
- Extra-Large Light Switches
- Removable Pedestal Tables in Front of Seating (based on model)

**BEDROOM FEATURES**

- XL Deep Closet w/Shoe Storage Rack (3911TK, 4013TK)
- Dual Washer/Dryer Prep (stacked or side-by-side)
- XL Under-Bed Storage
- Luxurious Bedsread & Pillow Shams
- Flat Panel TV on Swing Arm

**BATH FEATURES**

- Residential One-Piece Fiberglass Shower Stall w/Glass Doors & Built-In Seat
- Shower Skylight
- XL Solid Surface Bath Vanity w/ Stainless Steel Sink
- Porcelain Foot-Flush Toilet
- XL Linen Cabinet
- XL Deep Closet w/Shoe Storage Rack (3911TK & 4013TK)
- Extra-Wide Hallway & Pocket Door
- Power Vent w/Wall Switch
- Towel Bar & Towel Ring

**GARAGE FEATURES**

- Roll-Down Screen Wall
- E-Track Tie-Down System
- Built-In Dovetail
- 24" Diamond Plate Wall Guards
- Garage Entry Door
- HD Flat Panel Garage TV on Swing Arm
- (2) Garage Ceiling Speakers
- Zero Gravity Ramp Door w/Easy-Lift Assist

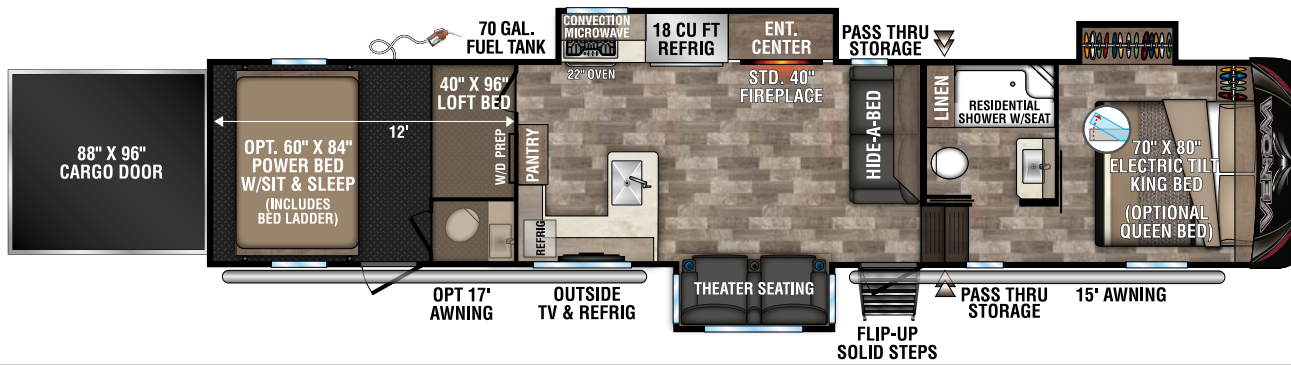

**4012TK**

UVV - 15,020  
Exterior Length - 43' 7"  
Sleeps 9

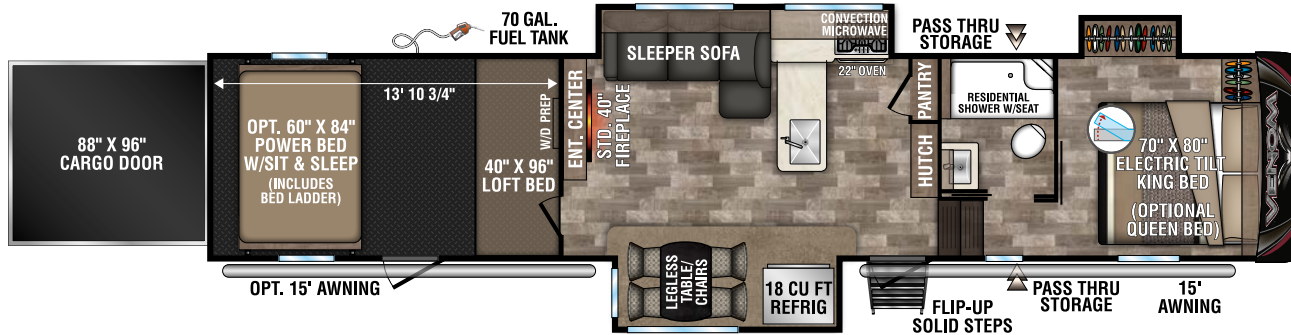
**4114TK**

UVV - 14,710  
Exterior Length - 43' 5"  
Sleeps 9

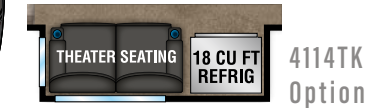
**OPTIONS (EXTERIOR)**

- Dual Pane Windows (frameless)
- Wireless Backup Camera - Observation & Vision S
- "Off the Grid" Solar Package\*
- Flex-Air Pin Box
- 2nd LED Lighted Power Awning
- Slideout Cover Package (triple slides)
- Ramp Door Patio Package w/Step & Awning
- Three Season Patio Door IPO Screen Wall
- 7.0KW Gas Onan Generator
- 32" Exterior TV w/ bracket

**OPTIONS (INTERIOR)**

- House Residential Refrigerator w/1200W Inverter IPO 18 CU FT Gas/Electric Refrigerator (N/A CSA option)
- Power Vent Fan in Bathroom
- Power Vent Fan in 1/2 Bath (4013TK)
- Queen Pillowtop Mattress 60" x 80" (Elec. Tilt)
- Happi-Jac Power Bed w/Roll Over Sofas & Table

- Theater Seating w/Heat & Massage Features IPO Table w/ Chairs (3911, 4114)
- \*Cannot get Residential Refrigerator w/"Off the Grid" Solar Package

**KZ ADVANTAGE PACKAGE (MANDATORY OPTION)****EXTERIOR**

- 6-Point Hydraulic Auto Leveling
- Polar White High Gloss Gelcoat Exterior Fiberglass
- Painted Fiberglass Front Cap
- 6-Sided Aluminum Framing
- Flip-Up Entry Steps (main entry)
- 50 AMP Service
- (3) 15K Ducted A/Cs
- 5/8" Tongue & Groove Plywood Floor
- Key-Alike for Baggage & Entry Doors
- Friction Hinge Entry Door w/ Shade Prep & Screenshot Features
- X-Large Folding Grab Handle
- Undermount Spare Tire
- Trail-Air Rota Flex Pin Box

- Equa-Flex® Suspension
- Nitrogen-Filled Tires
- Battery Disconnect
- Black Tank Flush
- Backup Camera Prep
- Roof Mounted Solar Prep w/ Connection
- All Weather Insulation Package (heated, insulated & enclosed underbelly plus foil in floor, roof, front, rear)
- Roof Ladder
- Fully Vented Attic System w/ 2 Attic Vents
- Toy Lok®
- Generator Prep w/Dedicated 30 GAL Fuel Tank Plus 40 GAL Fuel Tank & Pump Station
- Retractable Screen Wall
- Pocket Door for Bathroom & Bedroom
- Leash Latch w/Bonus Beverage Opener

**INTERIOR**

- Maple Glazed Cabinetry
- Glazed Solid Hardwood Slideout

- Fascia
- Solid Surface Countertops w/ Deep Undermount Stainless Steel Kitchen Sink w/Sink Cover
- Chef's Appliance Package (2-piece Stainless Steel gas cooktop w/built-in oven & 30" convection microwave)
- Central Vac System w/ Attachments
- Power Vent Fan in Main Area
- Super Sofa (select models)
- (3) Motion Sensor Lights (entry, closet, basement)
- 40" Wideview Fireplace
- LED TV
- Multiple Media Stereo w/DVD/Bluetooth
- JBL Performance Package (6 JBL speakers & sub-woofer)
- 12V Dual USB Charging Station
- Dual Day/Night Roller Shades
- Porcelain Foot-Flush Toilet
- Stainless Steel Bathroom Sink w/ Waterfall Faucet
- Plywood Bed Base
- Electric Tilt King Bed 70" x 80"

- 32" Bedroom LED TV
- 12 GAL Gas/Electric Water Heater
- 40" LED TV in Garage Area
- Pocket Door for Bathroom & Bedroom

**KZ CONVENIENCE PACKAGE (MANDATORY OPTION)****EXTERIOR**

- KZ Engage Powered by OneControl w/7" Screen (control system monitors tank levels & battery levels, controls sliderooms, leveling system, awnings, dimmable interior lighting, HVAC controls: includes Wi-Fi prep & Connect Anywhere Prep for full function access by mobile device)
- Power Awning w/LED Light Strip
- 16" G-Range Tires w/Aluminum Wheels
- Magnetic Catches for Baggage Doors
- Omnidirectional HDTV Antenna w/Wi-Fi Prep
- LED Lights in Exterior Speakers

**INTERIOR**

- Residential Grade Linoleum
- 18 CU FT Gas/Electric Refrigerator w/Temperature Controls
- Matte Black Residential Kitchen Faucet w/Spring Sprayer
- Surfex Wood Step in FW Hallway
- Wood Trim on Corners/Entry Doors
- Vision S Prep (blind spot monitoring)

**BONUS FEATURES**

- 2-Year Limited Warranty (see flyer)
- One of the Lightest, High-Profile, Wide-Body, Luxury Toy Hauler Fifth Wheels in the Industry
- KZ has received the Dealer Satisfaction Index Award for 19 years
- KZ's 48 years of stable, dedicated manufacturing experience, coupled with its predominantly Amish workforce, heritage and commitment to superb quality, allow us to produce the lowest-priced luxury fifth wheel available.



VENOM V-SERIES

VENOM

Fifth Wheel Toy Haulers	V3214DK	V3411TK	V3413TK	V3815TK	V3916TK	3911TK	4012TK	4013TK	4114TK
UVW (Unloaded Vehicle Weight)*	10,230	12,410	12,430	13,470	13,340	15,010	15,020	15,120	14,710
Dry Hitch Weight*	2,610	2,340	2,270	2,690	2,730	3,000	2,740	2,990	3,230
Dry Axle Weight*	7,620	10,070	10,160	10,780	10,610	12,010	12,280	12,130	11,480
NCC (Net Carrying Capacity)	4,765	3,590	3,570	4,530	4,660	3,990	3,980	3,880	4,290
GVWR	14,995	16,000	16,000	18,000	18,000	19,000	19,000	19,000	19,000
Interior Height	102"	102"	102"	102"	102"	102"	102"	102"	102"
Exterior Height w/ A/C	13' 4"	13' 4"	13' 4"	13' 4"	13' 4"	13' 4"	13' 4"	13' 4"	13' 4"
Exterior Width	101"	101"	101"	101"	101"	101"	101"	101"	101"
Exterior Length**	35' 0"	38' 10"	40' 11"	42' 10"	43' 8"	42' 8"	43' 7"	43' 6"	43' 5"
Refrigerator (cu. feet)	8	12	12	12	12	18	18	18	18
Water Heater Cap. (gal. G/E w/DSI)	12	12	12	12	12	12	12	12	12
Fresh Water Cap. (gal.) [Including Water Heater Capacity]	112	112	112	112	112	112	112	112	112
Waste Water Cap. (gal.)	53	93	53	93	53	53	53	73	53
Gray Water Cap. (gal.)	53	53	93	53	93	93	93	93	93
1/2 Bath Cap. (gal.)	N/A	40	N/A	40	N/A	N/A	40	N/A	N/A
LP Gas Cap. (lbs.)	60	60	60	60	60	60	60	60	60
Furnace BTUs (1,000s)	35	35	35	35	35	35	35	35	35
Tire Size	16"	16"	16"	16"	16"	16"	16"	16"	16"
Awning	20'	14'	14'	14'	14'	17'	15'	16'	14'
Optional 2nd Awning	N/A	10' 6"	12'	14'	15'	11'	17'	11'	15'

\*This weight reflects the rolling average unit weight for each model. Your trailer weight will vary according to optional equipment.  
 \*\*Exterior length is measured from center of hitch pin to rear wall.

INTERIOR FEATURES



**SOLID SURFACE COUNTERTOPS** and deep-seated, under-mount stainless steel sink with spring sprayer faucet.



**2-PIECE STAINLESS STEEL GAS COOKTOP** with built-in oven and 30-inch convection microwave. (standard on Venom)



**YOU'LL FIND STORAGE GALORE** in every floorplan, allowing your family to truly take it all with you!



**18 CU FT GAS/ELECTRIC REFRIGERATOR** with four doors and temperature controls (standard on Venom)





**QUICKLY TRANSFORM** the garage from hauling your toys into a lounge area and a roomy bedroom, with optional 60 x 84-inch sit-and-sleep power bed. Add options like ramp door patio rails, three season patio door. (4013TK shown)



# GARAGE FEATURES



**E-TRACK** universal track system with different fittings that allow you to quickly snap in and secure your load.



**KZ ENGAGE** powered by OneControl with a 7-inch screen (5" Venom V-Series) mounted on an interior wall right by the entrance door (app can be downloaded to a smart phone or tablet). The control system monitors tank and battery levels, controls sliderooms, leveling system, awnings, and dimmable interior lighting. (Venom only: additionally controls HVAC: includes Wi-Fi prep and Connect Anywhere prep for full function access by mobile device).

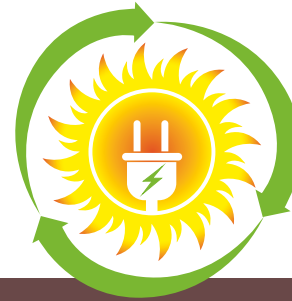

Harness the power of the sun to run your TV and outlets. Roof mounted solar prep standard. **Optional "Off the Grid" solar package** includes 190W panel, 1200W inverter and interior control center.



Two attic vents are in each RV, providing vital escape routes for unwanted moisture that accumulates during use.



Heated, insulated & enclosed underbelly plus foil in floor, roof, front, rear! R-11 sidewalls, R-38 roof and floor.



**FLEXIBLE**



**PUNCTURE RESISTANCE**



**REFLECTIVE**

**TUFFLEX ROOFING** by Dicor Products 15-YEAR WARRANTY!



# VENOM V-SERIES & VENOM EXTERIOR FEATURES



**STANDARD FLIP-UP ENTRY STEP** with grab handle to provide solid footing. Steps flip up in one easy motion. Handy friction door hinge and screenshot auto-door-close features make usage a breeze.



**WATER COMMAND CENTER**  
convenient, well-lit centralized spot



**160 CUBIC FOOT FULLY-FINISHED PASS-THROUGH COMPARTMENT**  
rugged diamond-plate-textured flooring and dual-lock slam-latch doors.



**HEATING & COOLING** Standard 3 x 14-inch foam-core in-floor straight-line heating system with 35K BTU furnace and three 15K BTU ducted roof A/Cs w/ Whisper Quiet cooling system. *(Venom only)*

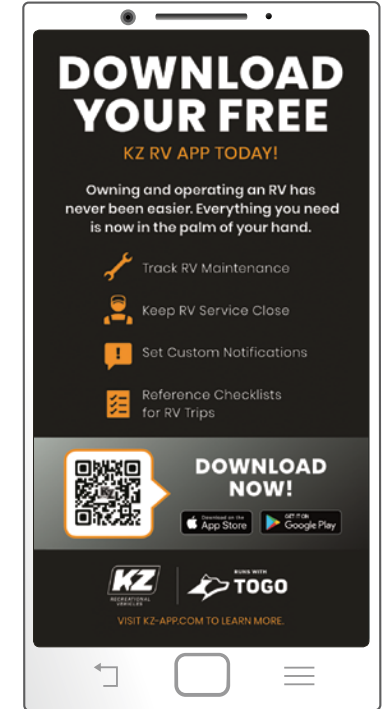

**STANDARD 6-POINT HYDRAULIC AUTO-LEVELING SYSTEM**  
does all the work. *(Venom only)*



**ZERO GRAVITY RAMP DOOR**

ACCESS YOUR TOYS WITH THE LIFT OF A FINGER. NO MORE HASSLE OF LIFTING THE HEAVY BULKY DOOR.

includes electric locks



**PUMP STATION** *(Venom only, shown)* allows easy access to the 40-gallon tank. **GENERATOR PREP** includes a dedicated 30-gallon tank.

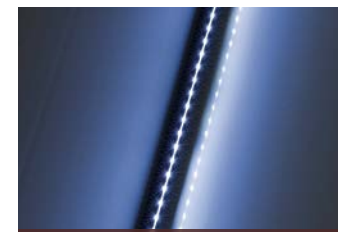

**STANDARD POWER AWNING WITH LED LIGHT STRIP** creates the perfect outdoor gathering space for friends and family.



# LUXURY FIFTH WHEEL TOY HAULERS

CONSTRUCTION

VENOM

- 1** R-11 LAMINATED SIDEWALLS  
aluminum framed with high density solid block insulation
- 2** ALL WEATHER INSULATION PACKAGE  
heated, insulated and enclosed underbelly plus foil in floor/roof/front/rear. (dedicated heat duct in the underbelly)
- 3** R-38 INSULATED FLOOR AND UNDERBELLY
- 4** R-38 INSULATED ROOF
- 5** R-38 INSULATED FRONT AND REAR WALLS
- 6** 5/8" TONGUE AND GROOVE PLYWOOD some of our competitors use OSB board
- 7** 1" THICK BAGGAGE DOORS  
some of our competitors have 1/2" baggage doors
- 8** FULLY VENTED ATTIC SYSTEM  
w/ 2 attic vents
- 9** 101" WIDE BODY
- 10** OFF-THE-GRID SOLAR PACKAGE (optional) includes 190W panel, 1200W inverter and interior control center







# RECREATIONAL VEHICLES

## HANDCRAFTED TO HIGH STANDARDS

In 1972, Sam King and Daryl Zook built a truck camper—and built a better way to camp. Since then we’ve built recreational vehicles with a focus on craftsmanship and quality, so you can spend more time adventuring and less time worrying.

When you hitch to a KZ Recreational Vehicle, you can expect adventure, good times, and old-world values. We care about your camping experience. Because your KZ is where the journey starts.

**Go. Camp. Live.**

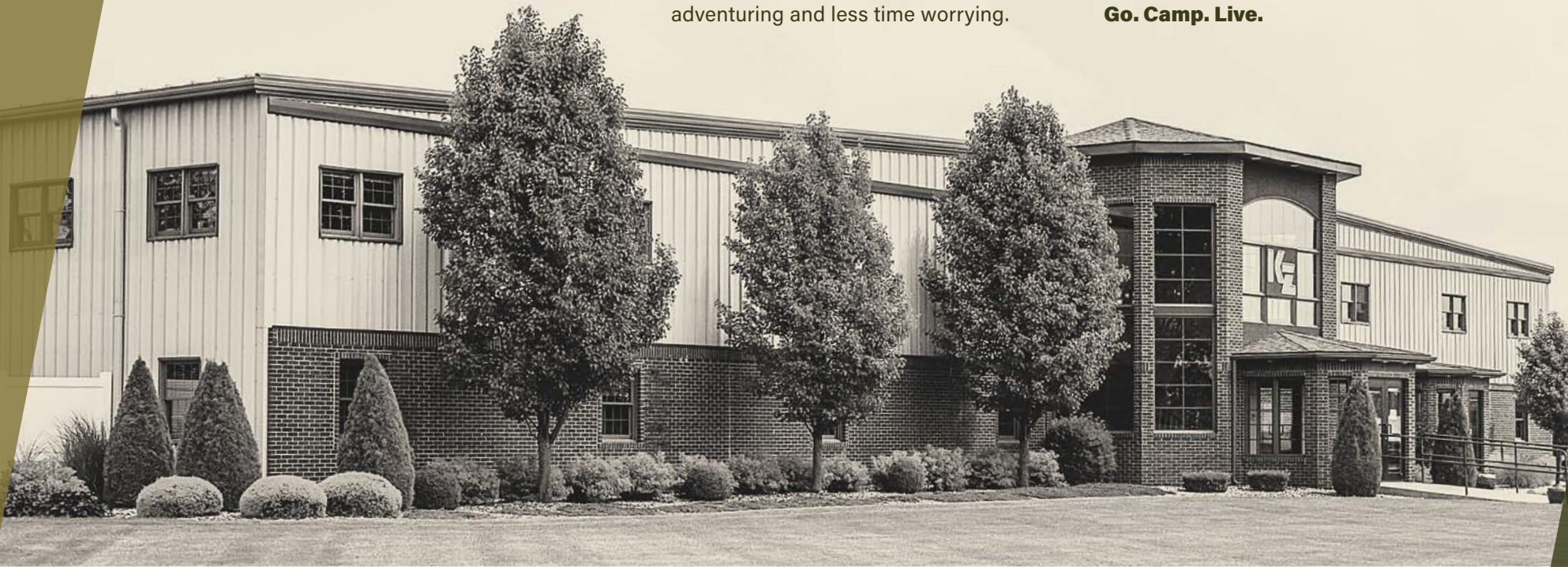

The KZ **True 2 Warranty** is a **2-year hitch-to-bumper limited warranty** that’s true to its name. The gold standard in RV protection, True 2 provides double the coverage of the industry norm. Plus, our warranty is backed by the craftsmanship and quality we’re known for, so you can Go. Camp. Live. Wherever your adventure takes you, know that you’re covered in your KZ.



Portions of this brochure were used with the expressed authority of Dexter Axle, but Dexter Axle is not responsible for the accuracy of the information contained herein.

Dealer:

