

CONNECT

LIGHTWEIGHT TRAVEL TRAILERS





C211BH | Boulder décor

CONNECT LITE

Connect Lite ultra-lightweight travel trailers offer your family the amenities they're used to, yet don't skimp on stylish good looks or construction. We use 5/8-inch tongue and groove plywood, seamless countertops with under-mount kitchen sink and sink covers, a 6.3 cubic foot refrigerator with temperature controls, and Congoleum® linoleum with a three-year warranty against cold-cracking.



C211BH | Boulder décor

Connect is packed with storage areas, including under-bed, wardrobe and overhead cabinets. Bedrooms include our under-bed storage system, accessed by lifting up on the plywood bed base with gas struts.



C211BH | Boulder décor

CONNECT

Connect offers gourmet kitchen layouts and flexible sleeping options without giving up living space. Features include seamless countertops with under-mount kitchen sink and covers, blue LED light strip above the main living room slideout, jackknife sofa with middle console and sofa arms, and 12-volt USB ports in the bunk area.

C281BH | Boulder décor



C241RLK | Boulder décor

Convertible dinettes are comfortable and spacious, and include under-seat doors with 36-inch pullout storage bins. Large sliding windows offer excellent cross-ventilation.

Multi-media stereo that includes a DVD/Bluetooth with NFC wireless connectivity.



The under-bed storage system is comprised of two baskets on each side, along with under-bed storage, accessed by lifting the 60" x 80" queen bed's plywood base with gas struts.



This 241RLK is shown with the optional and convenient tri-fold sofa/bed. Bath area in the new 241RLK includes a radius shower.



C241RLK | Boulder décor

CONNECT LITE

ultra lightweight travel trailers



Standards

- 3/8" Fully Walk-On Roof Decking
- 1-Piece Seamless Roof w/Super Flex® Roofing Material
- Diamond Plate Front Rock Guard
- Tinted Safety Glass Windows
- Double Step
- Radius Baggage Doors w/ Magnetic Catches
- LED Light in Pass-Thru Storage
- LED Exterior Lighting
- (4) Stabilizer Jacks
- (2) 20# LP Bottles w/Bottle Cover
- Bumper w/Sewer Hose Storage
- Black Tank Flush
- Exterior Shower
- Satellite & Cable Hookups
- 3-Burner Range w/Oven
- Microwave
- Solid Wood Mortise & Tenon Cabinet Doors
- Glazed Amish-Crafted Cabinet Doors
- Roller Ball Bearing Drawer Glides
- Residential Crack-Resistant Congoleum® Linoleum
- LED Interior Lighting
- Monitor Panel
- Hard Valances
- Nightshades
- Skylight in Kitchen & Bathroom
- Power Vent in Bathroom
- Mattress w/Reversible Down Comforter

K-Z Advantage Package (mandatory option)

- UVA & UVB Resistant Gelcoat Lamilux® Exterior F/G
- New Aqualon Edge® Material w/7-Year Limited Warranty (C191RBT)
- Power Awning w/LED Light Strip
- 5/8" Tongue & Groove Plywood Floor
- Friction Hinge Entry Door
- Large Folding Grab Handle
- Amber Step Light
- Key-Alike® Program for Baggage & Entry Doors
- Equa-Flex® Suspension
- Power Front Jack w/LED Light
- Nitrogen-Filled Tires
- Spare Tire w/Carrier
- 6 GAL LP/Electric DSI Water Heater
- Exterior Speakers
- Battery Disconnect
- Solar Prep
- Backup Camera Prep
- 6.3 CU FT Refrigerator w/Temperature Controls
- Seamless Countertops w/Under-Mount Kitchen Sink
- Jackknife Sofa w/Middle Console & Sofa Arms
- Multi-Media Stereo w/DVD, Bluetooth & NFC Wireless Connectivity
- 12V Dual USB Port
- (2) 6.5" Interior Speakers
- Blue LED Light Strip above Main Living Room Slide
- (2) LED Motion Sensor Lights
- Foot-Flush Toilet
- Bed Storage System
- Plywood Bed Base w/Gas Struts

Options

- Aluminum Wheels
- 15,000 BTU A/C (IPO 13,500 BTU A/C)
- Bumper-Mount Grill
- Climate Package (electronically-controlled heated holding tanks)
- Wireless Backup Camera System
- 39" LED TV (C211RBK)
- 24" LED TV (C190RB, C191RBT, C201RB, C211BH, C221RD, C231RL)
- Bedroom LED TV w/Inside/Outside Bracket
- Murphy Bed w/Sofa (N/A – C191RBT, C221RD, C231RL)
- Pillowtop Mattress

Premium Package

- F/G Front Cap
- Pillowtop Mattress
- Headboard
- Porcelain Foot-Flush Toilet



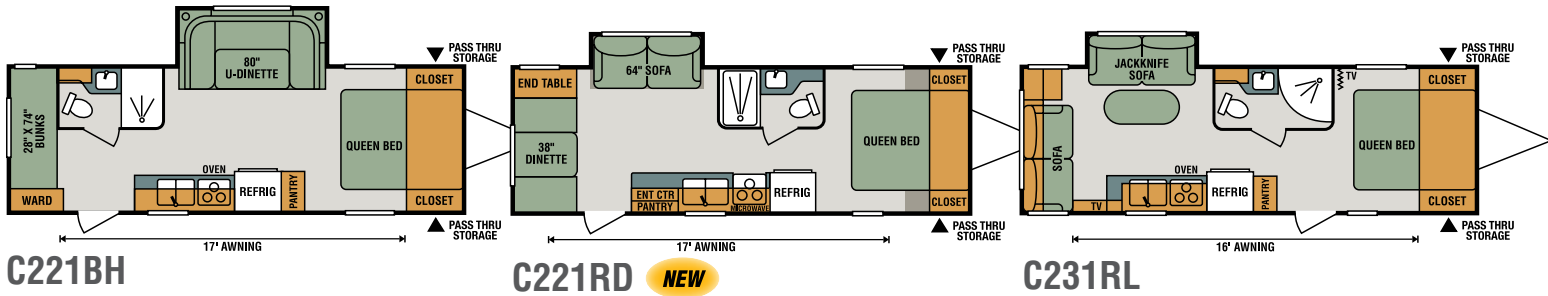
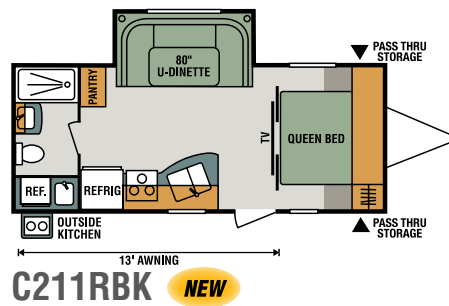
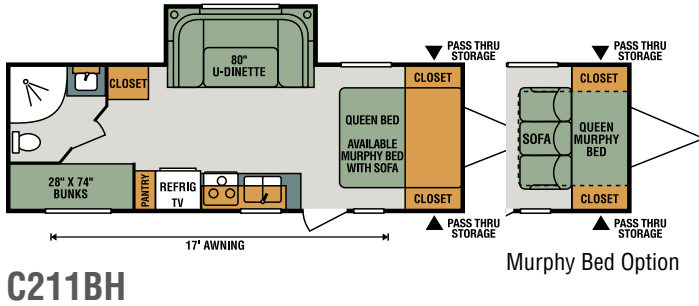
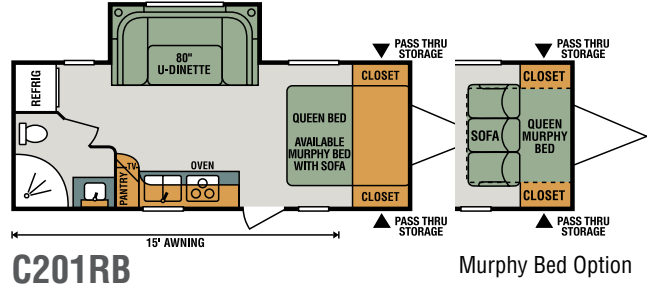
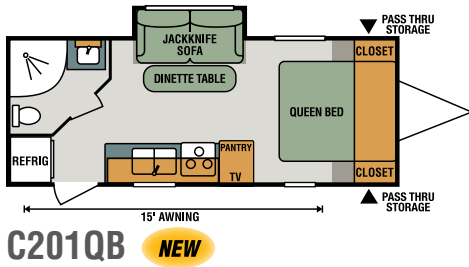
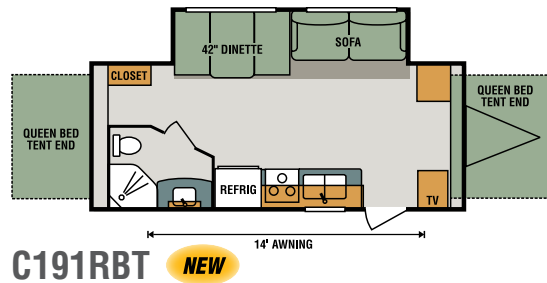
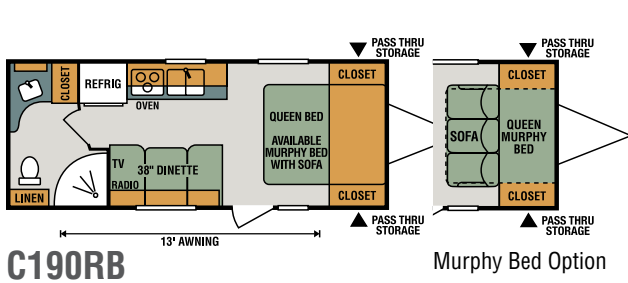

Ultra Lightweight Travel Trailers	C190RB	C191RBT	C201QB	C201RB	C211BH	C211RBK	C221BH	C221RD	C231RL
UVW (Unloaded Vehicle Weight)*	3,650	4,790	TBD	4,010	4,530	4,700	4,450	4,380	4,440
Dry Hitch Weight*	350	670	TBD	350	560	490	520	510	470
Dry Axle Weight*	3,300	4,120	TBD	3,660	3,970	4,210	3,930	3,870	3,970
NCC (Net Carrying Capacity)	1,550	1,210	TBD	1,190	1,070	1,300	1,150	1,220	1,160
GVWR	5,200	5,600	TBD	5,200	5,600	5,600	5,600	5,600	5,600
Interior Height	78"	78"	TBD	78"	78"	78"	78"	78"	78"
Exterior Height w/ A/C	119"	119"	TBD	119"	119"	119"	119"	119"	119"
Exterior Width	90"	90"	TBD	90"	90"	90"	90"	90"	90"
Exterior Length	23' 1"	23' 7"	TBD	23' 10"	26' 9"	24' 9"	26' 11"	26' 11"	26' 11"
Refrigerator (cu. feet)	6	6	TBD	6	6	6	6	6	6
Water Heater Cap. (gal. G/E w/DSI)	6	6	TBD	6	6	6	6	6	6
Fresh Water Cap. (gal.)	40	40	TBD	40	40	40	40	40	40
Waste Water Cap. (gal.)	30	32	TBD	24	24	32	24	30	24
Gray Water Cap. (gal.)	30	32	TBD	30	30	32	30	30	30
LP Gas Cap. (lbs.)	40	40	TBD	40	40	40	40	40	40
Furnace BTUs (1,000s)	20	20	TBD	20	20	20	20	20	20
Tire Size	14"	14"	TBD	14"	14"	14"	14"	14"	14"
Awning	13'	14'	15'	15'	17'	13'	17'	17'	16'

*This weight reflects the rolling average unit weight for each model. Your trailer weight will vary according to optional equipment.

CONNECT

lightweight travel trailers



Standards

- 3/8" Fully Walk-On Roof Decking
- 1-Piece Seamless Roof w/SuperFlex® Roofing Material
- UVA & UVB Resistant Gelcoat Lamilux® Exterior F/G
- Protective Front Diamond Plate
- Extra-Large Baggage Doors w/Magnetic Catches
- K-Z Easy-Catch Baggage Door Systems
- LED Exterior Lighting
- Outside Entertainment Prep (EXT 110V & cable outlets)
- Outside Shower
- (4) Stabilizer Jacks
- (2) 20# LP Bottles w/Bottle Cover
- Satellite & Cable Hookups
- 30 AMP Service
- 13,500 BTU A/C
- Water Heater Bypass
- Black Flush Tank
- Digital TV Antenna w/Booster
- 3-Burner Range w/Oven
- High-Rise Faucet
- Rich Woodbridge Maple Cabinetry
- Hand-Crafted Mortise & Tenon Glazed Cabinet Doors
- Roller Ball Bearing Drawer Glides
- Residential Crack-Resistant Congoleum® Linoleum
- LED Interior Lighting
- Nightshades
- Tub Surround
- Skylight over Tub
- Roof Vent in Bath
- High Thread Count Quilted Reversible Queen Bedspread
- Gas Struts on Bed Base

K-Z Advantage Package (mandatory option)

- Power Awning w/LED Light Strip
- 5/8" Tongue & Groove Plywood Floor
- Key-Alike® Program for Baggage & Entry Doors

- Climate Package (insulated, heated & enclosed underbelly)
- Friction Hinge Entry Door
- Large Folding Grab Handle
- Alumitread® Entry Steps
- Amber Step Light
- Power Front Jack w/Led Light
- Equa-Flex® Suspension
- Nitrogen-Filled Tires
- Spare Tire w/Carrier
- Exterior Speakers
- 6 GAL LP/Electric DSI Water Heater
- Solar Prep
- Backup Camera Prep
- Battery Disconnect
- ToyLok®
- Drop-In Cooktop w/Glass Cover
- 6.3 CU FT Refrigerator w/Temperature Controls
- Seamless Countertops w/Under-Mount Kitchen Sink & Sink Covers
- Dinette Doors w/36" Pullout Storage Bins
- Flip-Down 71" Storage Rack
- Jackknife Sofa w/Middle Console & Sofa Arms
- Push-Back Recliners (rear living models)
- Blue LED Light Strip above Main Living Room Slide
- Multi-Media Stereo w/DVD, Bluetooth & NFC Wireless Connectivity
- (2) 6.5" Interior Speakers
- 12V USB Ports in Bunk Area
- 12V Dual USB Port
- (2) LED Motion Sensor Lights
- Kitchen Skylight
- Foot-Flush Toilet
- 60" x 80" Queen Mattress
- Bed Storage System
- Plywood Bed Base w/Gas Struts

Options

- Radiant Technology Package (foil in floor, roof, front & rear)
- Roof Ladder
- Front & Rear Electric Stabilizer Jacks
- Aluminum Rims

- Bumper-Mount Grill
- Wireless Backup Camera System
- 50 AMP Service for 2nd A/C
- 15,000 A/C (IPO 13,500 BTU A/C)
- 2nd 13,500 BTU A/C
- Free-Standing Dinette Table & (4) Chairs (IPO dinette – N/A C221RK, C222IK, C231BH, C241BHK, C251RK)
- Tri-Fold Hide-a-Bed Sofa (IPO Jackknife) (N/A C221RK, C251RK)
- Trundle Bed (IPO dinette in bunk slide – C312BHK, C323BHK)
- Theater Seating (IPO Jackknife – C241RLK, C261RB, C261RL)
- 39" LED TV (N/A – C221RK, C231BH)
- 32" LED TV (C221RK, C231BH)
- Bedroom LED TV w/Inside/Outside Bracket
- MaxAir® Vent Fan (bathroom only)
- Pillowtop Mattress

Platinum Package

- F/G Front Cap
- Porcelain Toilet w/Foot Flush
- Pillowtop Mattress
- Headboard



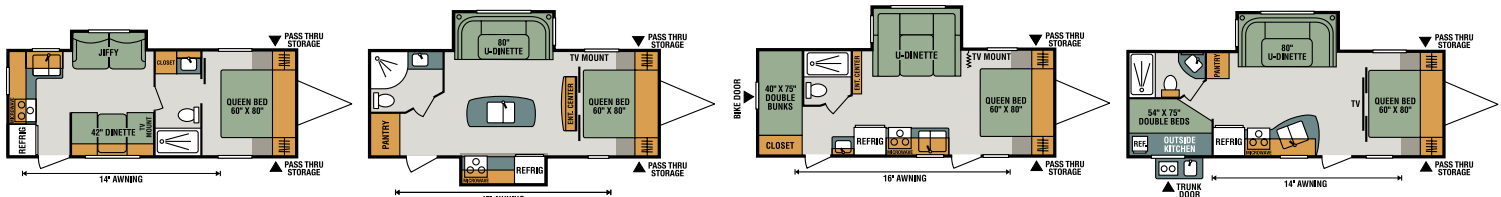

C221RK

C222IK

C231BH

C241BHK

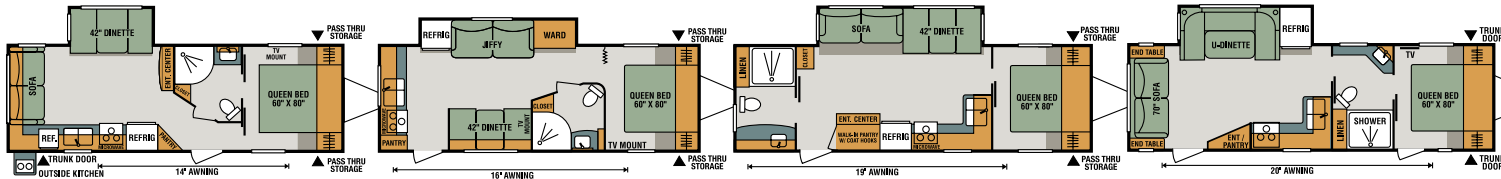

C241RLK **NEW**

C251RK

C261RB **NEW**

C261RL **NEW**

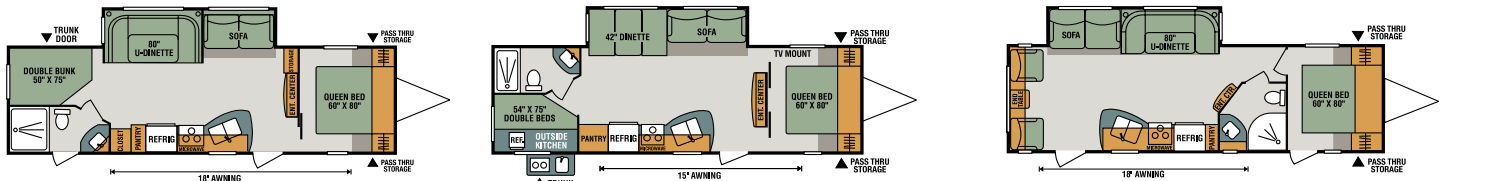

C281BH **NEW**

C281BHK

C281RL

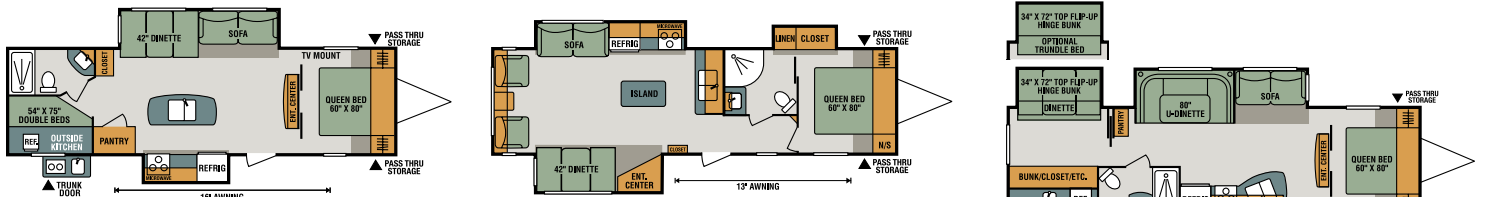

C292BHK

C303RL **NEW**

C312BHK

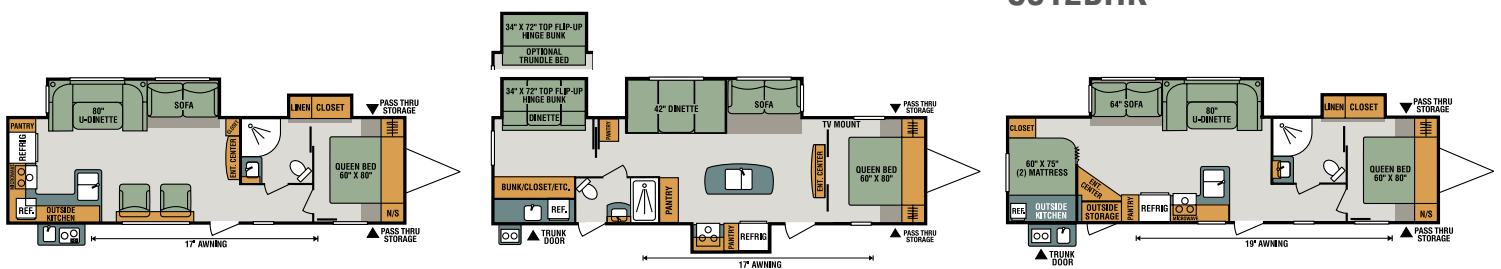

C312RKK

C323BHK

C332BHK

Lightweight Travel Trailers	C221RK	C222IK	C231BH	C241BHK	C241RLK	C251RK	C261RB	C261RL	C281BH	C281BHK	C281RL	C292BHK	C303RL	C312BHK	C312RKK	C323BHK	C332BHK
UVW (Unloaded Vehicle Weight)*	4,490	5,440	4,790	5,120	5,310	5,180	5,730	5,780	6,170	5,680	6,150	6,540	7,290	6,910	6,770	7,450	7,200
Dry Hitch Weight*	510	670	540	690	260	490	650	600	730	750	660	800	780	730	700	850	950
Dry Axle Weight*	3,980	4,770	4,250	4,430	4,750	4,690	5,080	5,180	5,440	4,930	5,490	5,740	6,510	6,180	6,070	6,600	6,250
NCC (Net Carrying Capacity)	1,510	1,060	1,210	1,680	1,190	1,620	1,070	1,020	1,830	1,120	1,850	1,460	1,010	1,390	1,530	1,350	1,600
GVWR	6,000	6,000	6,000	6,800	6,500	6,800	6,800	6,800	8,000	6,800	8,000	8,000	8,300	8,300	8,300	8,300	8,800
Interior Height	78"	78"	78"	78"	78"	78"	78"	78"	78"	78"	78"	78"	78"	78"	78"	78"	78"
Exterior Height w/ A/C	10' 3"	11' 2"	10' 4"	10' 7"	10' 8"	10' 8 1/2"	10' 8"	10' 8"	10' 8"	10' 9"	11' 1"	11' 1"	10' 8"	10' 11"	11' 2"	11' 3"	10' 11"
Exterior Width	96"	96"	96"	96"	96"	96"	96"	96"	96"	96"	96"	96"	96"	96"	96"	96"	96"
Exterior Length	26' 8"	26' 7"	27' 6"	29' 1"	29' 8"	29' 9"	31' 3"	31' 11"	33' 11"	32' 7"	32' 6"	33' 10"	35'	36'	35' 5"	37'	36' 8"
Refrigerator (cu. feet)	6	6	6	6	6	6	6	6	6	6	6	6	6	6	6	6	6
Water Heater Cap. (gal. G/E w/DSI)	6	6	6	6	6	6	6	6	6	6	6	6	6	6	6	6	6
Fresh Water Cap. (gal.)	40	40	40	40	40	40	40	40	40	40	40	40	40	40	40	40	40
Waste Water Cap. (gal.)	32	32	32	32	32	32	32	32	32	32	32	32	32	32	32	32	32
Gray Water Cap. (gal.)	32	32	32	32	32	60	32	32	32	32	32	32	32	32	64	32	64
LP Gas Cap. (lbs.)	40	40	40	40	40	40	20	20	40	40	40	40	40	40	40	40	40
Furnace BTUs (1,000s)	20	20	20	20	20	20	25	25	30	25	25	30	30	30	30	30	30
Tire Size	14"	14"	14"	14"	14"	14"	14"	14"	15"	14"	15"	15"	15"	15"	15"	15"	15"
Awning	14'	17'	16'	14'	14'	16'	19'	20'	18'	15'	18'	16'	13'	16'	17'	17'	19'

*This weight reflects the rolling average unit weight for each model. Your trailer weight will vary according to optional equipment.

EXTERIOR FEATURES



Fiberglass front cap is the main feature of the Premium and Platinum Packages!



Floorplans with exterior cook stations are convenient, and allow your family to enjoy the ambience of outdoor cooking without the mess of campfire prep and cleanup.



Our key-alike entry system offers not only the convenience of one lock for all applications, but security as well. Now, other campers with standard industry keys can't open your storage compartments or entry doors!



Rear Storage System offers additional trip storage for firewood, bikes and anything you don't care to store in your unit, and is rated for up to 150 pounds.



Sleek, Euro-style steps feature strong steel linkage and anti-slip rubber grooves. Aluminum steps resist rust and ensure long-lasting durability.



ToyLok® is included in the K-Z Advantage Package (Connect only).



Exterior storage areas are sizable and easy to clean, and include extra-large radius doors with magnetic catches.



The EquaFlex rubberized equalizer absorbs road shock and reduces fore-to-aft movement.



Dealer:



985 N 900 W • Shipshewana, IN 46565
E-mail kz@kz-rv.com • www.kz-rv.com

Due to continual research and advances, manufacturer reserves the right to change specifications, design, price and equipment without notice, and assumes no responsibility for any error in this literature. Some items shown are not included as standard or optional equipment. ©2016KZ | 5/9/17 | 15M