

# DURANGO



Half Ton & Full Profile Fifth Wheels

# Durango 1500



A true half-ton towable, these fifth wheels are beautifully appointed for all your travels, whether a weekend get-away or long-term excursion.

# Durango



Created for the experienced traveler, KZ comfort and convenience surrounds you while discovering the great outdoors in these full profile fifth wheels.

## Exterior Options (Available on Durango and Durango 1500)



Optional Full Body Sandlewood Package



Optional Full Body Sandlewood Package



Optional Partial Paint Espresso Package



**D295CS**  
Earthen Décor

The stylish main living room is bright and airy with large panoramic windows, creating an exceptional feeling of space.



**D295CS** Durango 1500 kitchen is designed to be stylish and functional for today's active camper.



**D295CS**



**D295CS**

# Durango 1500 OPT. TS = Optional Theatre Seating Placement

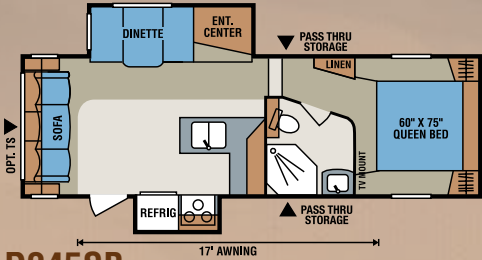

**D245SB**

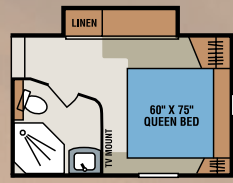

**D245SB**  
Optional Wardrobe Slide

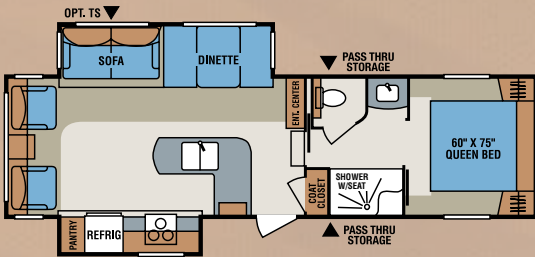

**D2857**



**D2857**  
Optional Bedroom Slide

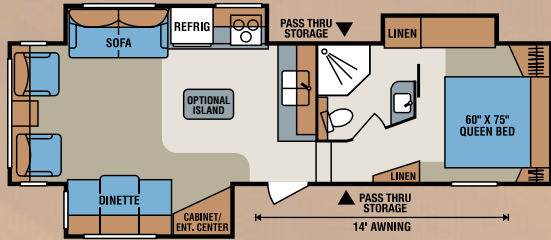

**D295CS**

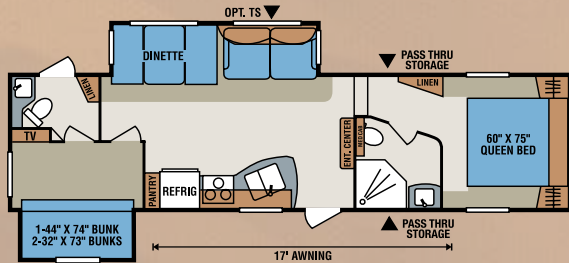

**D296BH**



**D296BH**  
Optional Wardrobe Slide

Fifth Wheels	D245SB	D2857	D295CS	D296BH
UVW (Unloaded Vehicle Weight)*	7,500	8,500	8,438	8,718
Dry Hitch Weight*	1,460	1,415	1,392	1,431
Dry Axle Weight*	6,040	7,085	7,046	7,287
NCC (Net Carrying Capacity)	1,725	1,500	1,562	1,882
GVWR	9,225	10,000	10,000	10,600
Exterior Height w/ A/C	145"	144"	143"	142"
Exterior Width	96"	96"	96"	96"
Exterior Length	27' 11"	31' 8"	31' 11"	33' 11"
Refrigerator (cu. feet)	6	6	6	6
Water Heater Cap. (gal. G/E w/DSI)	6	6	6	6
Fresh Water Cap. (gal.)	55	55	55	55
Waste Water Cap. (gal.)	57	57	57	97
Gray Water Cap. (gal.)	57	57	57	57
LP Gas Cap. (lbs.)	60	60	60	60
Furnace BTUs (1,000s)	30	30	30	30
Tire Size	15"	15"	15"	15"
Awning	16'	15'	14'	17'

\*This weight reflects the rolling average unit weight for each model. Your trailer weight will vary according to optional equipment.



Full profile Durango features a ceiling fan with decorative light.



MaxxAir Vent



Custom designed mosaic backsplash.

Samsung solid surface countertop.



Washer/dryer connection on full profile fifth wheels (floorplan specific.)



Oversized pass-thru storage with slam latch baggage doors.



Outside kitchen features microwave, refrigerator, 2- burner cooktop, and sink with high rise faucet.



Durango 1500

Durango



- |  |   |   |
|--|---|---|
| <p>1 13,500 BTU A/C</p> <p>2 1 piece seamless roofing material</p> <p>3 3/8" walkable roof decking</p> <p>4 Vinyl interior ceiling panel</p> <p>5 4 3/8" truss rafter, 16" O.C.</p> <p>6 R-14 batten insulation (Roof)</p> <p>7 Insulated ductwork</p> <p>8 Exterior clearance and brake lights</p> <p>9 One-piece fiberglass front cap</p> <p>10 Expanded Polystyrene – R-9</p> <p>11 Fiberglass exterior with integrated luan backing</p> <p>12 1/8" luan decorative wall board</p> <p>13 1/8" luan wall board</p> <p>14 3" aluminum framed sidewall</p> | <p>15 Residential style ducted heat run in floor</p> <p>16 Darco® moisture barrier</p> <p>17 Large capacity pass-thru storage with bus style slam latch doors</p> <p>18 Heavy duty I-beam frame construction</p> <p>19 R-14 batten insulation (Floor)</p> <p>20 2x3 floor joist, 16" O.C.</p> <p>21 Heated &amp; enclosed underbelly</p> <p>22 Insulated and heated water tanks</p> <p>23 Fully welded outriggers</p> <p>24 5/8" tongue &amp; groove plywood</p> <p>25 Heavy duty leaf springs</p> <p>26 Heavy duty steel wheels</p> <p>27 Residential style carpet pad</p> <p>28 Rack and pinion electric slide with manual override with 2x2 tube slide out ram</p> | <p>29 Residential carpet or linoleum</p> <p>30 Tinted safety glass windows</p> <p>31 Triple sealed slide outs</p> <p>32 Exterior security/Scare lights</p> <p>33 Snap jacks pull pins</p> <p>34 Extra long drip spouts</p> <p>35 Satellite preparation</p> <p>36 Exterior speakers</p> <p>37 16" tires (15" on Durango 1500)</p> <p>38 Drop bi-level frame (N/A on Durango 1500)</p> <p>39 Spare tire/carrier/cover (Optional on Durango 1500)</p> <p>40 Bedroom Slide (Optional on D245SB, D275RE, D275RL, D2857, and D296BH)</p> <p>41 Dexter <i>NEV-R-ADJUST</i>™ Brakes</p> |
|--|---|---|

Durango



**D3251K**  
Curry Décor

The open floor plan arrangement, featuring plush residential furniture, dinette with four chairs and well equipped kitchen with island, insures a highly sociable layout.



D3251K



**D3251K** Standard in all Durangos, the Bluetooth DVD/CD/AM/FM /Stereo with MP3 Player and LED TV.

**OPT. TS = Optional Theatre Seating Placement**

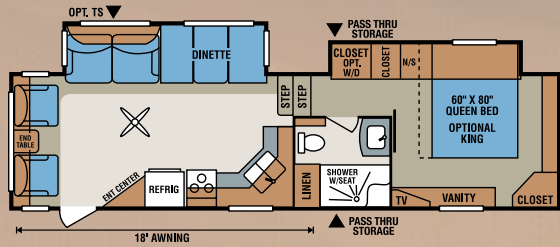

**D296RL**

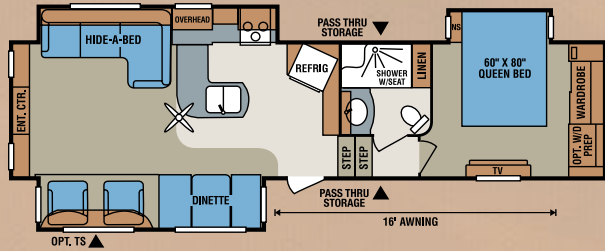

**D336RE**

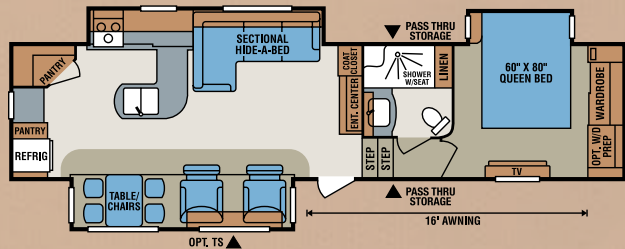

**D348RK**

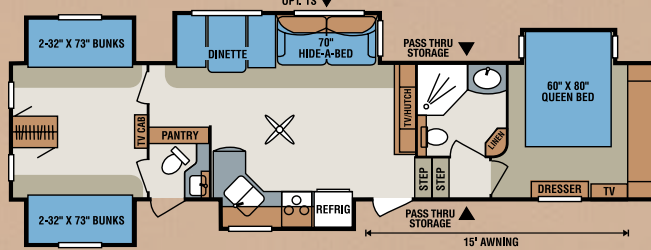

**D358BHK**

**D358BHK**  
Outside  
Kitchen Opt.

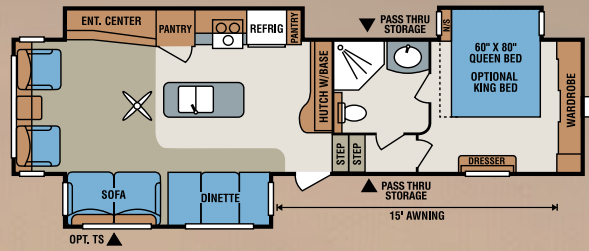

**D325IK**

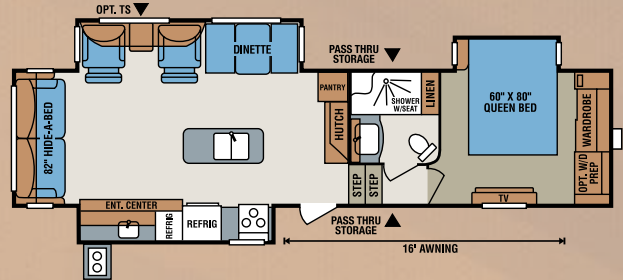

**D345SE**

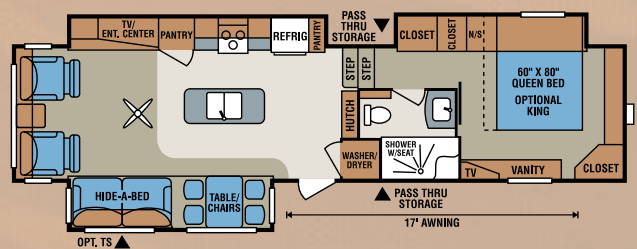

**D355IK**

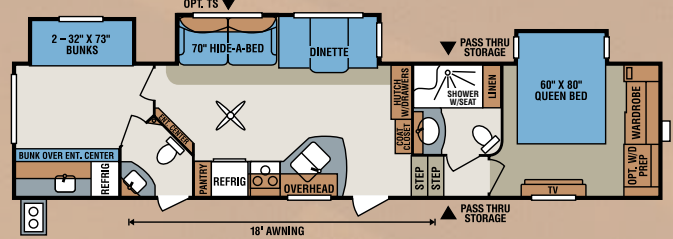

**D365BH**

Fifth Wheels	D296RL	D325IK	D336RE	D345SE	D348RK	D355IK	D358BHK	D365BH
UVW (Unloaded Vehicle Weight) *	9,410	10,030	10,070	10,610	10,790	10,700	11,677	10,920
Dry Hitch Weight *	2,050	1,950	1,830	2,150	1,840	1,940	2,101	2,030
Dry Axle Weight *	7,360	8,080	8,240	8,460	8,950	8,760	9,576	8,890
NCC (Net Carrying Capacity)	2,590	2,470	2,430	2,790	2,610	2,700	2,723	2,480
GVWR	12,000	12,500	12,500	13,400	13,400	13,400	14,400	13,400
Exterior Height w/ A/C	153"	151"	153"	153"	153"	156"	156"	152"
Exterior Width	96"	96"	96"	96"	96"	96"	96"	96"
Exterior Length	33' 10"	35' 2"	36' 2"	36' 8"	37' 8"	37' 6"	39' 8"	40' 2"
Refrigerator (cu. feet)	8	8	8	8	8	8	8	8
Water Heater Cap. (gal. G/E w/DSI)	12	12	12	12	12	12	12	12
Fresh Water Cap. (gal.)	55	55	55	55	55	55	55	55
Waste Water Cap. (gal.)	57	57	57	57	57	57	57	57
Gray Water Cap. (gal.)	57	57	57	57	87	57	114	114
LP Gas Cap. (lbs.)	60	60	60	60	60	60	60	60
Furnace BTUs (1,000s)	30	35	30	35	35	35	35	35
Tire Size	16"	16"	16"	16"	16"	16"	16"	16"
Awning	17'	15'	16'	16'	15'	17'	16'	18'

\*This weight reflects the rolling average unit weight for each model. Your trailer weight will vary according to optional equipment.

## Curry Décor

## Earthen Décor

## Espresso Décor

### Standards

- 2 LED Lights Above Sofa (N/A on Durango 1500)
- 6 Cubic Foot Refrigerator with Raised Panel Wood Insert (Durango 1500 Only)
- 6 Gallon Gas/Electric DSI Water Heater (Durango 1500 Only)
- 8 Cubic Foot Refrigerator with Raised Panel Wood Insert (Optional on Durango 1500)
- 12 Gallon Gas/Electric DSI Water Heater (N/A on Durango 1500)
- 12V LED Light Package
- 16" Tires (15" on Durango 1500)
- 32" LED TV (floorplan specific)
- 39" LED TV (floorplan specific)
- 13,500 BTU Ducted A/C
- AM/FM/CD/DVD Player with USB Port
- Awning with Drip Rail and Spouts
- Black Tank Flush System
- Bus Style Slam Latch Baggage Doors
- Ceiling Fan (N/A on Durango 1500)
- Cotton Cloud Deep Quilt Mattress
- Crown Molding
- Decorative Backsplash in Kitchen
- Decorative Light Above Dinette
- Dexter **NEV-R-ADJUST**® Brakes
- Drawers Under Oven and Refrigerator (Where Available)
- Drop Bi-Level Frame (N/A on Durango 1500)
- Easy Read Command Center
- Enclosed Pin Box
- Extra Large Slam Latch Baggage Doors
- Gas Struts on Bed Base
- Glass Shower Door
- Heated Tanks and Enclosed Underbelly

- Large Assist Grab Handle
- Microwave with Turn Table
- Night Shades
- One-Piece Aerodynamic High Gloss Fiberglass Front Cap
- Outside Shower
- Outside Speakers
- Pillows for Sofa
- Porcelain Toilet
- Power Jacks
- R-14 Insulation in Floor
- Residential Pull Down Faucet
- Roller Ball Bearing Drawer Guides
- Screwless Exterior Moulding
- Security Light
- Skylight Over Tub
- Solid Surface Countertops
- Spare Tire/Carrier/Cover (Optional on Durango 1500)
- Stabilizer Jacks
- Tinted Safety Glass Windows
- Wire for A/C in Bedroom (N/A on Durango 1500)
- Wire for Satellite

### Options

- 2 Barrel Chairs IPO Sofa (D245SB Only)
- 2nd 13,500 BTU A/C in Bedroom (N/A on Durango 1500)
- 4 Point Leveling System with Remote
- 18 Cubic Foot Residential Refrigerator (Includes 1,000 Watt Inverter) (D325IK, D348RK, D355IK and D365BH Only)
- 50 Amp Service
- 15,000 BTU A/C (IPO 13,500 BTU)
- Aluminum Wheels (4)
- Bedroom TV
- Closet Wardrobe Slide (D245SB, D2857 and D296BH Only)
- Cotton Cloud Deep Quilt, Gel Foam Mattress
- Dexter E-Z Flex® Heavy Duty Rubber Suspension
- Dual Pane Windows (N/A on Durango 1500)
- Dyson® Vac
- Espresso Partial Paint Package
- Fireplace
- Flip-up Bike Rack/Cargo Tray
- Flip-up Bunk with Jiffy (D296BH Only)
- Frameless Windows
- Hide-A-Bed (Optional on Durango 1500)
- High Gloss Fiberglass (N/A on Durango 1500)
- Island Kitchen (D295CS Only)
- Jiffy Sofa in Bunk Slide (D358BHK and D365BH Only)
- King Bed (Where Available) (N/A on Durango 1500)
- Ladder
- Maxxair® Vent Fan with Remote (Bedroom and Bathroom)
- Multi-Directional Lighted Power Awning
- Outside Grill (Where Available)
- Outside Kitchen Option (D358BHK Only)
- Power Rear Jacks (N/A with Leveling System) (N/A on Durango 1500)
- Radiant Technology, Calculated Reflective Value of R38
- Recliners – 1 or 2
- Reese® Revolution Hitch (N/A on Durango)
- Roto-Flex Hitch (N/A on Durango 1500)

- Sandlewood Edition
- Side by Side 12 Cubic Foot Refrigerator (Where Available)
- Table and 4 Chairs with Leaf
- Theatre Seating (N/A on D295CS)
- Winegard Dome Satellite (N/A on Durango 1500)

### Luxury Package (N/A on Durango 1500)

- 12 Gallon Gas/Electric DSI Water Heater
- 50 Amp Service
- 15,000 BTU A/C
- Aluminum Wheels with 16" Tires
- Cotton Cloud Deep Quilt Mattress
- Dexter E-Z Flex® Heavy Duty Rubber Suspension
- Ladder
- Maxxair® Vent Fan with Remote (Bedroom and Bathroom)
- Multi-Directional Lighted Power Awning
- Table and 4 Chairs with Leaf
- Wire for 2nd A/C in Bedroom

### Road Trip Package (Durango 1500 Only)

- 8 Cubic Foot Refrigerator
- Aluminum Wheels
- Dexter E-Z Flex® Heavy Duty Rubber Suspension
- Innerspring Mattress
- Ladder
- LED Lighted Power Awning
- Spare Tire/Carrier/Cover



**Dealer Satisfaction Index:** Ratings of manufacturers, by dealers, have consistently awarded KZ top honors for excellence of design, reliability, overall quality and value, communications and dealer support.



Portions of this brochure were used with the expressed authority of Dexter Axle, but Dexter Axle is not responsible for the accuracy of the information contained herein.



Dealer:

### ASK ABOUT OUR 2-YEAR LIMITED WARRANTY!



Join our Family Forum at [www.kzfamilyforum.com](http://www.kzfamilyforum.com)

For more product details and in-depth information, visit us at [www.kz-rv.com](http://www.kz-rv.com)



985 N 900 W • Shipshewana, IN 46565  
E-mail [kz@kz-rv.com](mailto:kz@kz-rv.com) • [www.kz-rv.com](http://www.kz-rv.com)



Due to continual research and advances, manufacturer reserves the right to change specifications, design, price and equipment without notice, and assumes no responsibility for any error in this literature. Some items shown are not included as standard or optional equipment. ©2014KZ | 9/11/14 | 1.5M