

DURANGO



Half Ton & Full Profile Fifth Wheels

Durango 1500



A true half-ton towable, these fifth wheels are beautifully appointed for all your travels, whether a weekend get-away or long-term excursion.

Durango



Created for the experienced traveler, KZ comfort and convenience surrounds you while discovering the great outdoors in these full profile fifth wheels.

Exterior Options (Available on Durango and Durango 1500)



Optional Full Body Sandlewood Package



Optional Full Body Sandlewood Package



Optional Partial Paint Cabernet Package



Optional Partial Paint Espresso Package

Durango 1500



Double slide-outs provide ample living space including sofa, two chairs and optional table and chairs. Solid wood cabinetry offers storage for all your traveling needs including overhead cabinets, kitchen peninsula and optional bedroom slide-out.

D2857
Shale Décor



D2857 Shale Décor



D2857 Shale Décor

Durango 1500

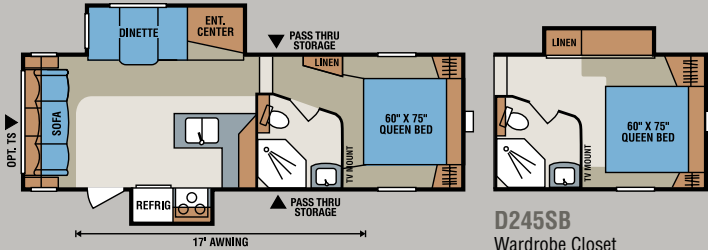

D245SB • Wardrobe Closet Slide Option Available

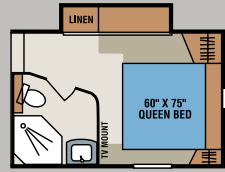

D245SB
Wardrobe Closet Slide Option

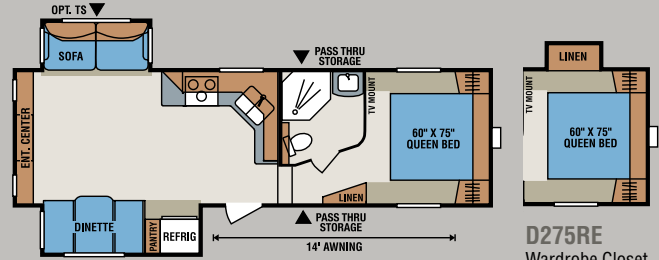

D275RE

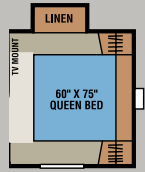

D275RE
Wardrobe Closet Slide Option

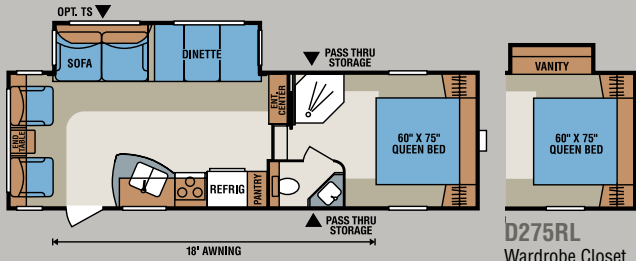

D275RL • Wardrobe Closet Slide Option Available

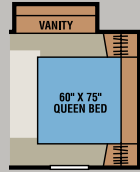

D275RL
Wardrobe Closet Slide Option

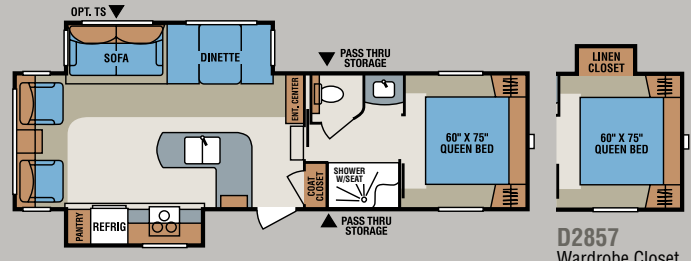

D2857 • Wardrobe Closet Slide Option Available

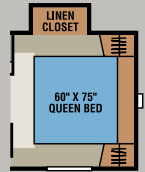

D2857
Wardrobe Closet Slide Option

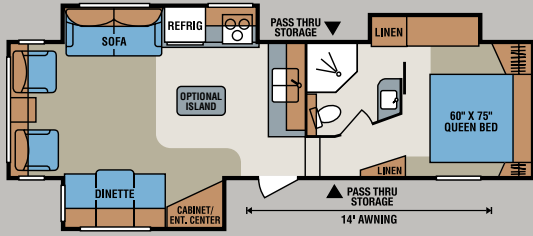

D295CS

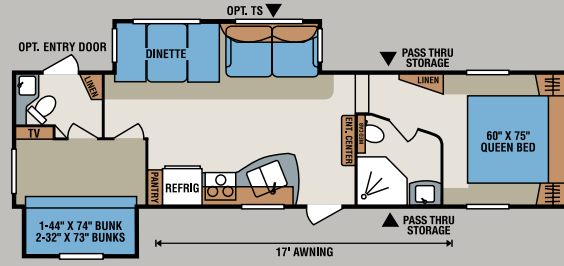

D296BH

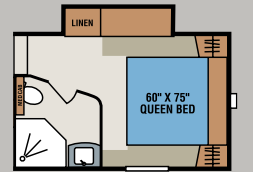

D296BH
Wardrobe Closet Slide Option

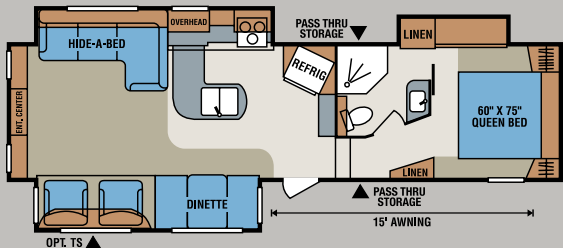

D326CS

OPT. TS = Optional Theatre Seating Placement

Fifth Wheels	D245SB	D275RE	D275RL	D2857	D295CS	D296BH	D326CS
UVW (Unloaded Vehicle Weight)*	7,500	7,636	7,540	8,500	8,438	8,718	8,780
Dry Hitch Weight*	1,460	1,393	1,253	1,415	1,392	1,431	1,380
Dry Axle Weight*	6,040	6,243	6,287	7,085	7,046	7,287	7,400
NCC (Net Carrying Capacity)	1,725	1,589	1,685	1,500	1,562	1,882	1,820
GVWR	9,225	9,225	9,225	10,000	10,000	10,600	10,600
Exterior Height w/ A/C	145"	143 1/2"	144"	144"	143"	142"	144"
Exterior Width	96"	96"	96"	96"	96"	96"	96"
Exterior Length	27' 11"	29' 8"	29' 4"	31' 8"	31' 11"	33' 11"	34' 3"
Refrigerator (cu. feet)	6	6	6	6	6	6	6
Water Heater Cap. (gal. G/E w/DSI)	6	6	6	6	6	6	6
Fresh Water Cap. (gal.)	55	55	55	55	55	55	55
Waste Water Cap. (gal.)	57	57	57	57	57	57	57
Gray Water Cap. (gal.)	57	57	57	57	57	57	57
LP Gas Cap. (lbs.)	60	60	60	60	60	60	60
Furnace BTUs (1,000s)	30	30	30	30	30	30	35
Tire Size	15"	15"	15"	15"	15"	15"	15"
Awning	16'	14'	18'	15'	14'	17'	14'

*This weight reflects the rolling average unit weight for each model. Your trailer weight will vary according to optional equipment.



Durango 1500

Durango



- | | | |
|-----------------------------------------------------|------------------------------------------------------------------------------------|--------------------------------------------------------------------------|
| 1 13,500 BTU A/C | 15 Residential style ducted heat run in floor | 29 Residential carpet or linoleum |
| 2 1 piece seamless roofing material | 16 Darco® moisture barrier | 30 Tinted safety glass windows |
| 3 3/8" walkable roof decking | 17 Large capacity pass-thru storage with bus style slam latch doors | 31 Triple sealed slide outs |
| 4 Vinyl interior ceiling panel | 18 Heavy duty I-beam frame construction | 32 Exterior security/Scare lights |
| 5 4 3/8" truss rafter, 16" O.C. | 19 R-14 batten insulation (Floor) | 33 Snap jacks pull pins |
| 6 R-14 batten insulation (Roof) | 20 2x3 floor joist, 16" O.C. | 34 Extra long drip spouts |
| 7 Insulated ductwork | 21 Heated & enclosed underbelly | 35 Satellite preparation |
| 8 Exterior clearance and brake lights | 22 Insulated and heated water tanks | 36 Exterior speakers |
| 9 One-piece fiberglass front cap | 23 Fully welded outriggers | 37 16" tires (15" on Durango 1500) |
| 10 Expanded Polystyrene – R-9 | 24 5/8" tongue & groove plywood | 38 Drop bi-level frame (N/A on Durango 1500) |
| 11 Fiberglass exterior with integrated luan backing | 25 Heavy duty leaf springs | 39 Spare tire/carrier/cover (Optional on Durango 1500) |
| 12 1/8" luan decorative wall board | 26 Heavy duty steel wheels | 40 Bedroom Slide (Optional on D245SB, D275RE, D275RL, D2857, and D296BH) |
| 13 1/8" luan wall board | 27 Residential style carpet pad | 41 Dexter <i>NEV-R-ADJUST™</i> Brakes |
| 14 3" aluminum framed sidewall | 28 Rack and pinion electric slide with manual override with 2x2 tube slide out ram | |

Durango



D296RL
Redwood Décor

This living space, perfect for relaxing with friends, features a sofa, two chairs, optional table with four chairs and corner entertainment unit. Bedroom slide-out offers lots of storage with side-by-side closets, vanity dresser and corner closet.



D296RL Redwood Décor



D296RL

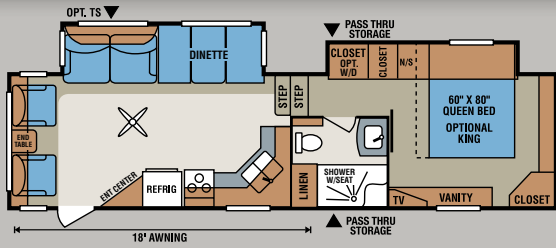

D296RL

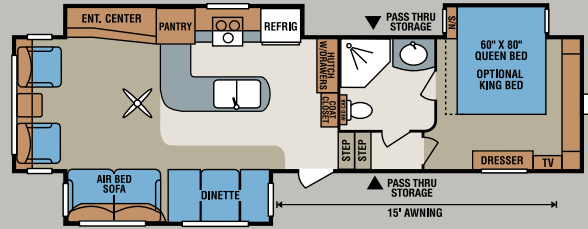

D325RL

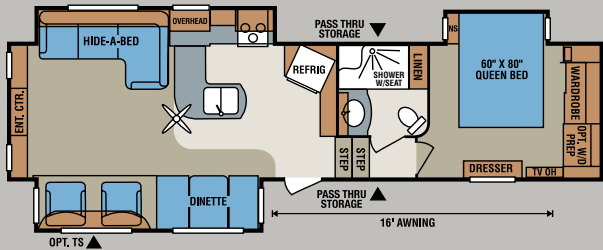

D336RE

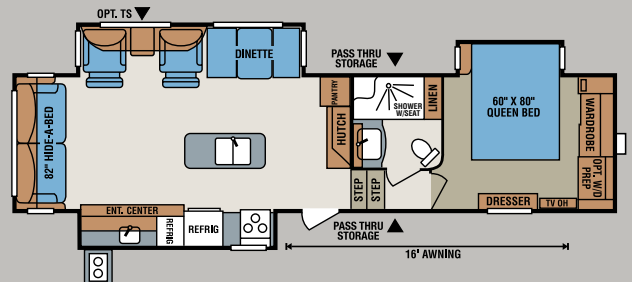

D345SE

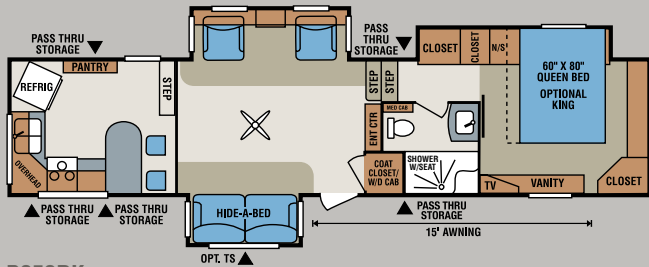

D353RK

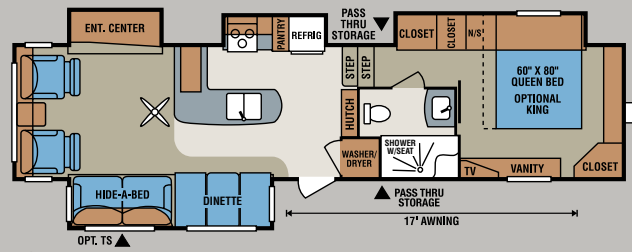

D355RL

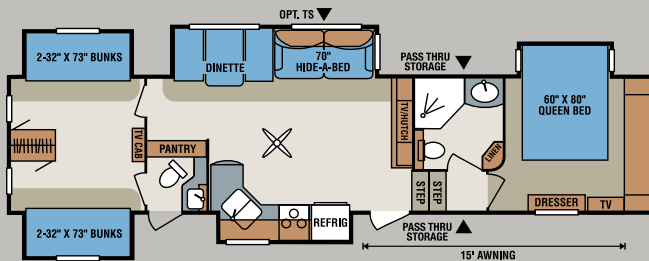

D358BHK

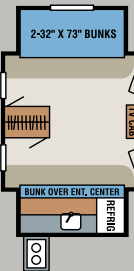

D365BH

Outside Kitchen Option Available on D358BHK

OPT. TS = Optional Theatre Seating Placement

Fifth Wheels	D296RL	D325RL	D336RE	D345SE	D353RK	D355RL	D358BHK	D365BH
UVW (Unloaded Vehicle Weight)*	9,410	10,071	10,070	10,610	10,760	10,784	11,677	10,920
Dry Hitch Weight*	2,050	1,956	1,830	2,150	1,740	1,930	2,101	2,030
Dry Axle Weight*	7,360	8,115	8,240	8,460	9,020	8,854	9,576	8,890
NCC (Net Carrying Capacity)	2,590	2,429	2,430	2,790	2,640	2,616	2,723	2,480
GVWR	12,000	12,500	12,500	13,400	13,400	13,400	14,400	13,400
Exterior Height w/ A/C	153"	151"	153"	153"	158"	158"	156"	152"
Exterior Width	96"	96"	96"	96"	96"	96"	96"	96"
Exterior Length	33' 10"	35' 2"	36' 2"	36' 8"	38' 9"	37' 6"	39' 8"	40' 2"
Refrigerator (cu. feet)	8	8	8	8	8	8	8	8
Water Heater Cap. (gal. G/E w/DSI)	12	12	12	12	12	12	12	12
Fresh Water Cap. (gal.)	55	55	55	55	55	55	55	55
Waste Water Cap. (gal.)	57	57	57	57	57	57	57	57
Gray Water Cap. (gal.)	57	57	57	57	87	57	114	114
LP Gas Cap. (lbs.)	60	60	60	60	60	60	60	60
Furnace BTUs (1,000s)	30	30	30	35	35	30	35	35
Tire Size	16"	16"	16"	16"	16"	16"	16"	16"
Awning	17'	15'	16'	16'	16'	17'	16'	18'

*This weight reflects the rolling average unit weight for each model. Your trailer weight will vary according to optional equipment.

Brown Sugar Décor

Redwood Décor

Shale Décor

Standards

- 2 Halogen Lights Above Sofa (N/A on Durango 1500)
- 6 Cu. Ft. Refrigerator w/Raised Panel Wood Insert (Durango 1500 Only)
- 6 Gallon Gas/Electric DSI Water Heater (Durango 1500 Only)
- 8 Cu. Ft. Refrigerator with Raised Panel Wood Insert (Optional on Durango 1500)
- 12 Gallon Gas/Electric DSI Water Heater (N/A on Durango 1500)
- 16" Tires (15" on Durango 1500)
- 32" LCD TV (Durango 1500 Only)
- 39" LED TV (N/A on Durango 1500)
- 13,500 BTU Ducted A/C
- AM/FM/CD/DVD Player with USB Port
- Awning with Drip Rail and Spouts
- Stabilizer Jacks
- Black Tank Flush System
- Bus Style Slam Latch Baggage Doors
- Ceiling Fan (N/A on Durango 1500)
- Crown Molding
- Decorative Backsplash in Kitchen
- Decorative Light Above Dinette
- Dexter **NEV-R-ADJUST**® Brakes
- Drawers Under Oven and Refrigerator (Where Available)
- Drop Bi-Level Frame (N/A on Durango 1500)
- Easy Read Command Center
- Enclosed Pin Box
- Gas Struts on Bed Base
- Heated Tanks and Enclosed Underbelly
- Innerspring Mattress
- Large Assist Grab Handle
- Larger Baggage Doors
- Microwave with Turn Table
- Night Shades

- One-Piece Aerodynamic High Gloss Fiberglass Front Cap
- Outside Shower
- Outside Speakers
- Pillows for Sofa
- Porcelain Toilet
- Power Jacks
- R-14 Insulation in Floor
- Residential Pull Down Faucet
- Roller Ball Bearing Drawer Guides
- Screwless Exterior Moulding
- Security Light
- Skylight Over Tub
- Solid Surface Countertops
- Spare Tire/Carrier/Cover (Optional on Durango 1500)
- Tinted Safety Glass Windows
- Wire for A/C in Bedroom (N/A on Durango 1500)
- Wire for Satellite

Options

- 2 Barrel Chairs IPO Sofa (D245SB Only)
- 2nd 13,500 BTU A/C in Bedroom (N/A on Durango 1500)
- 4 Point Leveling System (N/A with Power Rear Jacks) (N/A on Durango 1500)
- 12V LED Light Package
- 19" Bedroom TV (N/A on Durango 1500)
- 50 Amp Service (N/A on Durango 1500)
- 15,000 BTU A/C (IPO 13,500 BTU)
- Aluminum Wheels (4)
- Closet Wardrobe Slide (D245SB, D275RE, D275RL, D2857, and D296BH Only)

- Dexter E-Z Flex® Heavy Duty Rubber Suspension
- Dual Pane Windows (N/A on Durango 1500)
- Dyson® Vac
- Entry Door in Bathroom (D296BH Only)
- Fireplace (N/A on D275RL)
- Flip-up Bike Rack/Cargo Tray
- Flip-up Bunk with Jiffy (D296BH Only)
- Frameless Windows
- Glass Shower Door (Forced on D2857, D296RL, D336RE, D353RK, D355RL and D365BH)
- Hide-A-Bed (Optional on Durango 1500, forced on D326CS)
- High Gloss Fiberglass (N/A on Durango 1500)
- Infused High Gloss Fiberglass Sandlewood Exterior (Tan)
- Island Kitchen (D295CS Only)
- Jiffy Sofa in Bunk Slide (D358BHK and 365BH Only)
- Katching ZZ's Mattress Upgrade
- King Bed (Where Available) (N/A on Durango 1500)
- Ladder
- LED Lighted Power Awning
- MaxxAir® Vent (Bedroom and Bathroom)
- Outside Grill (Where Available)
- Outside Kitchen Option (D358BHK Only)
- Partial Paint Package
- Power Rear Jacks (N/A with Leveling System) (N/A on Durango 1500)
- Radiant Technology, Calculated Reflective Value of R38
- Recliners – 1 or 2

- Remote for 4 Point Leveling System (N/A on Durango 1500)
- Roto-Flex Hitch (N/A on Durango 1500)
- Side by Side 12 Cubic Foot Refrigerator (Where Available)
- Table and 4 Chairs with Leaf
- Theatre Seating (N/A D295CS)
- Winegard Dome Satellite (N/A on Durango 1500)

Luxury Package (N/A on Durango 1500)

- 50 Amp Service
- 12 Gallon Gas/Electric DSI Water Heater
- 15,000 BTU A/C
- Aluminum Wheels with 16" Tires
- Dexter E-Z Flex® Heavy Duty Rubber Suspension
- Fan-Tastic® Fan with Remote
- Innerspring Mattress
- Ladder
- LED Lighted Power Awning
- Table and 4 Chairs with Leaf
- Wire for 2nd A/C in Bedroom

Road Trip Package (Durango 1500 Only)

- 8 Cubic Foot Refrigerator
- Aluminum Wheels
- Dexter E-Z Flex® Heavy Duty Rubber Suspension
- Innerspring Mattress
- Ladder
- LED Lighted Power Awning
- Spare Tire/Carrier/Cover



Dealer Satisfaction Index:
Ratings of manufacturers, by dealers, have consistently awarded KZ top honors for excellence of design, reliability, overall quality and value, communications and dealer support.



Portions of this brochure were used with the expressed authority of Dexter Axle, but Dexter Axle is not responsible for the accuracy of the information contained herein.



Dealer:



Join our Family Forum at www.kzfamilyforum.com

ASK ABOUT OUR 2-YEAR LIMITED WARRANTY!

For more product details and in-depth information, visit us at www.kz-rv.com



0985 N 900 W • Shipshewana, IN 46565
E-mail kz@kz-rv.com • www.kz-rv.com



Due to continual research and advances, manufacturer reserves the right to change specifications, design, price and equipment without notice, and assumes no responsibility for any error in this literature. Some items shown are not included as standard or optional equipment. ©2014KZ | 4/7/14 | 15M