



# COYOTE

CAMPERS & TOY HAULERS



For more product details and in-depth information, visit us on the web at [www.kz-rv.com](http://www.kz-rv.com)

# COYOTE

*Lightweight unit offers great floorplans designed with you in mind. Four interior decors to fit your taste.*



16C Exterior

The portable dinette table can be used inside or out. Convert the dinette for extra sleep space.



23CR

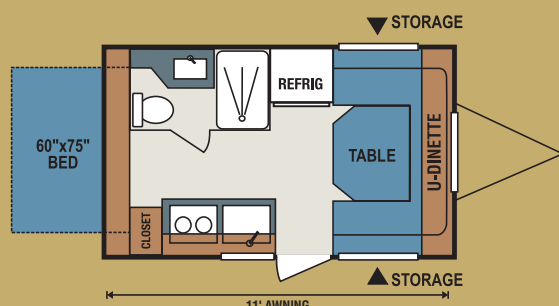

16C • UVW 2780 • Dry Hitch Wt. 290 • NCC 720 • Length 17' 9"

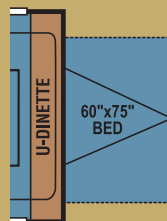

16C • Tent End Opt

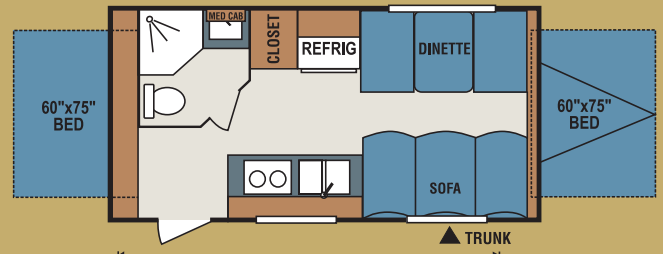

20C • UVW 3340 • Dry Hitch Wt. 400 • NCC 1160 • Length 20' 8"



23CR features spacious queen size beds, one easily converts to bench seat. The Sunbrella tent fabric is standard equipment and is breathable and resistant to UV, mildew and rot.

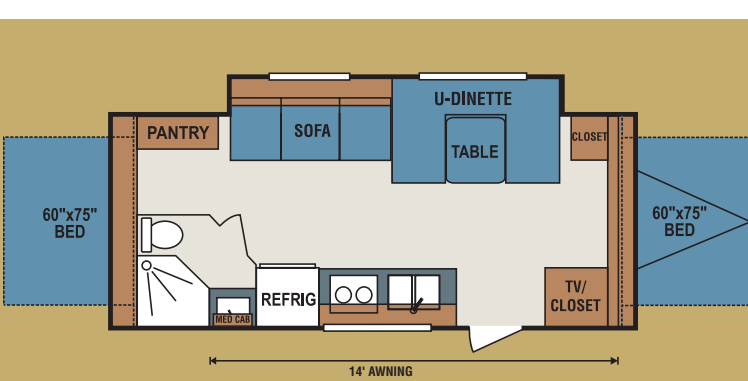

22CP • UVW 4340 • Dry Hitch Wt. 550 • NCC 1160 • Length 23' 8"

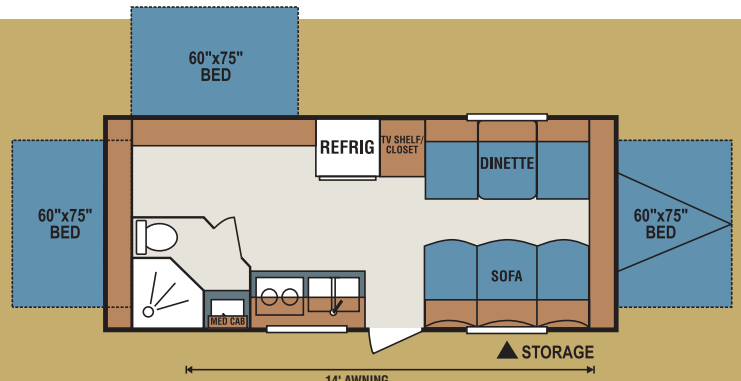

22CT • UVW 3780 • Dry Hitch Wt. 520 • NCC 1220 • Length 23' 7"

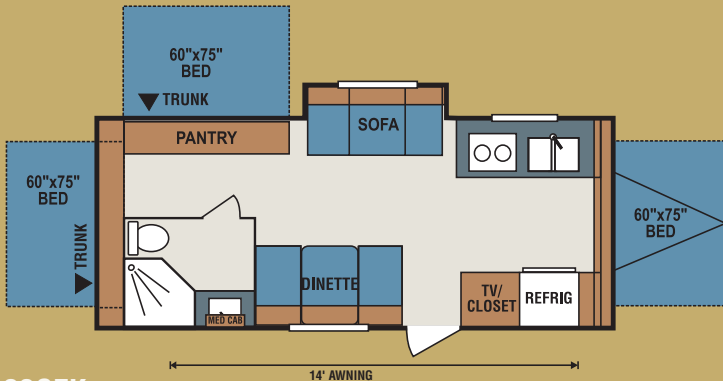

23CFK • UVW 4160 • Dry Hitch Wt. 660 • NCC 1840 • Length 24' 7"

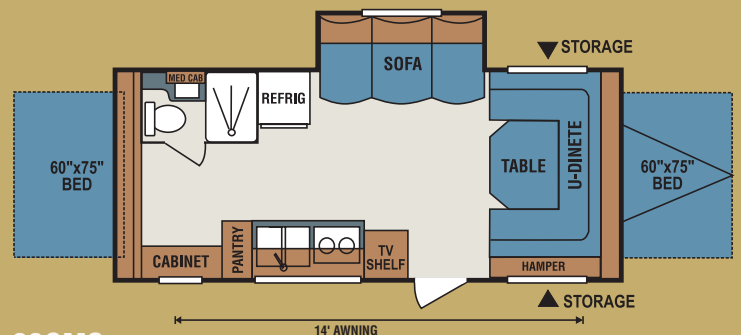

23CMS • UVW 4090 • Dry Hitch Wt. 460 • NCC 1410 • Length 24' 7"

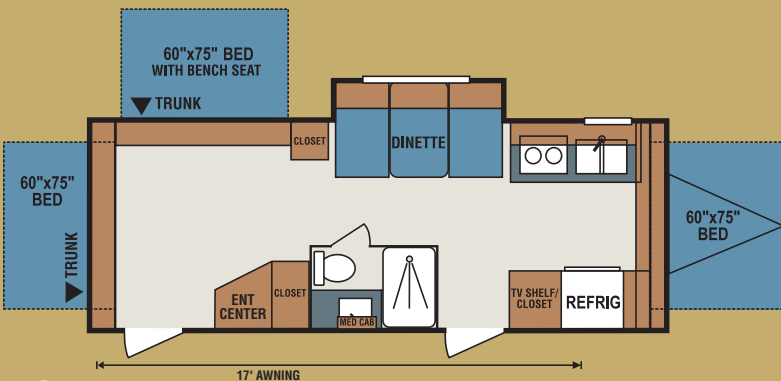

23CR • UVW 4490 • Dry Hitch Wt. 740 • NCC 1510 • Length 26' 3"





# COYOTE

## L I T E



CL180  
Exterior

Kids will love the standard rear bunks and you'll enjoy gathering friends and family around the spacious dinette area which doubles as additional sleep space.



CL232SS  
*shown with standard rear bunks*





The queen size bed features coordinated headboard and bedspread. The durable wood-look vinyl flooring beautifully accents the maple color cabinetry.

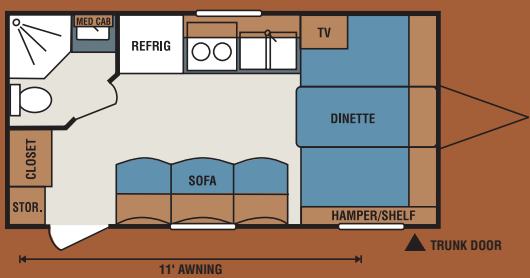

**CL162** • UVW 2930 • Dry Hitch Wt. 320 • NCC 570 • Length 20' 5"

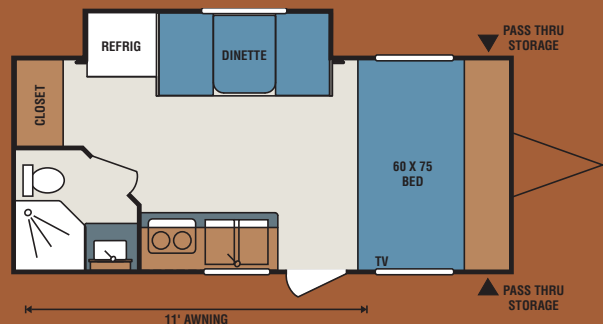

**CL163** • UVW 3010 • Dry Hitch Wt. 330 • NCC 490 • Length 20' 5"

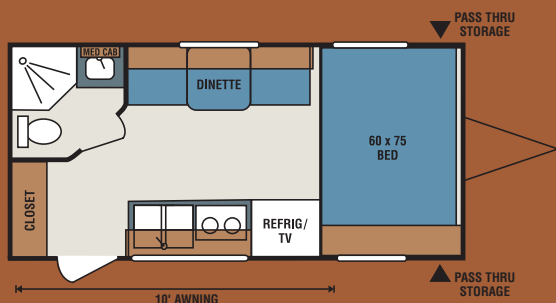

**CL164** • UVW 2820 • Dry Hitch Wt. 290 • NCC 680 • Length 20' 5"

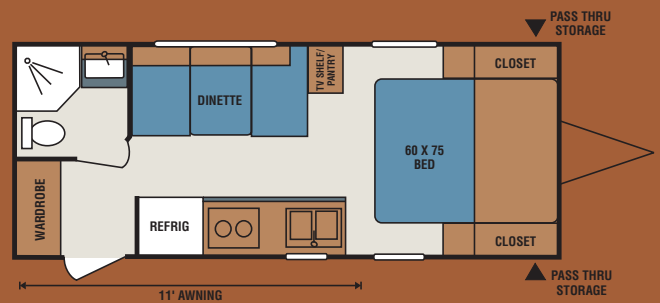

**CL180** • UVW 3580 • Dry Hitch Wt. 320 • NCC 920 • Length 23' 8"

This popular option features a slide out with a rear flip Jiffy sofa and top bunk that stows neatly out of the way. Entertainment center located adjacent to the bunks with convenient storage cabinets and shelf.



shown with optional flip Jiffy sofa and flip-up bunk

# COYOTE LITE

	CL162	CL163	CL164	CL180	CL230	CL232BS	CL232SS
Axle Weight	2610	2680	2530	3260	3530	3720	3960
Dry Hitch Weight	320	330	290	320	490	440	470
UVW (Unloaded Vehicle Weight)	2930	3010	2820	3580	4020	4160	4430
GVWR	3500	3500	3500	4500	5500	5500	5500
Net Cargo Capacity (NCC)	570	490	680	920	1480	1340	1070
Exterior Height w/o A/C	8'6"	8'10"	8'10"	8'11"	8'11"	8'11"	8'11"
Exterior Length	20'5"	20'5"	20'5"	23'8"	27'	27'	27'
Exterior Width	87"	87"	87"	90"	90"	90"	90"
Fresh Water Capacity (Gallons)	20	20	20	40	40	40	40
Black Water Capacity (Gallons)	32	32	32	32	32	32	32
Gray Water Capacity (Gallons)	32	32	32	32	32	32	32
Furnace Size (BTUs) (1000s)	16	16	16	16	20	20	20
LP Gas Capacity (lbs.)	20	20	20	40	40	40	40
Interior Height	78"	78"	78"	78"	78"	78"	78"
Tire Size (Radial)	14"	14"	14"	14"	14"	14"	14"
Awning	11'	11'	10'	11'	16'	16'	16'
Water Heater	6 Gal.	6 Gal.	6 Gal.	6 Gal.	6 Gal.	6 Gal.	6 Gal.

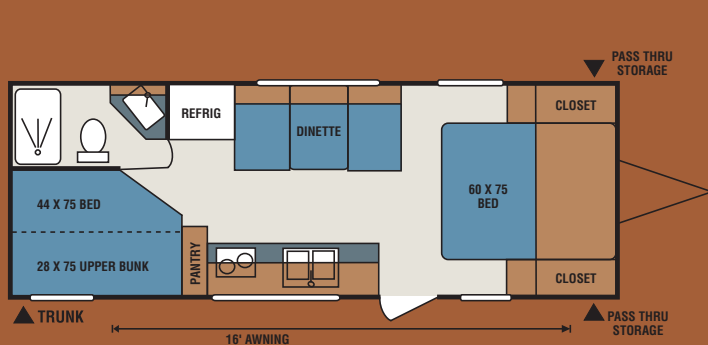

**CL230** • UVW 4020 • Dry Hitch Wt. 490 • NCC 1480 • Length 27'

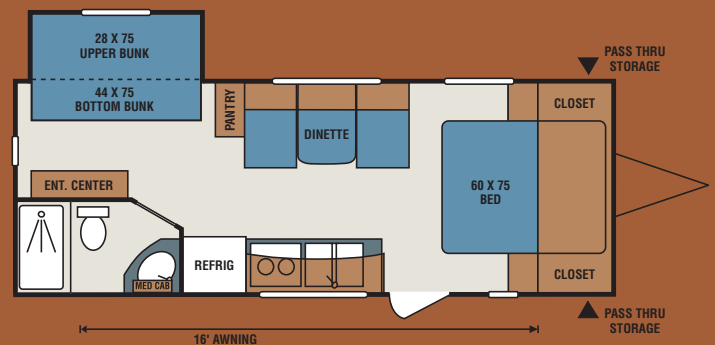

**CL232BS** • UVW 4160 • Dry Hitch Wt. 440 • NCC 1340 • Length 27'

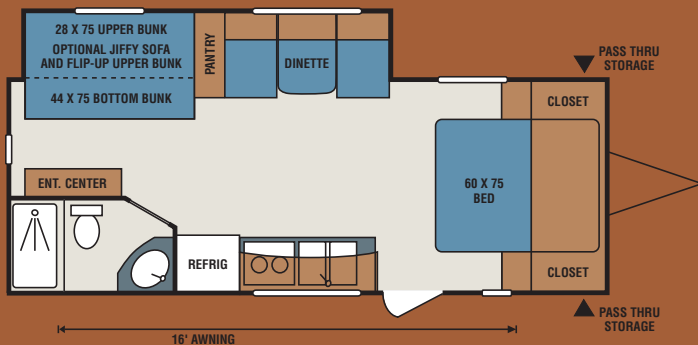

**CL232SS** • UVW 4430 • Dry Hitch Wt. 470 • NCC 1070 • Length 27'

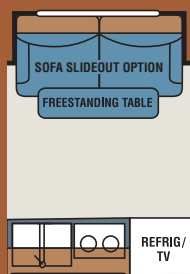

**CL164** • Slide Out Opt.

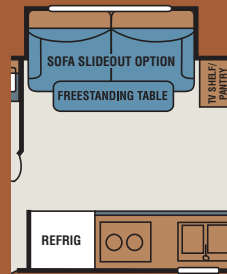

**CL180** • Slide Out Opt.

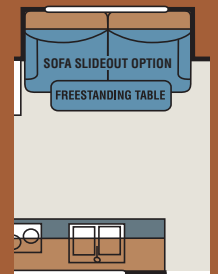

**CL230** • Slide Out Opt.

# COYOTE ROCK CLIMBER

The attractive Lava décor makes a bold statement and the folding dinette table is conveniently used inside or outdoors. Lots of storage space is contained under the dinette seating and in the adjacent cabinets. The U-shape dinette converts into a large sleep space.

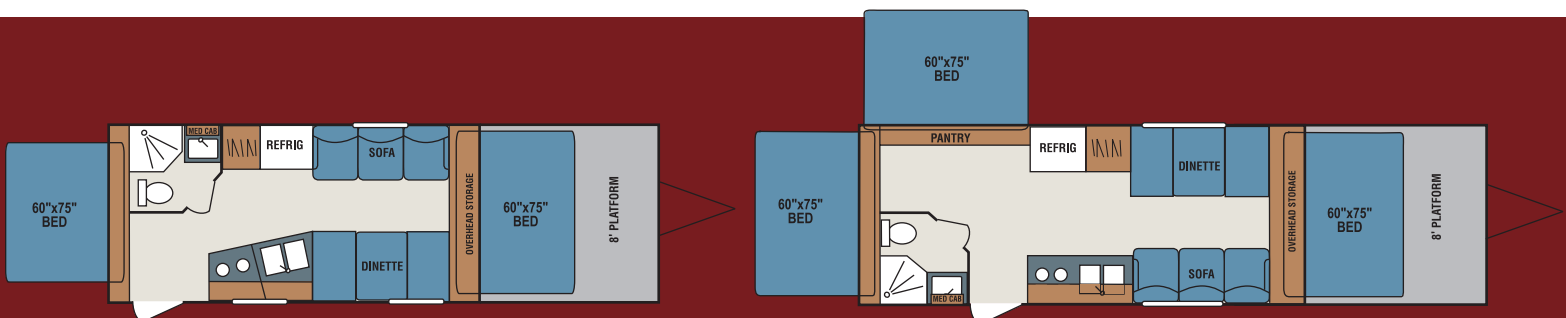

**CRC201** • UVW 4390 • Dry Hitch Wt. 320 • NCC 2610 • Length 29' 7"

**CRC220** • UVW 4750 • Dry Hitch Wt. 290 • NCC 2250 • Length 32' 4"





The sofa easily converts into additional sleep space which reveals storage compartment below the window wide shelf.

Attractive kitchen space has a dual deep bowl sink and a high-rise faucet. The large double door refrigerator, AM/FM/CD player and outside awning are all standard items.

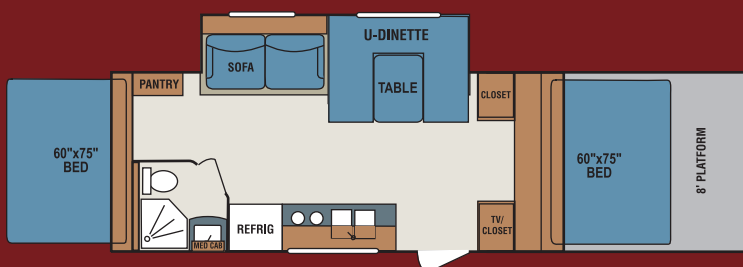

Optional Hunter's Edition exterior graphics.

# COYOTE Rock Climber

CRC201    CRC220    CRC222

Axle Weight	4070	4460	5020
Dry Hitch Weight	320	290	270
UVW (Unloaded Vehicle Weight)	4390	4750	5290
GVWR	7000	7000	7940
Net Cargo Capacity (NCC)	2610	2250	2650
Exterior Height w/o A/C	8'11"	8'11"	8'11"
Exterior Length	29'7"	32'4"	32'4"
Exterior Width	96"	96"	96"
Fresh Water Capacity (Gallons)	55	55	55
Black Water Capacity (Gallons)	32	32	32
Gray Water Capacity (Gallons)	30	30	30
Furnace Size (BTUs) (1000s)	20	20	20
LP Gas Capacity (lbs.)	40	40	40
Interior Height	78"	78"	78"
Tire Size (Radial Mud Boggers)	15"	15"	15"
Awning	14'	14'	14'
Water Heater	6 gal.	6 gal.	6 gal.



*The Coyote Rock Climber offers an ample 8' x 8' deck to haul your toys. It handles two ATVs, four dirt bikes or four bicycles.*

## INTERIOR DÉCOR for Coyote Rock Climber



Bedrock



Lava

### Interior Décor Package



Cabinet Door (Bedrock)



2-Tone Wood (Bedrock)



Cabinet Door (Lava)



2-Tone Wood (Lava)



Wall Panels

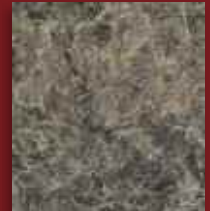

Countertops

## INTERIOR DÉCOR for Coyote & Coyote Lite



Adobé



Earth



Jade



Passion

# STANDARDS AND FEATURES

## APPLIANCES / EQUIPMENT

6 Cu. Ft. Flush Mount Norcold Refrigerator (N/A CL162, CL163, CL164)	●	●	●
2 Burner Range Top	●	●	●
12V Range Hood with Light	●	●	●
Six Gallon Gas Water Heater	●	●	●
Shurflo Water Pump	●	●	●
Laminated Countertops	●	●	●
Double Bowl Kitchen Sink	●	●	●
Flared Copper LP Gas Lines	●	●	●
Color Coded Water Lines	●	●	●
Water Heater Bypass Kit	●	●	●
Oil Rubbed Bronze Hardware	●	●	●
16,000/20,000 BTU Furnace	●	●	●

## BATH

Wall Mounted Light Switch	●	●	●
Monitor Panel	●	●	●
Medicine Cabinet with Mirror	●	●	●
Sink and Faucet	●	●	●
Decorative Tub Surround	●	●	●
Adjustable Shower Head	●	●	●
12V Power Roof Vent	●	●	●
Thetford Toilet	●	●	●
Decorative Shower Curtain	●	●	●
ABS Shower Pan or Tub	●	●	●
Skylight in Bathroom	●	●	●

## CONSTRUCTION

Welded, Aluminum Frame, Laminated Sidewalls with 1" Polystyrene Block Foam Insulation (R-5)	●	●	●
Radius Bathroom Walls	●	●	●
Framed, Braced and Wired for Air Conditioner	●	●	●
Rotocast Fresh Water Tank	●	●	●
Cable Support for Bunk Ends	●	●	●
One Piece Woven Plastic Underbelly on Floor	●	●	●
1/2" Plywood Floor	●	●	●
One Piece, Seamless TPO Roof	●	●	●

## EXTERIOR EQUIPMENT

Stabilizer Jacks (4)	●	●	●
White Mods Wheels	●	●	●
Metal Wheel Well	●	●	●
Lockable Bunk Ends	●	●	●
Sunbrella Tent	●	●	●
Sewer Hose Compartment	●	●	●
Heavy Duty Retractable Entry Step	●	●	●
Painted Bottom Radius Metal Skirting	●	●	●
Drip Spouts	●	●	●
Radius Entrance Door	●	●	●
E-Z Lube Axles	●	●	●
Gas Bottle Cover	●	●	●
Lockable, Radius Corner Baggage Doors	●	●	●
ABS Fender Skirts	●	●	●
2 5/16" Hitch Coupler	●	●	●
Patio Light	●	●	●
14" Radial Tires	●	●	●
15" Radial Tires	●	●	●
110V GFCI Exterior Receptacle	●	●	●
Awning	●	●	●
TV Antenna & Booster	●	●	●
13,500 BTU A/C	●	●	●
20# Propane Gas Bottle (Some Models)	●	●	●
Double 20# Propane Gas Bottles	●	●	●
30 Amp Power Cord (30ft.)	●	●	●
55 Amp Converter	●	●	●
Tinted/Safety Windows	●	●	●
Outside Spray Port	●	●	●

## SAFETY EQUIPMENT

Smoke Detector	●	●	●
LP Detector	●	●	●
Egress Exit Windows	●	●	●
Fire Extinguisher	●	●	●
Breakaway Switch	●	●	●
Carbon Monoxide Detector	●	●	●
Dual Safety Chains	●	●	●
Dead Bolt on Entry Door	●	●	●

## INTERIOR EQUIPMENT

Quilted Decorated Bedspread (Selected Models)	●	●	●
Shirt Wardrobe	●	●	●
Sink Cover	●	●	●
5" Cushions for Bunk Ends	●	●	●
AM/FM/CD Player	●	●	●
Lights in Bunk Ends	●	●	●
RG6 Coax with Cable Hookup	●	●	●
Maple Wood, Mortise and Tenon Doors	●	●	●
Mini Blinds	●	●	●
Vinyl Flooring	●	●	●
Molded Plastic Drawer Bins	●	●	●
Steel Drawer Frame for Bins	●	●	●

## OPTIONAL EQUIPMENT

Outside Grill	●	●	●
Aluminum Wheels	●	●	●
Heated Bunk End	●	●	●
Sport Entertainment Package 1	●	●	●
50 Gallon Fresh Water	●	●	●
Fuel Cell with Pump	●	●	●
Oven (N/A CL162, CL163, CL164)	●	●	●
Spare Tire, Carrier and Cover	●	●	●
Power Awning	●	●	●
Rollover Bed w/Bed (CL180 & CL230 only)	●	●	●
15" TV	●	●	●
Utility Tray	●	●	●
2 Speed Bunk Fan	●	●	●
Front Overhead Maple Cabinet Doors	●	●	●
Outside Speakers	●	●	●
Microwave	●	●	●
Outside Shower	●	●	●
Heat Strip	●	●	●
6 Gal. Gas/Elec DSI Water Heater	●	●	●
Front Tent (16C only)	●	●	●
Hunter's Edition Graphics	●	●	●

## Interior Décor Package



Cabinet Door



2-Tone Wood



Wall Panels



Countertops



Flooring



**2X2 WARRANTY** – The KZ Recreational Vehicles 2x2 Warranty is a manufacturer's warranty. Each KZ product is warranted to the original purchaser for twenty-four (24) months from the original date of purchase. Coverage includes appliances, components, construction and FULL structure. The appliances and other amenities are warranted by the individual manufacturers of those components, not KZ. Our warranty is also transferable within the first two (2) years for a small processing fee. For a copy of the warranty with full terms and conditions, ask your local KZ Dealer or visit our web site at <http://www.kz-rv.com>.

**VEHICLE LOADING** – Every effort has been made to provide the greatest number of options for the recreation vehicle owner. Each owner is responsible to select loads allowing the recreational vehicle to remain within the manufacturer's specified chassis weight limits. Do not overload the recreational vehicle.

**UNLOADED VEHICLE WEIGHT (UVW)** – The typical weight of this trailer as built at the factory. The UVW does not include cargo, LP gas, fresh water, options or dealer-installed accessories.

**GROSS VEHICLE WEIGHT RATING (GVWR)** – The maximum permissible weight of the trailer, including the UVW plus passengers, all cargo, personal items, fluids, options and dealer-installed accessories. The GVWR is equal to or greater than the sum of the UVW and the NCC.

**NET CARRYING CAPACITY (NCC)** – The maximum weight of all passengers, personal items, fresh water, food, tools, LP gas, other cargo and dealer-installed accessories\* that can be carried by the trailer. NCC is equal to or less than GVWR minus UVW.

\* The addition of options will decrease the NCC.

It is important for your safety and enjoyment that your tow vehicle be adequately sized and equipped to tow and handle the GVWR of the RV you select. Review weights and rating of your tow vehicle and consult a competent advisor for questions or advice. Whether you are new to RVing or a seasoned veteran, get a feel for the performance of your tow vehicle and the RV together before heading out on the roadways. When you tow an RV, you must drive differently than you do when driving a single vehicle. Practice hooking up, driving, backing up and braking in a safe environment or seek out professional instruction.

See specification charts. KZ affixes a weight label to each new RV which lists weight information for that vehicle.

**NOTE:** This information is intended as a guide only. Weights of individual vehicles are approximate. Consult your Owner's Manual for complete loading, weighing and towing instructions. All weights may vary.

**MECHANICAL PROTECTION & BENEFITS**  
**KZ CARE**  
... because we care.

One less thing to worry about.

Worry-free protection against unexpected repairs for new or pre-owned travel trailers, fifth wheels and toy haulers

- Comprehensive coverage
- Professional claims administration with over 25 years of experience
- Protection throughout the United States and Canada
- Special coverages
- 24-hour roadside assistance benefits
- Trip interruption benefits
- Service call benefits

Administered by:  
United Service Protection Corp. • **United Service Protection Inc. (in FL only)**  
P.O. Box 20899, St. Petersburg, FL 33742-0899 • Toll-Free: 1-800-685-3034  
Florida License #60016000 • © Assurant, Inc. 2008



# Better than ever!

# COYOTE



0985 N 900 W • Shipshewana, IN 46565  
e-mail: [kz@kz-rv.com](mailto:kz@kz-rv.com) • [www.kz-rv.com](http://www.kz-rv.com)

Due to continual research and advances, manufacturer reserves the right to change specifications, design, price and equipment without notice, and assumes no responsibility for any error in this literature. Some items shown are not included as standard or optional equipment. ©2009KZ

Dealer: