

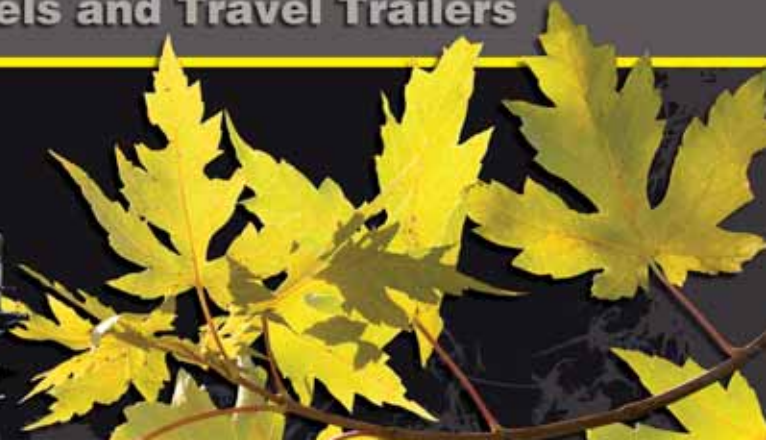

SPORTSMEN[®]
Fifth Wheels and Travel Trailers





S265RE

SPORTSMEN®

Fifth Wheels

Seasons may change, but one thing always stays the same...
KZ's commitment to quality and service.



The entertainment center is beautifully detailed with a residential look and feel.



The sofa easily converts to a comfortable sleeping area.



Private master suite with plenty of storage.



Private entry into a spacious bathroom.

Sportsmen® has earned its great reputation for many good reasons. Function, details and great looks all combined in one affordable unit.



S321BH

SPORTSMEN[®]

Travel Trailers

Your new KZ Sportsmen[®] will take you through every season, for many years to come.



Convenient kitchen layout, complete with pantry and spice rack make food preparation a breeze.

Bunk area offers the perfect place for the kids to relax.

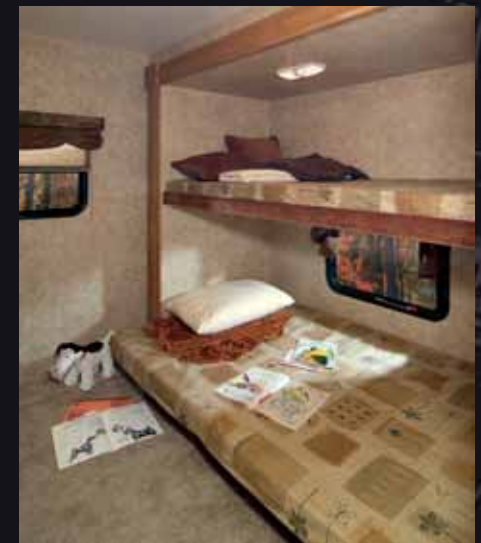

The oversized U-dinette converts effortlessly into additional sleeping space.



Private master bedroom offers mirrored closet doors with additional overhead storage.



Spacious side bath with exterior door allows the kids to come and go without tracking in dirt.

SPORTSMEN®

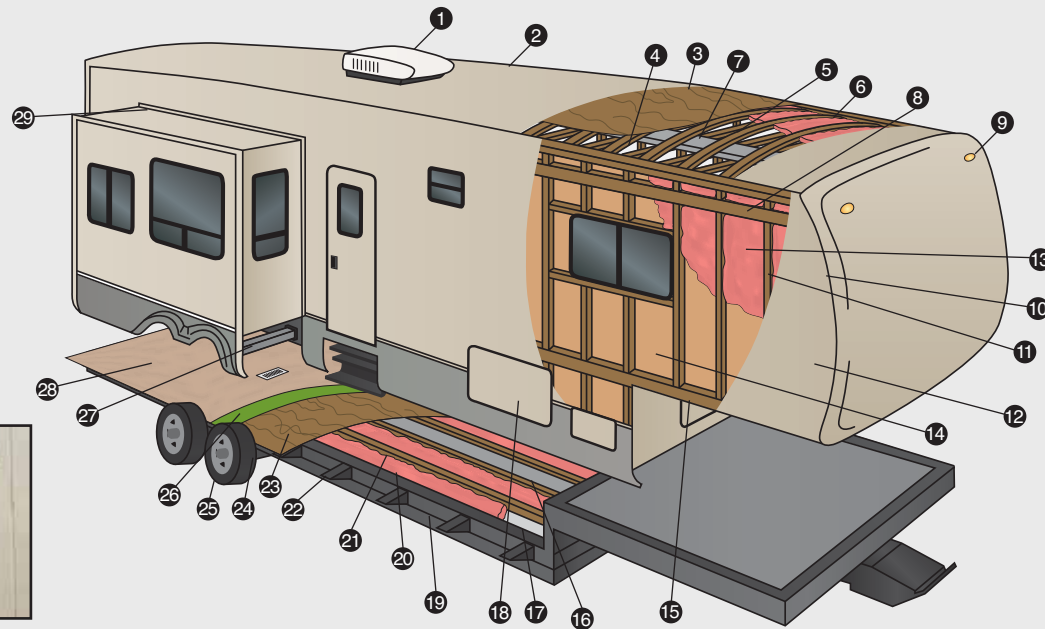

Enclosed Pinbox (Included in Select Pkg)
Pinbox Extension (standard.)



13,500 BTU A/C (standard)
15,000 BTU A/C (optional)



Assist Grab Handle
(Included in Select Pkg)



Tinted/Safety Windows
(standard.)



Exterior Shower
(standard)



Drip rails and spouts
keep the water flowing
away from the sidewalls.



Because it Rains!
We randomly test our K-Z
campers from every product
line in our state of the art
rain booth. The rain may spoil your
fun outside, but it won't inside.

Cut-Away Features

- 1 13,500 BTU A/C
- 2 TPO Vinyl Roof
- 3 3/8" Decking
- 4 Vinyl Interior Ceiling Panel
- 5 4 1/2" Wood Truss Rafters, 16" O.C.
- 6 R-7 Batten Insulation
- 7 Insulated Ductwork
- 8 1 1/2" x 5" Heavy Duty Laminated Wood Headers
- 9 Exterior Clearance and Brake Lights
- 10 2x2 Wood Frame Front and End Walls
- 11 2x2 Wood Studs, 16" O.C.
- 12 Metal Siding (standard)
- 13 R-7 Batten Insulation
- 14 Decorative Luan Wall Board
- 15 Single 8" Wood Stringer
- 16 Residential Style Ducted Heat Run in Floor
- 17 Darco® Moisture Barrier
- 18 Large Capacity Pass-Thru Exterior Storage with Radius Doors Front and Side for Easy Access
- 19 Heavy Duty I-beam Frame Construction
- 20 R-7 Batten Insulation
- 21 2x3 Wooden Floor Joists, 16" O.C.
- 22 Fully Welded Out Riggers
- 23 5/8" Tongue and Groove Plywood
- 24 Heavy Duty Leaf Spring Axles
- 25 Heavy Duty Steel Wheels
- 26 Residential Style Carpet Pad
- 27 Rack and Pinion Electric Slide with Manual Override
- 28 28 oz. Residential Carpet or Linoleum
- 29 Triple Sealed Slide Outs

Travel Trailers	S231RS	S240BHS	S251RB	S261RK	S280BH	S280RL	S290KB	S290RE	S310FK	S310RKS	S321BH	S324BH
UVW (Unloaded Vehicle Wt.)	5029	4546	4960	5164	6006	6344	6929	6437	7262	6806	7309	6600
Dry Hitch Wt.	472	582	513	563	691	682	1029	666	1359	649	734	832
Dry Axle Wt.	4557	3964	4137	4790	5315	5662	5900	5771	5903	6350	6567	5768
NCC (Net Carrier Capacity)	1471	1954	1340	1836	3994	3656	3071	3563	2738	3194	2691	3400
GVWR	6500	6500	6500	7000	10000	10000	10000	10000	10000	10000	10000	10000
Interior Height	78"	78"	78"	78"	82"	82"	82"	82"	82"	82"	82"	82"
Exterior Width	96"	96"	96"	96"	96"	96"	96"	96"	96"	96"	96"	96"
Exterior Length	27'1"	27'4"	26'	28'9"	29'6"	30'	32'10"	32'10"	34'	33'9"	34'3"	34'
Refrigerator (cu. feet)	6	6	6	6	6	6	6	6	6	6	6	6
Water Heater Cap. (gal. G/E w/DSI)	6	6	6	6	6	6	6	6	6	6	6	6
Fresh Water Cap. (gal.)	40	40	40	40	40	40	40	40	40	40	40	40
Waste Water Cap. (gal.)	32	32	32	32	32	32	32	32	32	32	32	32
Gray Water Cap. (gal.)	32	32	32	61	32	32	32	32	61	61	32	32
LP Gas Cap. (lbs.)	60	60	60	60	60	60	60	60	60	60	60	60
Furnace BTUs (1,000's)	20000	20000	20000	20000	25000	25000	25000	25000	30000	30000	30000	30000
Tire Size	15"	15"	15"	15"	15"	15"	15"	15"	15"	15"	15"	15"
Awning	16'	17'	15'	16'	15'	15'	17'	18'	16'	16'	16'	17'

Fifth Wheels	S235RK	S245RL2	S256BH	S265RE	S285RL	S285RL2	S305KS3	S305RE	S305RE2	S315BH	S315BH2	S325BH3
UVW (Unloaded Vehicle Wt.)	6007	7270	7202	7673	7784	7967	8665	8063	8342	8376	8794	9217
Dry Hitch Wt.	974	1337	1294	1590	1605	1789	1815	1766	1967	1734	1950	1967
Dry Axle Wt.	5033	5933	5972	6083	6179	6189	6850	6297	6375	6642	6844	7250
NCC (Net Carrier Capacity)	1893	2530	2698	2327	3316	3133	2535	3137	2958	2924	2606	2283
GVWR	7900	9900	9900	10000	11100	11100	11200	11200	11300	11300	11400	11500
Interior Height	90"	90"	90"	90"	97"	97"	97"	97"	97"	97"	97"	97"
Exterior Width	96"	96"	96"	96"	96"	96"	96"	96"	96"	96"	96"	96"
Exterior Length	25'3"	27'6"	30'	30'9"	31'	31'	32'5"	33'	33'	34'	34'	34'4"
Refrigerator (cu. feet)	6	6	6	6	6	6	6	6	6	6	6	6
Water Heater Cap. (gal. G/E w/DSI)	6	6	6	6	6	6	6	6	6	6	6	6
Fresh Water Cap. (gal.)	40	40	40	40	40	40	40	40	40	40	40	40
Waste Water Cap. (gal.)	50	50	50	50	50	50	50	50	50	50	50	50
Gray Water Cap. (gal.)	79	50	50	50	50	50	50	50	50	50	50	50
LP Gas Cap. (lbs.)	60	60	60	60	60	60	60	60	60	60	60	60
Furnace BTUs (1,000's)	20000	25000	25000	25000	30000	30000	30000	30000	30000	30000	30000	30000
Tire Size	15"	15"	15"	15"	15"	15"	15"	15"	15"	15"	15"	15"
Awning	15'	17'	15'	12'	17'	17'	17'	17'	17'	17'	17'	17'

Four Distinctive Interior Selections

Citrus Décor

Main Fabric and Accent

Bedroom Fabric

Jewel Décor

Main Fabric and Accent

Bedroom Fabric

Pecan Décor

Main Fabric and Accent

Bedroom Fabric

Pistachio Décor

Main Fabric and Accent

Bedroom Fabric

Common Interior Décor Package

Cabinet Door Wall Panels Countertops Flooring Carpet

Sportsmen Mandatory Package (FORCED OPTION)

- 13,500 Ducted BTU A/C
- Awning
- Microwave w/Turn Table
- AM/FM/CD Player
- AM/FM Stereo w/DVD & 5.1 Surround Sound (available in most units with full length entertainment centers)
- TV Antenna & Booster
- Oven
- Exterior Shower
- Cable Hook-Up
- Night Shades
- 6 Gallon Gas/Electric DSI Water Heater
- Raised Panel Mortise & Tenon Overhead Cabinet Doors in Kitchen
- 30 lb. LP Gas Bottles w/Bottle Cover
- Winter By-Pass Kit
- Bedspread
- Monitor Panel
- Power Vent in Bath
- Porch Light on ODS
- Hitch Light
- Straight Axles
- Raised Panel Bath Door
- 6 Cu. Double Door Refer w/Raised Panel Insert
- Pillows for Sofa
- Bathroom Accessories
- Sink Cover
- 15" Tires
- Stabilizer Jacks (4-TT/2-FW)
- Power Jacks (FW)
- Tinted/Safety Windows
- Equa-Flex Suspension (FW 28' & Larger)

Select Package

- All of the Sportsmen Mandatory Pkg.
- Heated Tanks & Enclosed Insulated Underbelly
- Skylight over Tub
- Drawers Under Dinette Seats
- Assist Grab Handle
- Decorative Wall Hanging Enclosed
- Enclosed Pin Box on (FW's)

Additional Options

- Fiberglass Exterior
- 15,000 BTU A/C
- Ladder
- Outside Grill
- Spare Tire, Carrier & Cover
- Air Bed Hide-A-Bed
- Recliner 1 or 2
- Shur-Flo Fan w/Remote
- Table & 4 Chairs w/Leaf
- LCD Flat Screen TV
- 16" Tires w/12,000 lb. Axles
- Solid Wall w/Swing Door (S325BH3 only)
- 2nd Bath Option (S325BH3 only)
- Black Tank Flush
- Power Awning
- 8 Cu. Refrigerator

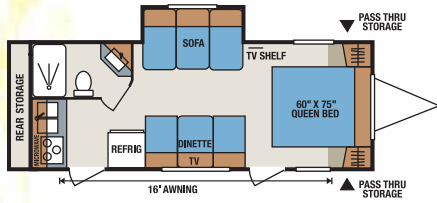

S231RS • UVW 5029 • Dry Hitch Wt. 472 • NCC 1471 • Length 27'1"

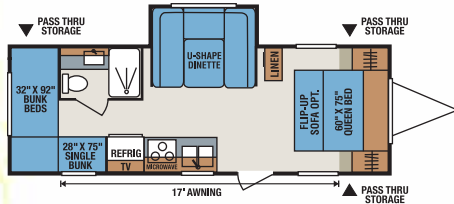

S240BHS • UVW 4526 • Dry Hitch Wt. 582 • NCC 1954 • Length 27'4"

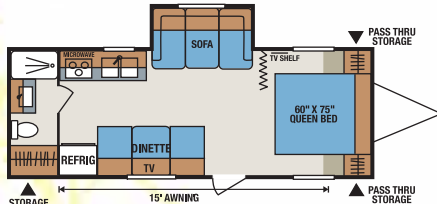

S251RB • UVW 4960 • Dry Hitch Wt. 513 • NCC 1340 • Length 26'

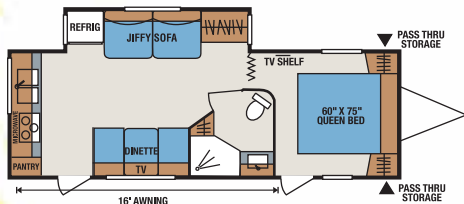

S261RK • UVW 5164 • Dry Hitch Wt. 563 • NCC 1836 • Length 28'9"

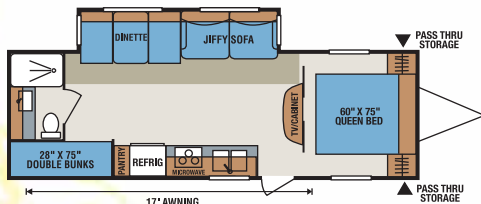

S280BH • UVW 6006 • Dry Hitch Wt. 691 • NCC 3994 • Length 29'6"

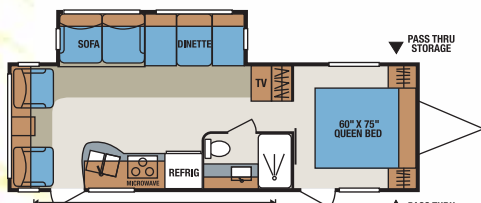

S280RL • UVW 6344 • Dry Hitch Wt. 682 • NCC 3656 • Length 30'

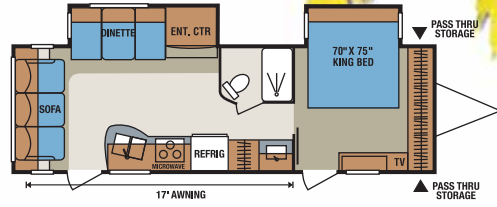

S290KB • UVW 6929 • Dry Hitch Wt. 1029 • NCC 3071 • Length 32'10"

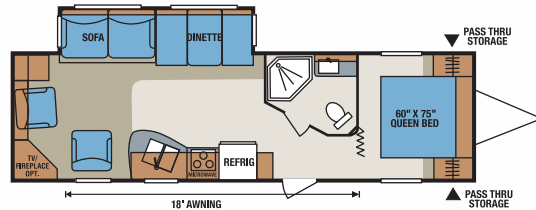

S290RE • UVW 6437 • Dry Hitch Wt. 666 • NCC 3563 • Length 32'10"

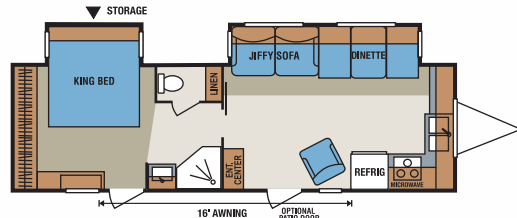

S310FK • UVW 7262 • Dry Hitch Wt. 1359 • NCC 2738 • Length 34'

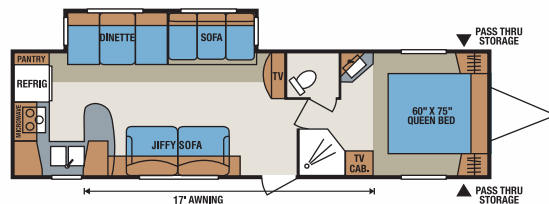

S310RKS • UVW 6806 • Dry Hitch Wt. 649 • NCC 3194 • Length 33'9"

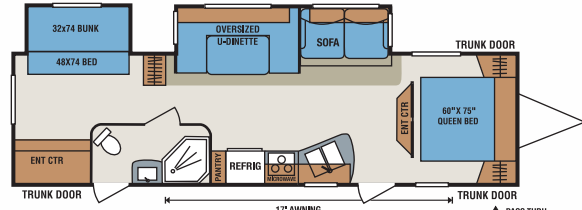

S321BH • UVW 7309 • Dry Hitch Wt. 734 • NCC 2691 • Length 34'3"

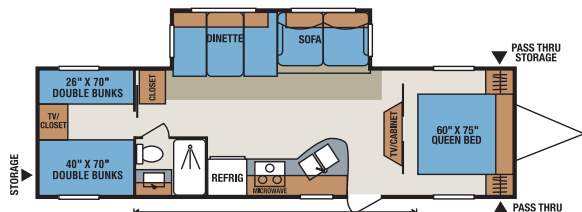

S324BH • UVW 6600 • Dry Hitch Wt. 832 • NCC 3400 • Length 34'

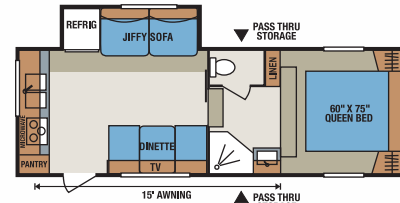

S235RK • UVW 6007 • Dry Hitch Wt. 974 • NCC 1893 • Length 25'3"

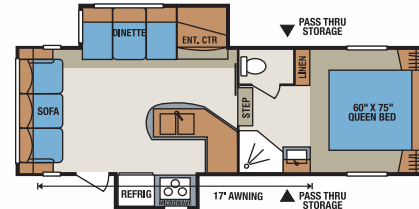

S245RL2 • UVW 7270 • Dry Hitch Wt. 1337 • NCC 2530 • Length 27'6"

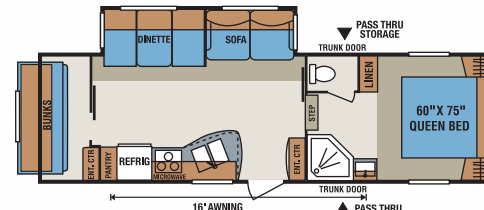

S256BH • UVW 7202 • Dry Hitch Wt. 1294 • NCC 2698 • Length 30'

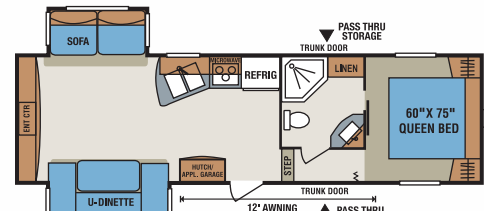

S265RE • UVW 7673 • Dry Hitch Wt. 1590 • NCC 2327 • Length 30'9"

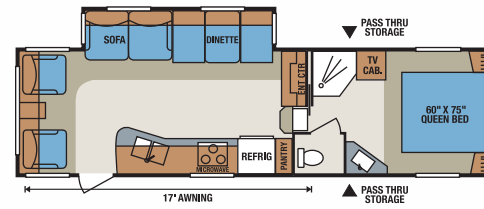

S285RL • UVW 7784 • Dry Hitch Wt. 1605 • NCC 3316 • Length 31'

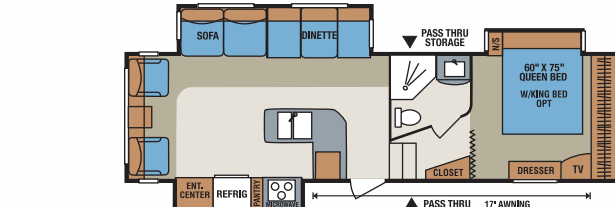

305KS3 • UVW 8665 • Dry Hitch Wt. 1815 • NCC 2536 • Length 32'5"

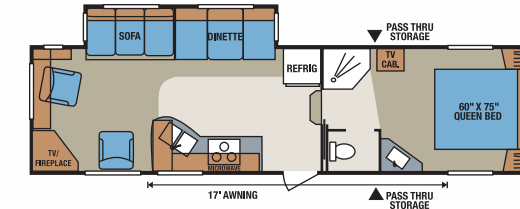

S305RE • UVW 8063 • Dry Hitch Wt. 1766 • NCC 3137 • Length 33'

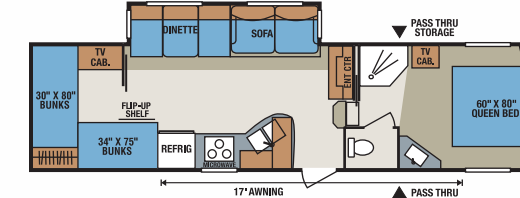

S315BH • UVW 8376 • Dry Hitch Wt. 1734 • NCC 2924 • Length 34'

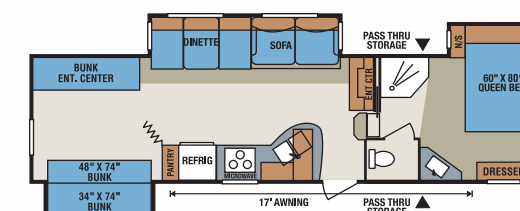

S325BH3 • UVW 9217 • Dry Hitch Wt. 1967 • NCC 2283 • Length 34'4"

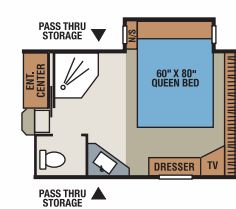

S285RL2 • UVW 7784 • Dry Hitch Wt. 1605 • NCC 3316 • Length 31'

Color Key:

- Carpet
- Cabinets
- Comfort Areas
- Countertops
- Linoleum

	Travel Trailers							FW
	S202LE	S202SLE	S242LE	S272LE	S280LE	S314LE	S318LE	S237LE
UVW (Unloaded Vehicle Wt.)	3458	3844	3952	4348	4916	5426	5540	6147
Dry Hitch Wt.	415	450	508	515	617	575	547	1397
Dry Axle Wt.	3043	3394	3444	3833	4299	4851	4993	4750
NCC (Net Carrier Capacity)	2542	2156	2048	1652	2084	1574	1460	1853
GVWR	6000	6000	6000	6000	7000	7000	7000	8000
Interior Height	78"	78"	78"	78"	78"	78"	78"	78"
Exterior Width	96"	96"	96"	96"	96"	96"	96"	96"
Exterior Length	21'11"	22'5"	26'6"	29'	29'10"	33'	31'11"	27'
Refrigerator (cu. feet)	5	5	5	5	5	5	5	5
Water Heater Cap. (gal.)	6	6	6	6	6	6	6	6
Fresh Water Cap. (gal.)	30	30	30	30	30	30	30	40
Waste Water Cap. (gal.)	32	32	32	32	32	32	32	50
Gray Water Cap. (gal.)	32	32	32	32	32	32	32	50
LP Gas Cap. (lbs.)	40	40	40	40	40	40	40	40
Furnace BTUs (1,000's)	16	16	16	20	20	20	20	20
Tire Size	14"	14"	14"	14"	14"	14"	14"	14"
Awning	14'	12'	15'	15'	14'	16'	16'	15'

Mandatory Living Package (FORCED OPTION)

- 5 Cu. Refer
- AM/FM/CD Player
- TV Antenna & Booster
- Acrylic Sink
- 6 Gallon Gas Water Heater
- Solid Oak Framed Mortise & Tenon Cabinet Doors
- 20 lb. Gas Bottles
- Wall Mount Systems Monitor Panel
- Storage Under Dinette Seats
- Fire Extinguisher
- Smoke Detector
- LP Detector
- Radius Trunk Door
- Tandem Axle w/4 Wheel Electric Brakes
- R7 Insulation
- Patio Door Light
- Awning Drip Rail & Drip Spouts
- Large Overhead Cabinets
- Built-in Medicine Cabinet w/Mirror in Bathroom
- Range Hood w/12V Light & Exhaust Fan
- Queen Bed
- 30 Amp Service
- Demand Water Pump
- 12V Converter w/Built-in Battery Charger
- 13,500 BTU A/C
- 3 Burner Cook Top
- Roof Vent in Bath
- Extra Thick .024 Mesa Metal
- 1pc. TPO Vinyl Roof
- Rear Bumper w/Sewer Hose Storage
- 14" Tires
- Awning
- Microwave w/Turn Table

Additional Options

- Outside Grill
- Spare Tire, Carrier & Cover
- Stabilizer Jacks
- Bottle Cover
- Bathroom Accessories
- Power Awning
- 6 Cu. Refrigerator

Sportsmen[®] LE Floor Plans

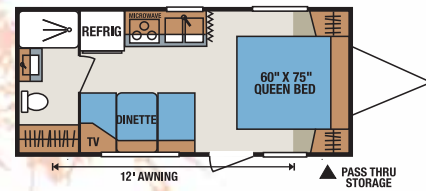

S202LE • UVW 3458 • Dry Hitch Wt. 415 • NCC 2542 • Length 21'11"

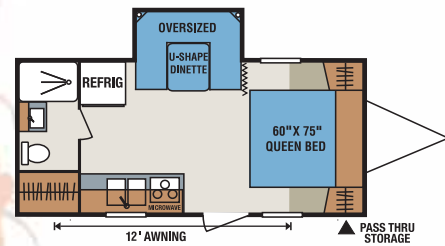

S202SLE • UVW 3844 • Dry Hitch Wt. 450 • NCC 2156 • Length 22'5"

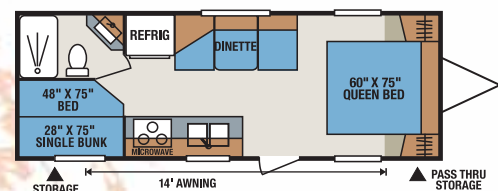

S242LE • UVW 3952 • Dry Hitch Wt. 508 • NCC 2048 • Length 26'6"

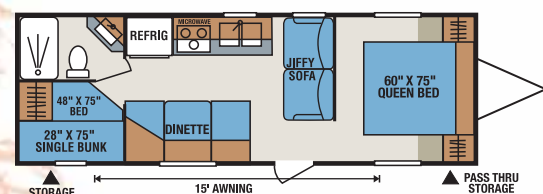

S272LE • UVW 4348 • Dry Hitch Wt. 515 • NCC 1652 • Length 29'

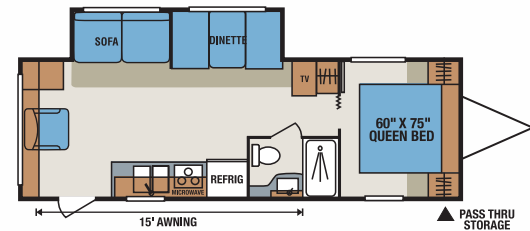

S280LE • UVW 4916 • Dry Hitch Wt. 617 • NCC 2084 • Length 29'10"

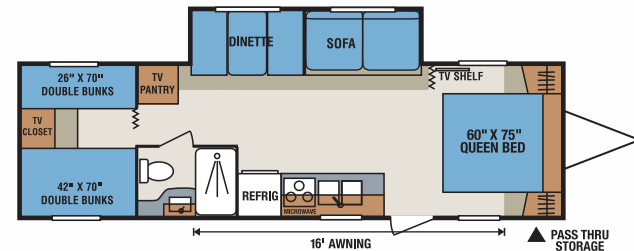

S314LE • UVW 5426 • Dry Hitch Wt. 575 • NCC 1574 • Length 33'

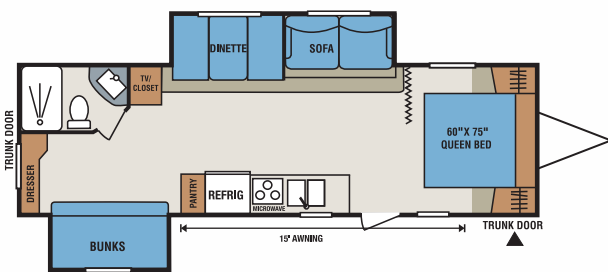

S318LE • UVW 5540 • Dry Hitch Wt. 547 • NCC 1460 • Length 31'11"

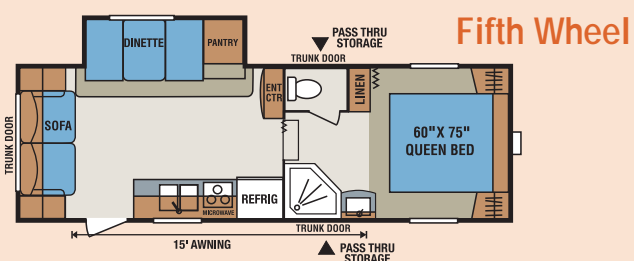

S237LE • UVW 6147 • Dry Hitch Wt. 1397 • NCC 1853 • Length 27'

Fifth Wheel

	S383BH2	S391FL2	S401BH3
UVW (Unloaded Vehicle Wt.)	9013	8797	9591
Dry Hitch Wt.	1121	1381	1289
Dry Axle Wt.	7892	7461	8302
NCC (Net Carrier Capacity)	2487	2703	1909
GVWR	11500	11500	11500
Interior Height	84"	84"	84"
Exterior Width	100"	100"	100"
Exterior Length	40'4"	41'5"	41'6"
Refrigerator (cu.)	18.2"	18.2"	18.2"
Water Heater Cap. (gal.)	10	10	10
Fresh Water Cap. (gal.)	40	40	40
Waste Water Cap. (gal.)	32	32	32
Gray Water Cap. (gal.)	32	32	32
LP Gas Cap. (lbs.)	60	60	60
Furnace BTUs (1000's)	40000	40000	40000
Tire Size	15"	15"	15"
Awning	20'	19'	19'

* DSI Water Heater

Park Trailer Model Floor Plans

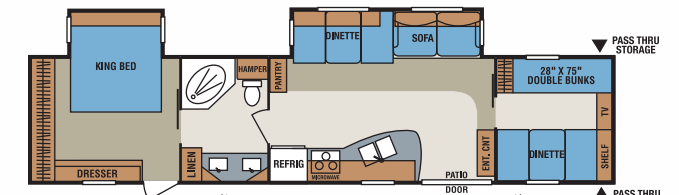

S383BH2 • UVW 9013 • Dry Hitch Wt. 1121 • NCC 2487 • Length 40'4"

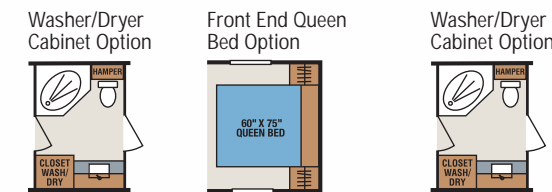

S391FL2 Bath Option

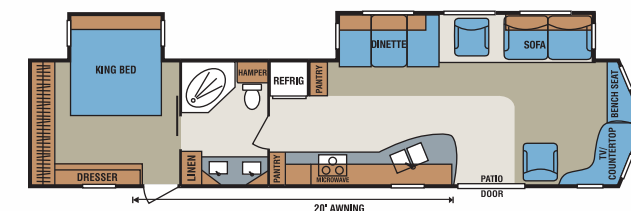

S383BH2 Bed & Bath Options

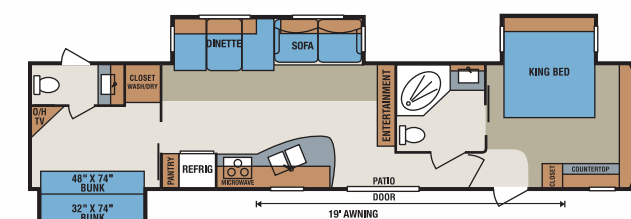

S391FL2 • UVW 8797 • Dry Hitch Wt. 1381 • NCC 2703 • Length 41'5"

S401BH3 • UVW 9591 • Dry Hitch Wt. 1289 • NCC 1909 • Length 41'6"

Sportsmen Mandatory Package (FORCED OPTION)

- 13,500 Ducted BTU A/C
- Awning
- Microwave w/Turn Table
- AM/FM Stereo w/DVD & 5.1 Surround Sound
- TV Antenna & Booster
- Exterior Shower
- Cable Hookup
- TV Shelf in Bedroom
- Night Shades
- Raised Panel Mortise & Tenon Overhead Cabinet Doors
- 30 lb. LP Gas Bottles w/Bottle Cover
- Winter By-Pass Kit
- Maple Color Cabinetry
- Bedspread
- Monitor Panel
- Power Vent in Bath
- Porch Light on ODS
- Hitch Light
- Straight Axles
- Tub Surround
- Sink Cover
- 15" Tires
- 4 Stabilizers Jacks
- 40 gal. Fresh Water Tank
- Bronze Mirror
- Tint Windows

Park Package (Forced Option)

- Free Standing Oven - 24"
- 110V House Type Refer
- 10 Gal Gas/Electric Water Heater
- Patio Door w/Vertical Blind
- Skylight Over Shower
- Atrium Front Profile
- Detachable Hitch
- Prep for A/C in Bedroom
- 40,000 BTU Furnace
- 50 Amp Service
- 84" Ceiling Height
- Garden Tub
- 80" Long Innerspring Mattress
- Assist Grab Handle
- Wall Mounted A/C T-stat
- Doors Under Dinette Seats

Additional Options Available

- Fiberglass Exterior
- 13,500 BTU A/C in Bedroom
- 15,000 BTU A/C
- 16 Gal. Gas/Elec. Water Heater
- 30" Entry Door IPO Patio Door
- 6 Cu. Double Door IPO House Type Refer
- Black Tank Flush
- Ceiling Fan
- Shur-Flo Fan w/Remote in LR
- Garden Tub w/Glass Swing Door
- Air Bed Hide-A-Bed
- Ladder
- LCD Flat Screen TV
- No Holding Tanks w/House Type Toilet
- Outside Grill
- Plumb for W/D with bath layout change
- Recliner
- Spare Tire, Carrier and Cover
- Table and 4 Chairs w/Leaf
- Pull Out Pantry

Two Distinctive Interior Selections

Desert Sand Décor



Sahara Décor





One **less** thing to **worry** about.

Worry-free protection against unexpected repairs for new or pre-owned travel trailers, fifth wheels and toy haulers

Comprehensive coverage

Professional claims administration with over 25 years of experience

Protection throughout the United States and Canada

Special coverages

24-hour roadside assistance benefits

Trip interruption benefits

Service call benefits

Administered by:

United Service Protection Corp. • **United Service Protection Inc. (in FL only)**
P.O. Box 20899, St. Petersburg, FL 33742-0899 • Toll-Free: 1-800-685-3034
Florida License #60016000 • © Assurant, Inc. 2008

2X2 WARRANTY – The KZ Recreational Vehicles 2x2 Warranty is a manufacturer's warranty. Each KZ product is warranted to the original purchaser for twenty-four (24) months from the original date of purchase. Coverage includes appliances, components, construction and FULL structure. The appliances and other amenities are warranted by the individual manufacturers of those components, not KZ. Our warranty is also transferable within the first two (2) years for a small processing fee. For a copy of the warranty with full terms and conditions, ask your local KZ Dealer or visit our web site at <http://www.kz-rv.com>.

VEHICLE LOADING – Every effort has been made to provide the greatest number of options for the recreation vehicle owner. Each owner is responsible to select loads allowing the recreational vehicle to remain within the manufacturer's specified chassis weight limits. Do not overload the recreational vehicle.

UNLOADED VEHICLE WEIGHT (UVW) – The typical weight of this trailer as built at the factory. The UVW does not include cargo, LP gas, fresh water, options or dealer-installed accessories.

GROSS VEHICLE WEIGHT RATING (GVWR) – The maximum permissible weight of the trailer, including the UVW plus passengers, all cargo, personal items, fluids, options and dealer-installed accessories. The GVWR is equal to or greater than the sum of the UVW and the NCC.

NET CARRYING CAPACITY (NCC) – The maximum weight of all passengers, personal items, fresh water, food, tools, LP gas, other cargo and dealer-installed accessories* that can be carried by the trailer. NCC is equal to or less than GVWR minus UVW.

* The addition of options will decrease the NCC.

It is important for your safety and enjoyment that your tow vehicle be adequately sized and equipped to tow and handle the GVWR of the RV you select. Review weights and rating of your tow vehicle and consult a competent advisor for questions or advice. Whether you are new to RVing or a seasoned veteran, get a feel for the performance of your tow vehicle and the RV together before heading out on the roadways. When you tow an RV, you must drive differently than you do when driving a single vehicle. Practice hooking up, driving, backing up and braking in a safe environment or seek out professional instruction.

See specification chart. KZ affixes a weight label to each new RV which lists weight information for that vehicle.

NOTE: This information is intended as a guide only. Weights of individual vehicles are approximate. Consult your Owner's Manual for complete loading, weighing and towing instructions. All weights may vary.



0985 N 900 W • Shipshewana, IN 46565
E-Mail kz@kz-rv.com • www.kz-rv.com

Due to continual research and advances, manufacturer reserves the right to change specifications, design, price and equipment without notice, and assumes no responsibility for any error in this literature. Some items shown are not included as standard or optional equipment.
©2009KZ

1/15/09 25M



Dealer: