

FLOORPLANS

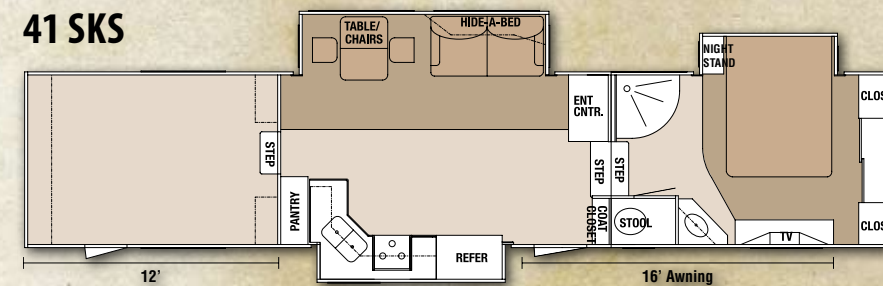
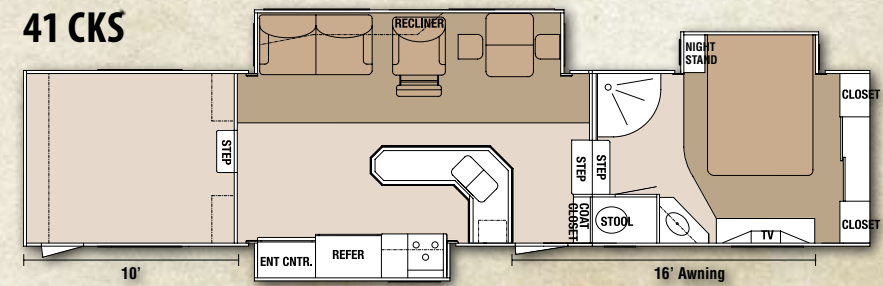

ESCALADE SPORTSTER	41 CKS	41 SKS
UVW* (Unloaded Vehicle Weight)	15645	TBD
Dry Hitch Weight	3305	TBD
Dry Axle Weight	12340	TBD
NCC (Net Carrying Capacity)	4355	TBD
GVWR	20000	20000
Interior Height	93"	93"
Exterior Width	102"	102"
Exterior Length	42'	42' 8"
Exterior Height	155"	155"
Fresh Water Capacity (gal)	110	110
Waste Water Capacity (gal)	50	50
Grey Water Capacity (gal)	88	88
Tire Size (G-Rated)	LT235-85R16	LT235-85R16
Axle Rating	3 (7000)	3 (7000)

*Does Not Include Additional Options

Paint match slide-outs included with available full body paint package



Feel the music with the available Sony® Xplod sound system.



Easy to fill propane bottles on our custom swivel-out tray



Heavy-duty 7000# axles include MOR/ryde suspension and G-Rated Tires



Easy access to control center for quick hook-ups.



The finished basement provides a large pass-through storage area.



Cherry cabinetry shown.



The fuel station lets you gas up your toys, eliminating the need to haul bulky gas cans.



0985 North 900 West | Shipshewana, IN | 46565
Ph: 260-768-4016 | www.kz-rv.com

Due to continual research and advances, manufacturer reserves the right to change specifications, design, price and equipment without notice, and assumes no responsibility for any error in this literature. Some items shown are not included as standard or optional equipment.

ASK YOUR DEALER ABOUT OUR LIMITED 2-YEAR WARRANTY



Standard partial paint package

K-100-290



PURSUE YOUR PASSION





LIVING ROOM

Quality residential furnishings blend with exquisite styling to create a beautifully livable interior. It's the details that propel the Escalade Sportster into a league of its own.



41 CKS shown with Sable decor and Glazed Maple cabinetry.



KITCHEN

High gloss Corian® countertops enhance the richness of the solid wood maple cabinetry in this kitchen flanked by a state-of-the-art entertainment center. Shown with optional water dispenser and fireplace.



BEDROOM

A large corner shower with sliding glass door and overhead tinted skylight is standard in all floor plans. The plush bedroom features a comfortable queen size bed with pillow top mattress and designer furnishings.



INTERIOR

INTERIOR FEATURES

- Solid Cherry or Glazed Maple Wood Choices
- All Cabinets Pre-Drilled and Screwed with Hidden European Style Hinges
- High Gloss Corian® Countertops/Kitchen and Lavatory
- Stainless Steel Recessed Sink with Covers in Kitchen
- Day/Night Shades
- Soft Touch Padded Ceiling
- Mirrored Entry Closet with Grandfather Clock
- Upgraded Window Treatments with Fabric and Wood Features
- Solid Wood Interior Assist Handle
- Waste Basket Accommodations in all Kitchens
- Designer Inspired Bedding with Deluxe Bedsread and Pillow Shams
- Brushed Nickel Cabinet Hardware
- Ball Bearing Full Extension Drawer Guides
- Solid Wood 6 Panel Commode Room and Living Area Door
- Corian® Bi-Fold Range Cover/Flush Mounted
- Solid Wood Crown Molding
- Solid Wood Vanity and Medicine Cabinet in Bath Area

APPLIANCES AND ELECTRONICS

- 12 Cu. Ft. Side x Side Refrigerator with Stainless Steel Front
- 30" Residential Stainless High Line Over the Range Microwave
- Pre-Wired for Satellite System
- 32" Sony® LCD HDTV in Living Area
- Sony® Stackable Stereo with Full Surround Sound System
- Sony® DVD Changer
- 22" Broiler Oven with Stainless Steel Front and 3-Burner Cook Top
- 19" LCD TV in Bedroom
- Dirt Devil® Central Vacuum with Built-In Dust Pan
- Full Featured Video Switching Control Center with Signal Amp.
- TV Antenna
- 2 Bedroom Speakers with On/Off Switch

FURNITURE

- Residential Style Hide-a- Bed Sofa by Williamsburg
- "Flex Comfort" Bed Spring
- 80" Pillow Top Mattress
- Freestanding Dining Room Table with Fold-Up Leaf, Tilt-Up Storage and Silverware Drawer
- Two High Back Solid Wood Dining Chairs and Two Folding Solid Wood Dining Chairs

ELECTRICAL

- Back-Lit Switches at Entry Door
- Overhead Ceiling Fan
- Convenient Electrical Command Center
- Fluorescent Lighting in Living Areas
- Halogen Accent Lighting with Dimmer
- Power Eclipse Awning
- 50 AMP Power Service with Detachable Cord
- 65 AMP Power Converter
- Recessed Entry Step Light
- Porch Light
- Telephone Jack at Recliners and Entertainment Area
- Designer Accent Light Package
- LED Running/Brake/Turn Signals
- High Output Back-Up Lights
- 4 Exterior Security Lights
- 12 Volt Deep Cycle Battery
- 120 Volt Exterior Outlet
- Hitch Light
- 12 Volt Battery Disconnect

HEAT/VENTILATION AC

- 15,000 Low Profile AC
- 42,000 BTU Furnace
- Preparation for 2nd AC in Bedroom
- (3) Fantastic Thermostat Controlled Ventilation Fans with Rain Sensor
- In Floor Ducted Heat System
- Solid Wood Furnace Return Air Cover
- Ducted AC Supply and Return

PLUMBING SYSTEM

- Large One Piece Fiberglass Corner Shower with Self Storing Shower Door
- Porcelain Toilet with Sprayer
- (16) Gallon Gas/Electric Hot Water Heater
- Black Tank Flush System
- Heated Fresh, Grey, and Black Water Tanks
- Exterior "Hook-Up" Center with Cable, Water and Phone Connections Along with an Exterior Shower.
- Winterization Package

STANDARD EQUIPMENT

DECOR OPTIONS



SABLE



CABERNET



CASHMERE

EXTERIOR

BODY AND FRAME CONSTRUCTION

- All Aluminum Double Welded Cage Frame
- Gel Coat High Gloss Fiberglass Exterior Sidewalls
- Premium Quality Painted Exterior Graphics
- 8 Lug HD Aluminum Wheels
- Roof Ladder
- (2) 40 lb. LP Bottles
- Tinted Skylight at Shower Area
- 18" "Box" beam/"I" Beam Stack Chassis
- 16" G-Rated Tires
- G-Rated Spare Tire with Hoist
- Independent Power Front Jacks with Snap Pins
- Power Rear Stabilizer System
- 7,000 lb. Axles with Easy Lube Hubs
- MOR/ryde Suspension System
- Fold-Out Entry Grab Handle
- 30" Entry Door
- 5/8 Tongue and Groove Plywood Floor Decking
- Extended Pin Box
- Fully Enclosed Underbelly
- Tinted Windows with Safety Glass
- 1/2" Plywood Roof Decking
- Fiberglass Front Cap
- Pass-Through "Basement" Storage

ADDITIONAL OPTIONS

- Fireplace
- 2nd 13.5 A/C in Bedroom
- 3rd 13.5 A/C in Cargo Area
- Heat Pump Upgrade
- Convection Microwave
- Ice Maker with Water Dispenser in Door
- King Size Bed
- Infinity Ceiling Light
- Door Bell
- CSA (Canadian Required)
- Onan 5.5 Generator
- Disc Brakes
- Thermo-Pane Windows
- Automatic Satellite
- 5th Airborne Hitch
- Slide Out Covers
- Wind Sensor
- Roll Out Tray
- 2nd Battery
- Full Body Paint Package
- Sony® Xplod Cargo Area Sound System

MANDATORY SPORTSTER PACKAGE

- Fuel Cell with Pump Station
- Generator Prep
- 2nd Entrance Door in Cargo Area
- Tuff-Ply® on Cargo Floor
- 2' Diamond Plate on Sidewalls
- Ramp Extension
- Threshold Ramp
- 3 Tie Down Rails
- Pull Down Screen Wall
- Battery Charger/Power Pack/Air Compressor
- Bedroom Loft
- Fiberglass Rear Cap