

# FRONTIER™

by K-Z

Travel Trailers  
& Fifth Wheels



Go Ahead,  
Explore a  
new Frontier...



# Frontier™

2802PF shown with Foliage décor

Built upon 34 years of RV experience, K-Z products have earned a time-tested record of excellence.

Whether for a family or a retired couple, these Frontier™ models all share the proven virtues of laminated sidewall construction resulting in light weight strength and efficient functional designs.

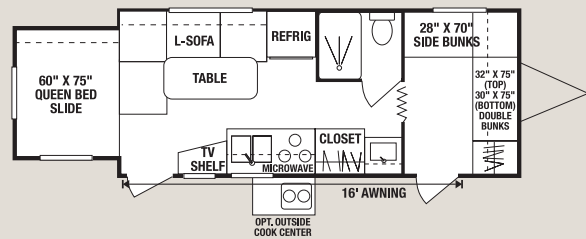

**2205QS-F** · UVW 4160 · Dry Hitch Wt. 410 · NCC 1352 · Length 23'

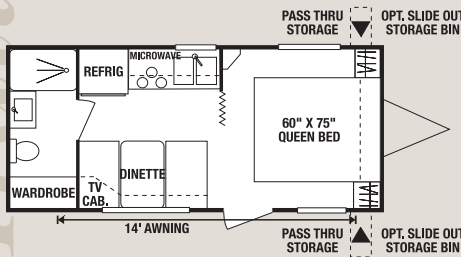

**2003F** · UVW 3500 · Dry Hitch Wt. 380 · NCC 2012 · Length 21'6"

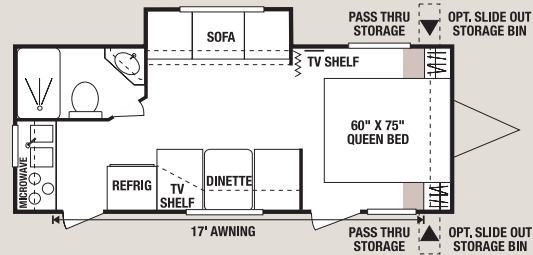

**2303P-F** · UVW 4670 · Dry Hitch Wt. 490 · NCC 2330 · Length 25'2"

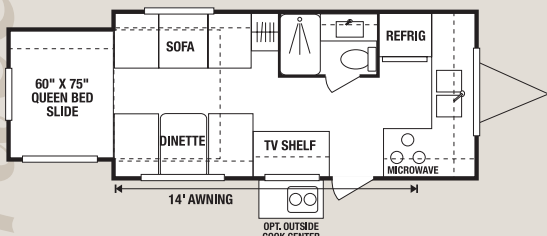

**2101QS-F** · UVW 4100 · Dry Hitch Wt. 500 · NCC 1412 · Length 22'4"

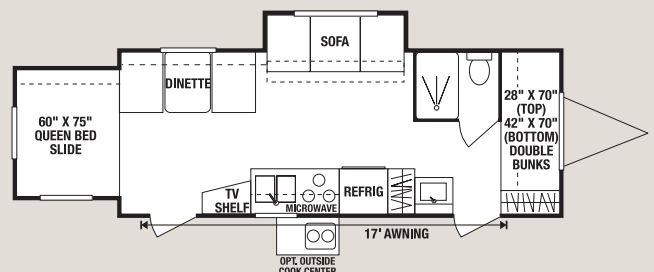

**2405PQS-F** · UVW 5300 · Dry Hitch Wt. 480 · NCC 1700 · Length 25'5"

Travel Trailers



always the  
**Best Buy for  
the Dollar.**

Greater floor space created by this dinette/sofa side slide out is sure to please, as well as large storage drawers under the convertible dinette seating. A fold-out sleeper sofa has a convenient side shelf and recessed open storage compartment. Enjoy bed-time privacy by closing the easy glide screen. Relax in the queen size bed featuring dual side mirrored wardrobes and overhead storage.

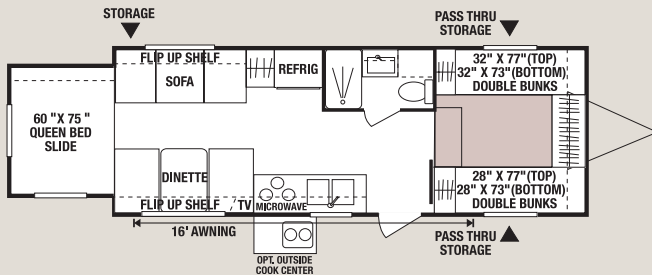

**2505QSS-F** · UVW 5380 · Dry Hitch Wt. 620 · NCC 1620 · Length 26'3"

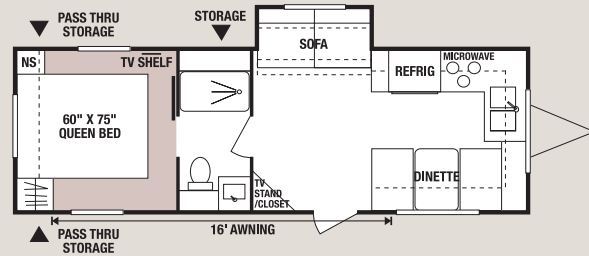

**2803P-F** · UVW 5260 · Dry Hitch Wt. 860 · NCC 1740 · Length 29'

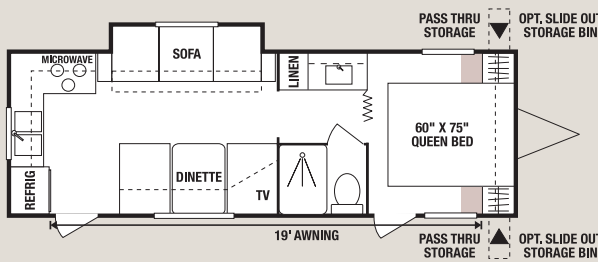

**2605P-F** · UVW 5080 · Dry Hitch Wt. 490 · NCC 1920 · Length 27'4"

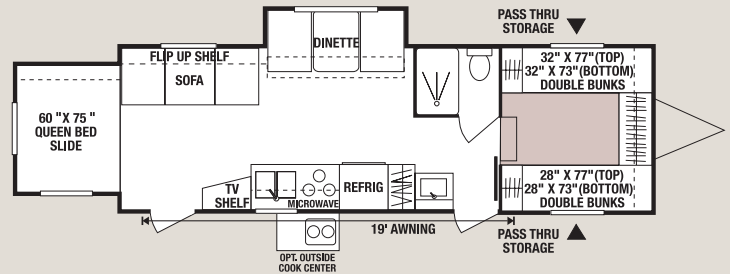

**2809PQS-F** · UVW 5540 · Dry Hitch Wt. 560 · NCC 1460 · Length 28'7"

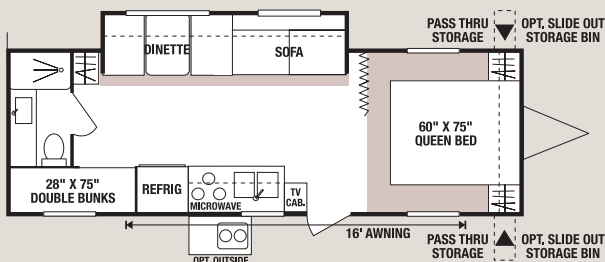

**2802P-F** · UVW 5350 · Dry Hitch Wt. 570 · NCC 1650 · Length 29'

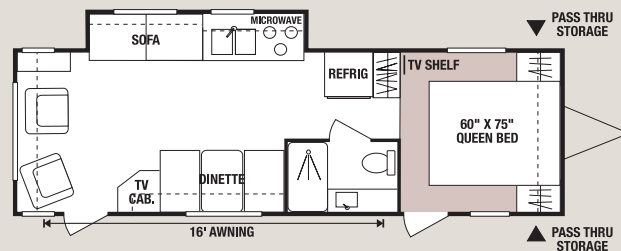

**2901P-F** · UVW 5570 · Dry Hitch Wt. 730 · NCC 1430 · Length 30'11"



This bath is big on design with all the features you'll need.



The kitchen features raised oak panel doors with brushed nickel cabinet hardware, deluxe roller drawer guides, a 6 cubit foot capacity refrigerator, microwave, oven/stove top with cover and more.

The kids can bed down in double bunks complete with a privacy curtain.

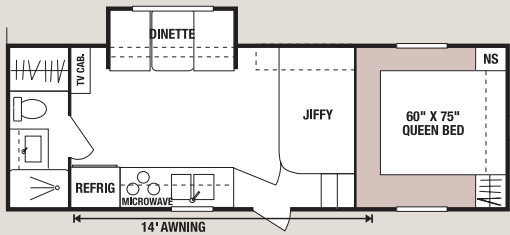

**2251P-F** • UVW 5600 • Dry Hitch Wt. 880 • NCC 1400 • Length 24'3"

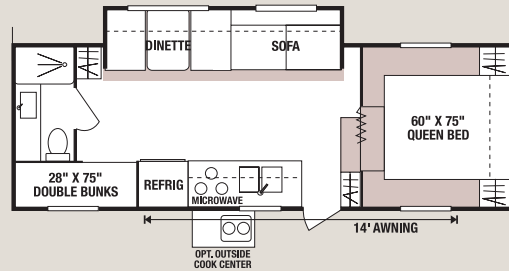

**2453P-F** • UVW 6090 • Dry Hitch Wt. 1400 • NCC 1910 • Length 26'10"

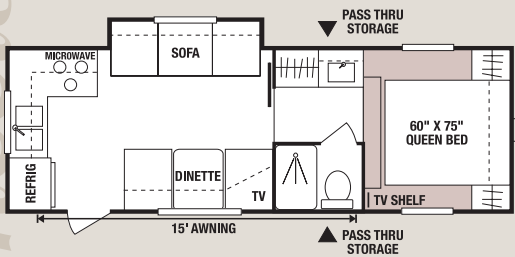

**2352P-F** • UVW 5530 • Dry Hitch Wt. 900 • NCC 1470 • Length 24'9"

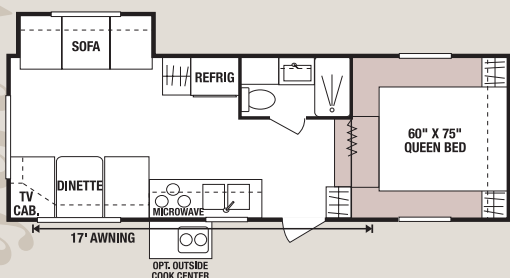

**2353P-F** • UVW 5460 • Dry Hitch Wt. 1100 • NCC 1540 • Length 25'1"



Exclusive K-Z design, Patented Manual Easy Rear Slide Queen Bed available on selected model Travel Trailers.

# Features

- A** Fiberglass Front End Cap with Gas Bottle Cover
- B** Outside Cooktop
- C** Exterior Shower
- D** 13,500 BTU Air Conditioner
- E** Radius Windows



*Choose from K-Z's complete line of Travel Trailers and Fifth Wheels - there's a size and model that's just right for you.*



An innovative leader in RV design and development, K-Z's desire is to engineer affordable, high-value products that deliver customer satisfaction year after year.

See for yourself why K-Z has been awarded the Dealer Satisfaction Index five years in a row.



## Décor options

*Amber*



*Foliage*



*Sienna*



	2003-F	2101QS-F	2205QS-F	2303P-F	2405PQS-F	2505QSS-F	2605P-F	2802P-F	2803P-F	2809PQS-F	2901P-F	2251P-F	2352P-F	2353P-F	2453P-F
<b>UVW (Unloaded Vehicle Wt.)</b>	3500	4100	4160	4670	5300	5380	5080	5350	5260	5540	5570	5600	5530	5460	6090
<b>Dry Hitch Wt.</b>	380	500	410	490	480	620	490	570	860	560	730	880	900	1100	1400
<b>Dry Axle Wt.</b>	3120	3600	3750	4180	4820	4760	4590	4780	4400	4980	4840	4720	4630	4360	4690
<b>NCC (Net Carrier Capacity)</b>	2012	1412	1352	2330	1700	1620	1920	1650	1740	1460	1430	1400	1470	1540	1910
<b>GVWR</b>	5512	5512	5512	7000	7000	7000	7000	7000	7000	7000	7000	7000	7000	7000	8000
<b>Interior Height</b>	78"	78"	78"	78"	78"	78"	78"	78"	78"	78"	78"	82"	82"	82"	82"
<b>Exterior Height (w/ A/C)</b>	121"	121"	121"	121"	121"	121"	121"	121"	121"	121"	121"	132"	132"	132"	132"
<b>Exterior Width</b>	96"	96"	96"	96"	96"	96"	96"	96"	96"	96"	96"	96"	96"	96"	96"
<b>Exterior Length</b>	21'6"	22'4"	23'	25'2"	25'5"	26'3"	27'4"	29'	29'	28'7"	30'11"	24'3"	24'9"	25'1"	26'10"
<b>Refrigerator</b>	6	6	6	6	6	6	6	6	6	6	6	6	6	6	6
<b>Water Heater Cap. (gal.)</b>	6	6	6	6	6	6	6	6	6	6	6	6	6	6	6
<b>Fresh Water Cap. (gal.)</b>	40	40	40	40	40	40	40	40	40	40	40	40	40	40	40
<b>Waste Water Cap. (gal.)</b>	32	32	32	32	32	32	32	32	32	32	32	32	32	32	32
<b>Gray Water Cap. (gal.)</b>	32	32	32	32	32	32	32	32	32	32	32	32	32	32	32
<b>LPG Gas Cap. (gal.)</b>	30	30	30	30	30	30	30	30	30	30	30	30	30	30	30
<b>Furnace BTU's (1000's)</b>	16	20	20	20	20	20	20	25	25	25	25	20	20	20	25
<b>Tire Size</b>	14"	14"	14"	14"	14"	14"	14"	14"	14"	14"	14"	15"	15"	15"	15"
<b>Awning Size</b>	14'	14'	16'	17'	17'	16'	19'	17'	20'	19'	16'	14'	15'	17'	14'

## STANDARD LIVING PACKAGE

- 13,500 BTU Ducted A/C
- Awning
- Microwave \*
- 6 cu' Refrigerator
- Oven
- Stove Cover
- AM-FM Stereo w/CD Player
- Acrylic Sink w/High Rise Faucet
- Outside Cooktop or Outside Grill \*
- Double Step
- TV Antenna w/Booster
- Cable Hook Up
- TV Shelf in Bedroom
- Night Shades \*
- 2 Sink Covers
- Deluxe Roller Drawer Guides
- 30# Gas Bottles
- Exterior Shower
- SkyLight Over Tub & Tub Surround
- Pillows for Sofa \*
- Brushed Nickel Faucets
- Brushed Nickel Cabinet Hardware
- Fluorescent Light Over Kitchen Sink
- Bathroom Accessories
- Porch Light on ODS & Hitch Light
- Chrome Rings & Caps
- 40 gal. Fresh Water Tank
- Smoke Detector
- LP Detector
- Raised Oak Mortise & Tenon Overhead Cabinet Doors
- 6 gal. Gas/Electric DSI Water Heater w/Winter By-Pass Kit
- Straight Axles
- Shower Door

\* Where applicable and codes allow. Note: Some standard features may be cancelled or altered at dealer's request.

## ADDITIONAL OPTIONS AVAILABLE

- Fantastic Vent
- Foot Flush Toilet
- Assist Grab Handle
- Battery and Box
- Tinted/Safety Windows
- Spare Tire
- Spare Tire Carrier
- Spare Tire Cover
- 15" Tires
- Chrome Bumper Cover
- Power Jack
- Stabilizer Jacks (2 or 4)

**2X2 WARRANTY** – The K-Z 2x2 Warranty is a manufacturer's warranty. Each K-Z product is warranted to the original purchaser for twenty-four (24) months from the original date of purchase. Coverage includes appliances, components, construction and FULL structure. Our warranty is also transferable within the first two (2) years for a small processing fee. For a copy of the warranty with full terms and conditions, ask your local K-Z Dealer or visit our web site at <http://www.kz-rv.com>.

**VEHICLE LOADING** – Every effort has been made to provide the greatest number of options for the recreational owner. Each owner is responsible to select loads allowing the recreational vehicle to remain within the manufacturer's specified chassis weight limits. Do not overload the recreational vehicle.

**UNLOADED VEHICLE WEIGHT (UVW)** – The typical weight of this trailer as built at the factory. The UVW does not include cargo, LP gas, fresh water, options or dealer-installed accessories.

**GROSS VEHICLE WEIGHT RATING (GVWR)** – The maximum permissible weight of the trailer, including the UVW plus passengers, all cargo, personal items, fluids, options and dealer-installed accessories. The GVRW is equal to or greater than the sum of the UVW and the NCC.

**NET CARRYING CAPACITY (NCC)** – The maximum weight of all passengers, personal items, fresh water, food, tools, LP gas, other cargo and dealer-installed accessories\* that can be carried by the trailer. NCC is equal to or less than GVWR minus UVW.

\* The addition of options will decrease the NCC.

It is important for your safety and enjoyment that your tow vehicle be adequately sized and equipped to tow and handle the GVWR of the RV you select. Review weights and rating of your tow vehicle and consult a competent advisor for questions or advice. Whether you are new to RVing or a seasoned veteran, get a feel for the performance of your tow vehicle and the RV together before heading out on the roadways. When you tow an RV, you must drive differently than you do when driving a single vehicle. Practice hooking up, driving, backing up and braking in a safe environment or seek out professional instruction.

See specification chart above. K-Z affixes a weight label to each new RV which lists weight information for that vehicle.

**NOTE:** This information is intended as a guide only. Weights of individual vehicles are approximate. Consult your Owner's Manual for complete loading, weighing and towing instructions. All weights may vary.

Awarded to K-Z  
Five Years in a Row!



Dealer:



K-Z • 9270 West U.S. 20 • Shipshewana, IN 46565  
E-Mail [kz@kz-rv.com](mailto:kz@kz-rv.com) • [www.kz-rv.com](http://www.kz-rv.com)

