



RECREATIONAL
VEHICLES

VENOM

LUXURY TOY HAULERS



The KZ **True 2 Warranty** is a **2-year hitch-to-bumper limited warranty** that's true to its name. The gold standard in RV protection, True 2 provides double the coverage of the industry norm. Plus, our warranty is backed by the craftsmanship and quality we're known for, so you can Go. Camp. Live. Wherever your adventure takes you, know that you're covered in your KZ.



2021 VENOM TOY HAULERS

4113TK | Barista décor



2021 DÉCOR

BARISTA

COBBLESTONE

| Venom Fifth Wheel Toy Haulers | 3911TK | 4013TK | 4113TK | 4114TK |
|--|--------|--------|--------|--------|
| UVW (Unloaded Vehicle Weight)* | 14,690 | 14,930 | 14,450 | 14,710 |
| Dry Hitch Weight* | 3,140 | 3,160 | 3,220 | 3,230 |
| Dry Axle Weight* | 11,550 | 11,770 | 11,230 | 11,480 |
| CCC (Cargo Carrying Capacity) | 4,310 | 4,070 | 4,550 | 4,290 |
| GVWR | 19,000 | 19,000 | 19,000 | 19,000 |
| Interior Height | 102" | 102" | 102" | 102" |
| Exterior Height w/ A/C | 13' 4" | 13' 4" | 13' 4" | 13' 4" |
| Exterior Width | 101" | 101" | 101" | 101" |
| Exterior Length** | 42' 8" | 43' 6" | 43' 7" | 43' 5" |
| Refrigerator (cu. feet) | 18 | 18 | 18 | 18 |
| Water Heater Cap. (on-demand tankless) | *** | *** | *** | *** |
| Fresh Water Cap. (gal.) | 100 | 100 | 100 | 100 |
| Waste Water Cap. (gal.) | 53 | 73 | 53 | 53 |
| Gray Water Cap. (gal.) | 93 | 93 | 93 | 93 |
| 1/2 Bath Cap. (gal.) | N/A | TBD | N/A | N/A |
| LP Gas Cap. (lbs.) | 60 | 60 | 60 | 60 |
| Furnace BTUs (1,000s) | 40 | 40 | 40 | 40 |
| Tire Size | 16" | 16" | 16" | 16" |
| Awning | 17' | 16' | 14' | 14' |
| Optional 2nd Awning | 11' | 11' | 11' | 15' |

*This weight reflects the rolling average unit weight for each model. Your trailer weight will vary according to optional equipment.

**Exterior length is measured from rear of bumper to center of coupler.

***Infinite supply.

2021 VENOM V-SERIES TOY HAULERS

V3916TK | Cobblestone décor



2021 DÉCOR

BARISTA

COBBLESTONE



Venom V-Series Fifth Wheel Toy Haulers

| | V3313TK | V3413TK | V3815TK | V3916TK |
|--|---------|---------|---------|---------|
| UVW (Unloaded Vehicle Weight)* | 12,810 | 12,740 | 13,470 | 13,340 |
| Dry Hitch Weight* | 2,150 | 2,210 | 2,450 | 2,720 |
| Dry Axle Weight* | 10,660 | 10,530 | 11,020 | 10,620 |
| CCC (Cargo Carrying Capacity) | 3,190 | 3,260 | 4,530 | 4,660 |
| GVWR | 16,000 | 16,000 | 18,000 | 18,000 |
| Interior Height | 102" | 102" | 102" | 102" |
| Exterior Height w/ A/C | 13' 4" | 13' 4" | 13' 4" | 13' 4" |
| Exterior Width | 101" | 101" | 101" | 101" |
| Exterior Length** | 40' 10" | 40' 11" | 42' 10" | 43' 8" |
| Refrigerator (cu. feet) | 12 | 12 | 12 | 12 |
| Water Heater Cap. (on-demand tankless) | *** | *** | *** | *** |
| Fresh Water Cap. (gal.) | 100 | 100 | 100 | 100 |
| Waste Water Cap. (gal.) | 93 | 53 | 93 | 53 |
| Gray Water Cap. (gal.) | 53 | 93 | 53 | 93 |
| 1/2 Bath Cap. (gal.) | TBD | N/A | 40 | N/A |
| LP Gas Cap. (lbs.) | 60 | 60 | 60 | 60 |
| Furnace BTUs (1,000s) | 35 | 35 | 35 | 35 |
| Tire Size | 16" | 16" | 16" | 16" |
| Awning | 14' | 14' | 14' | 14' |
| Optional 2nd Awning | 12' | 12' | 14' | 15' |

*This weight reflects the rolling average unit weight for each model. Your trailer weight will vary according to optional equipment.

**Exterior length is measured from rear of bumper to center of coupler.

***Infinite supply.

2021 VENOM V-SERIES TOY HAULERS

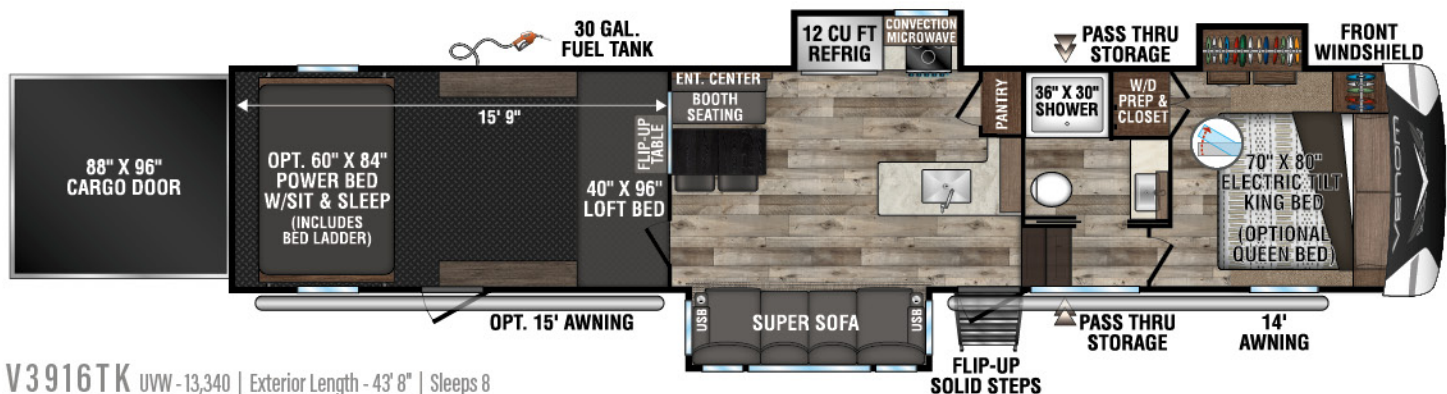
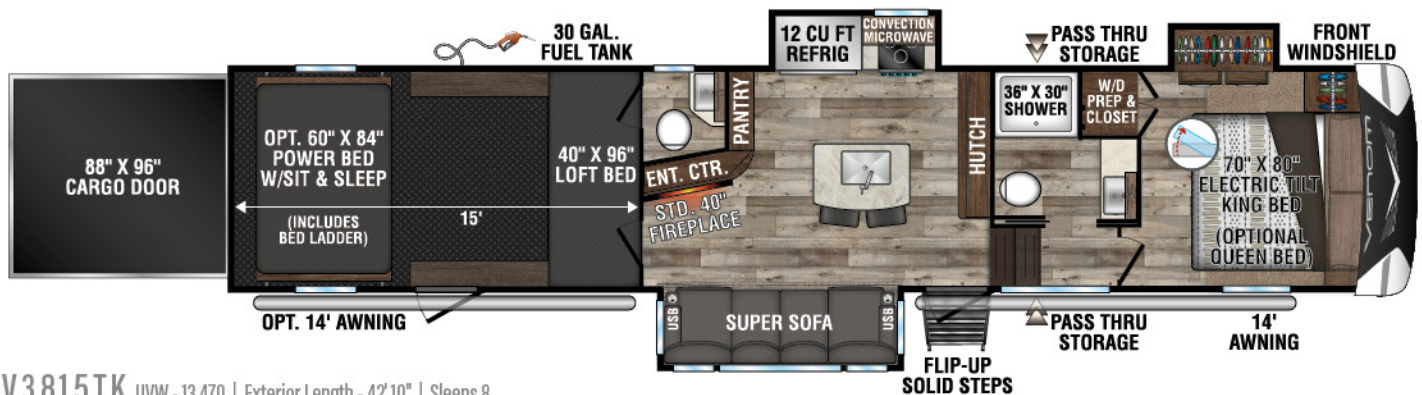
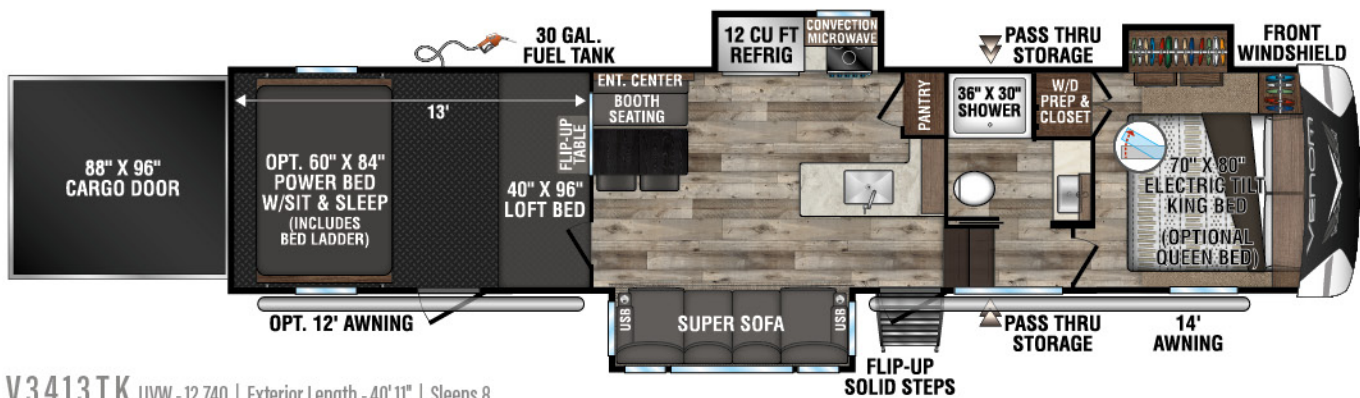
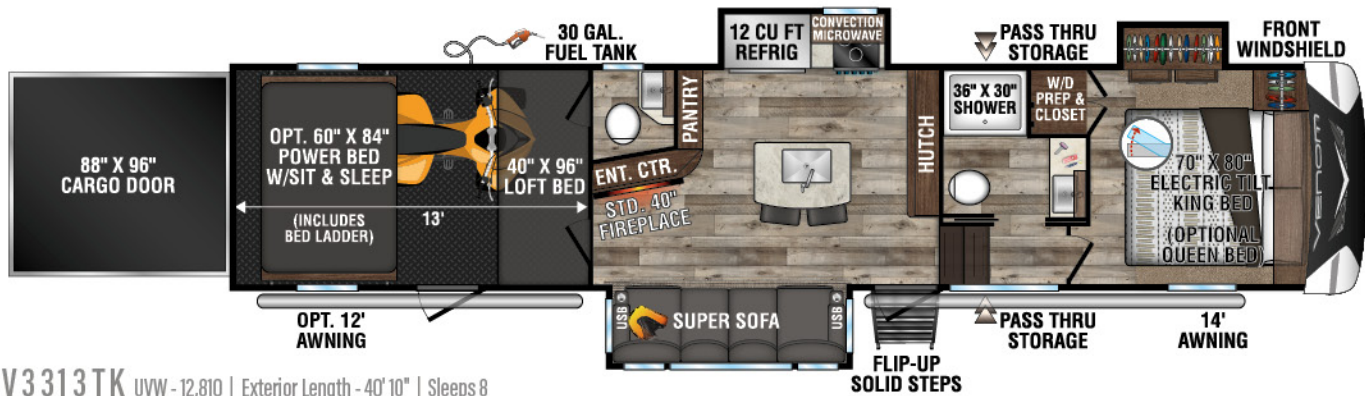

2021 VENOM TOY HAULERS

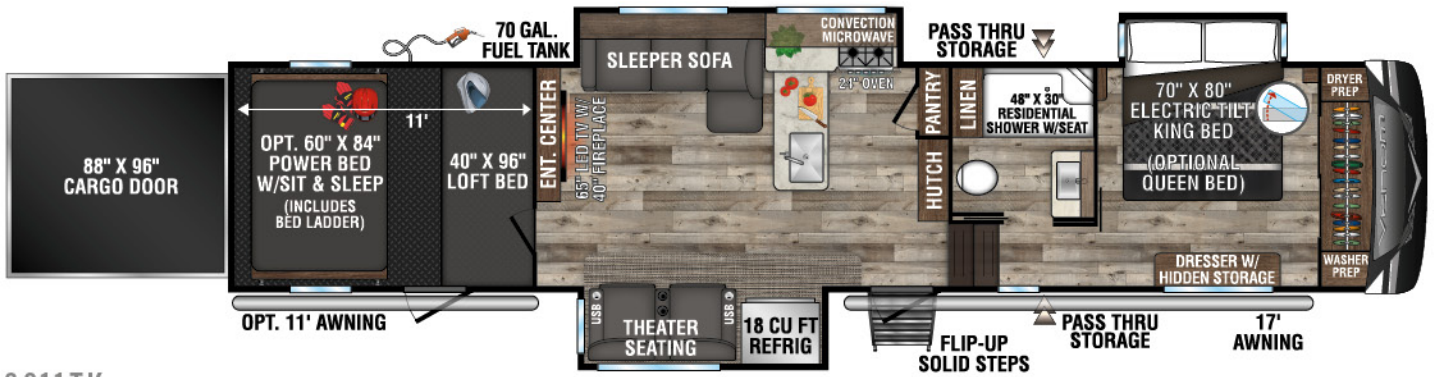

3911TK UVW - 14,690 | Exterior Length - 42' 8" | Sleeps 9

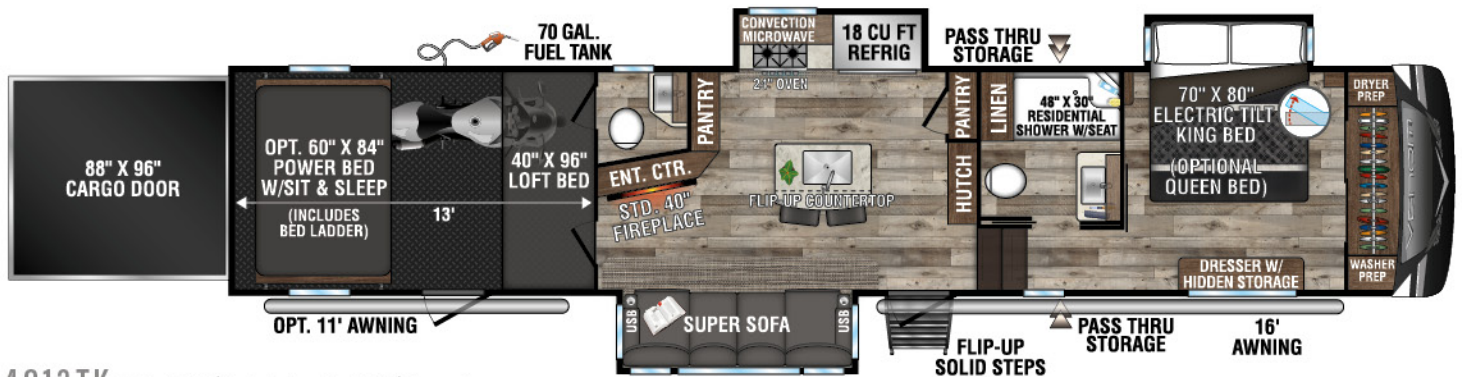

4013TK UVW - 14,930 | Exterior Length - 43' 6" | Sleeps 8

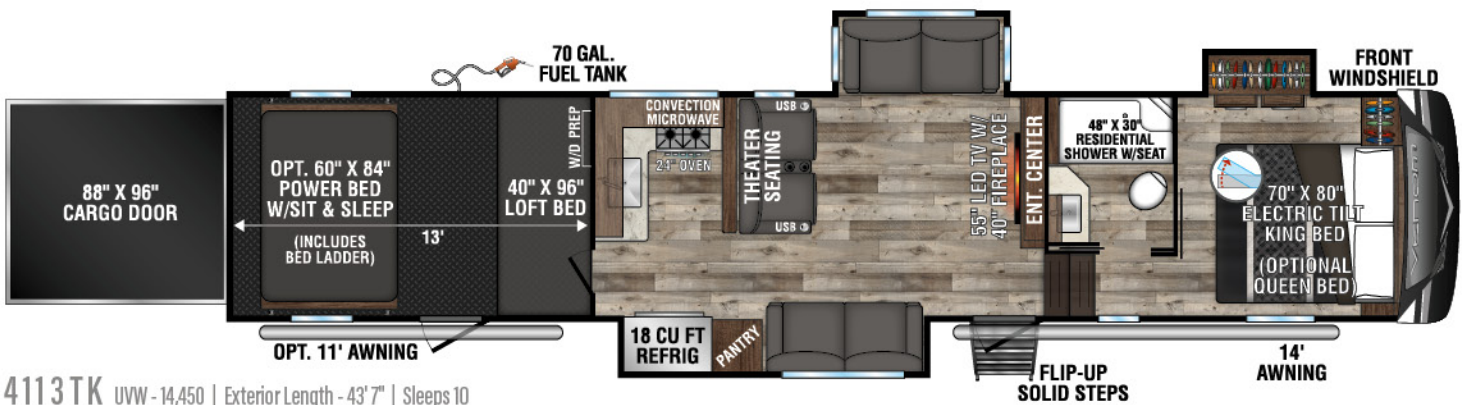

4113TK UVW - 14,450 | Exterior Length - 43' 7" | Sleeps 10



4114TK UVW - 14,710 | Exterior Length - 43' 5" | Sleeps 9

2021 VENOM V-SERIES & VENOM FEATURES



Two attic vents are in each RV, providing vital escape routes for unwanted moisture that accumulates during use.



E-TRACK universal track system with different fittings that allow you to quickly snap in and secure your load.

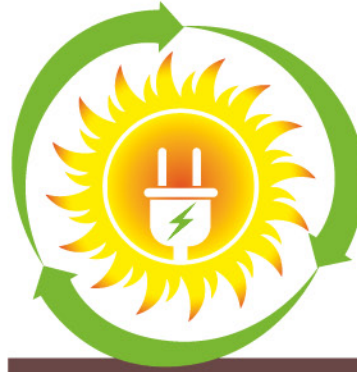

Harness the power of the sun to run your TV and outlets. Roof-mounted solar prep standard. **Optional "Off the Grid" solar package** by Xantrex (220W solar panel, 30A MPPT solar charge controller w/MPPT remote panel, 2,000W true sine wave inverter w/all outlets "hot").



LITHIUM-READY CHARGING STATION includes a dual converter, which allows you to choose between lithium or lead batteries with the flip of a switch!

Heated, insulated & enclosed underbelly plus foil in floor, roof, front, rear! R-11 sidewalls, R-38 roof and floor.



PUMP STATION (Venom only, shown) allows easy access to the 40-gallon tank. **GENERATOR PREP** includes a dedicated 30-gallon tank.



QUICKLY TRANSFORM the garage from hauling your toys into a lounge area and a roomy bedroom, with optional 60 x 84-inch sit-and-sleep power bed. Add options like ramp door patio rails, three season patio door. (4113TK shown)



FLEXIBLE PUNCTURE RESISTANCE REFLECTIVE

TUFFLEX ROOFING by Dicor Products 20-YEAR WARRANTY!

Dealer:



HEATING & COOLING Standard 3 x 14-inch foam-core in-floor straight-line heating system with 40K BTU furnace and three 15K BTU ducted roof A/Cs w/Whisper Quiet cooling system. (Venom only)



Portions of this brochure were used with the expressed authority of Dexter Axle, but Dexter Axle is not responsible for the accuracy of the information contained herein.



985 N 900 W SHIPSEWANA, IN 46565

E: KZ@KZ-RV.COM

WWW.KZ-RV.COM

Due to continual research and advances, manufacturer reserves the right to change specifications, design, price and equipment without notice, and assumes no responsibility for any error in this literature. Some items shown are not included as standard or optional equipment.

©2020KZ | 12/29/20 | 10M