



RECREATIONAL  
VEHICLES

# VENOM V-SERIES

FIFTH WHEEL TOY HAULERS



## 2020 DÉCOR

HAVANA

SEA SALT

### Fifth Wheel Toy Haulers

	V3214DK	V3411TK	V3413TK	V3815TK	V3916TK
UVW (Unloaded Vehicle Weight)*	10,230	12,410	12,430	13,470	13,340
Dry Hitch Weight*	2,610	2,340	2,270	2,690	2,730
Dry Axle Weight*	7,620	10,070	10,160	10,780	10,610
NCC (Net Carrying Capacity)	4,765	3,590	3,570	4,530	4,660
GVWR	14,995	16,000	16,000	18,000	18,000
Interior Height	102"	102"	102"	102"	102"
Exterior Height w/ A/C	13' 4"	13' 4"	13' 4"	13' 4"	13' 4"
Exterior Width	101"	101"	101"	101"	101"
Exterior Length**	35' 0"	38' 10"	40' 11"	42' 10"	43' 8"
Refrigerator (cu. feet)	8	12	12	12	12
Water Heater Cap. (gal. G/E w/DSI)	12	12	12	12	12
Fresh Water Cap. (gal.) [Including Water Heater Capacity]	112	112	112	112	112
Waste Water Cap. (gal.)	53	93	53	93	53
Gray Water Cap. (gal.)	53	53	93	53	93
1/2 Bath Cap. (gal.)	N/A	40	N/A	40	N/A
LP Gas Cap. (lbs.)	60	60	60	60	60
Furnace BTUs (1,000s)	35	35	35	35	35
Tire Size	16"	16"	16"	16"	16"
Awning	20'	14'	14'	14'	14'
Optional 2nd Awning	N/A	10' 6"	12'	14'	15'

\*This weight reflects the rolling average unit weight for each model. Your trailer weight will vary according to optional equipment.

\*\*Exterior length is measured from center of hitch pin to rear wall.

# 2020 VENOM V-SERIES FIFTH WHEELS

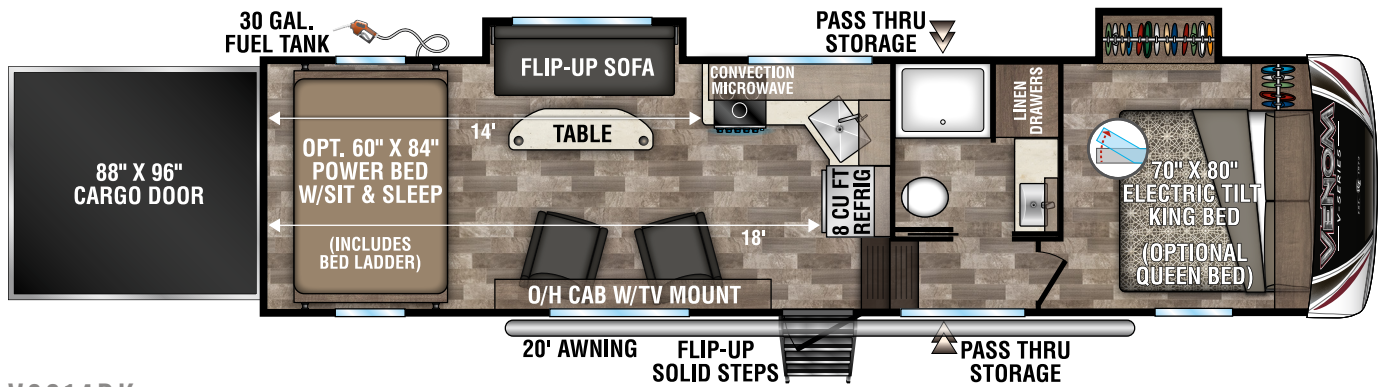

V3214DK

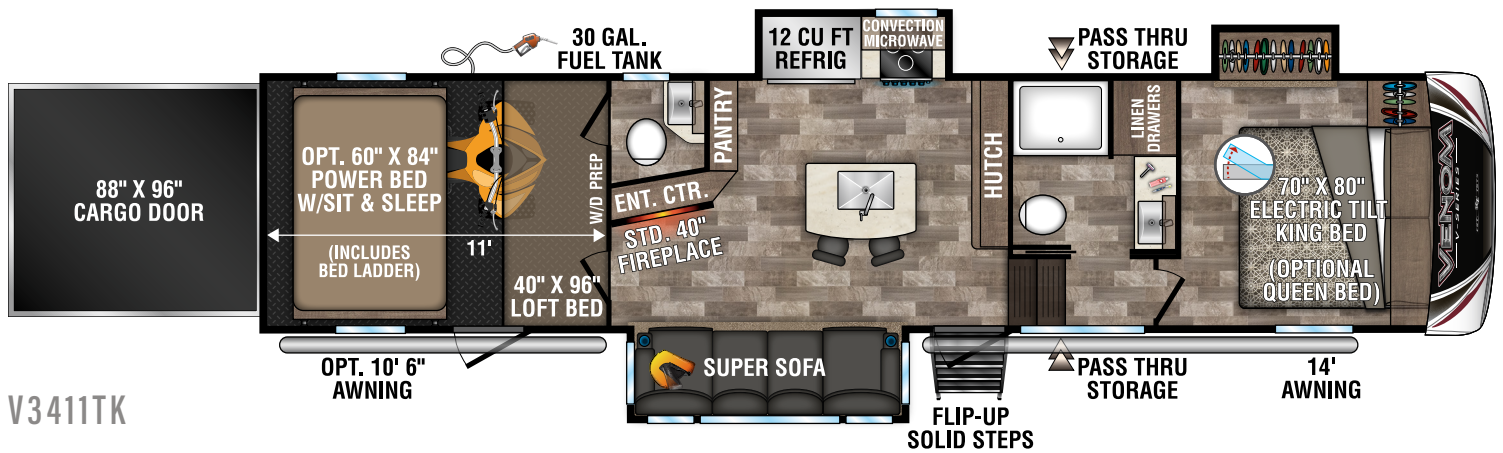

V3411TK



# 2020 VENOM V-SERIES FIFTH WHEELS

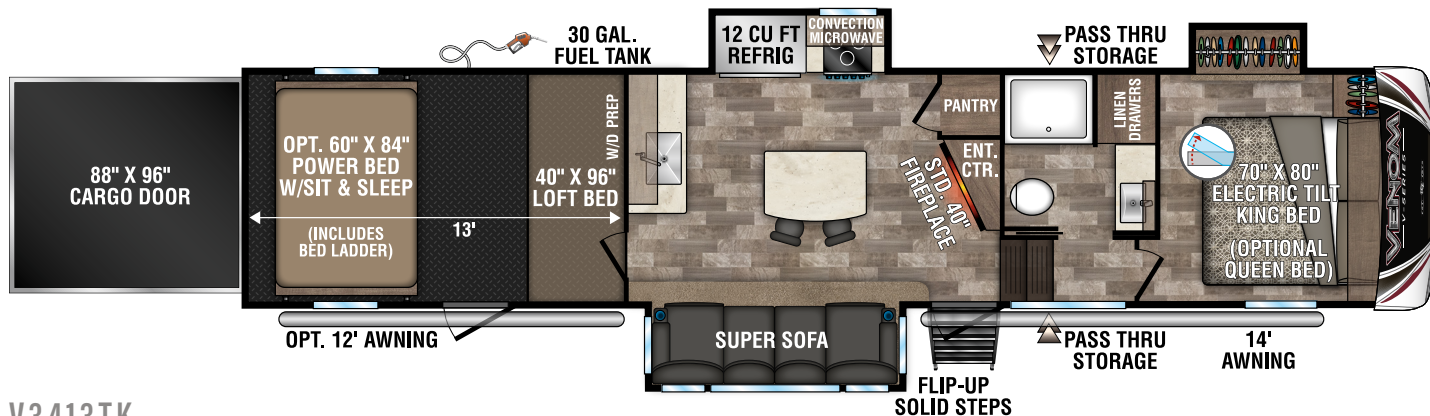

V3413TK

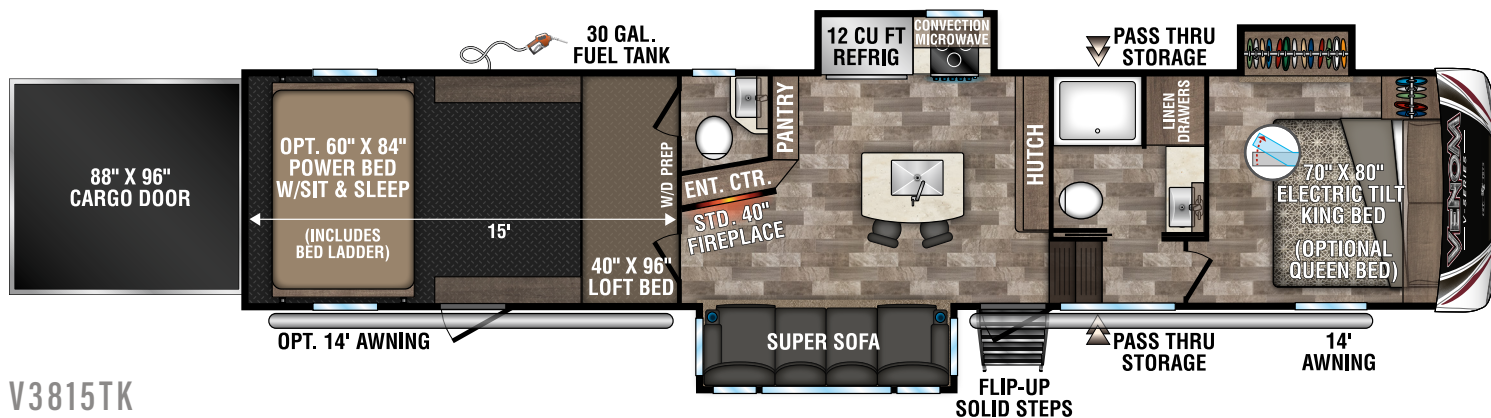

V3815TK

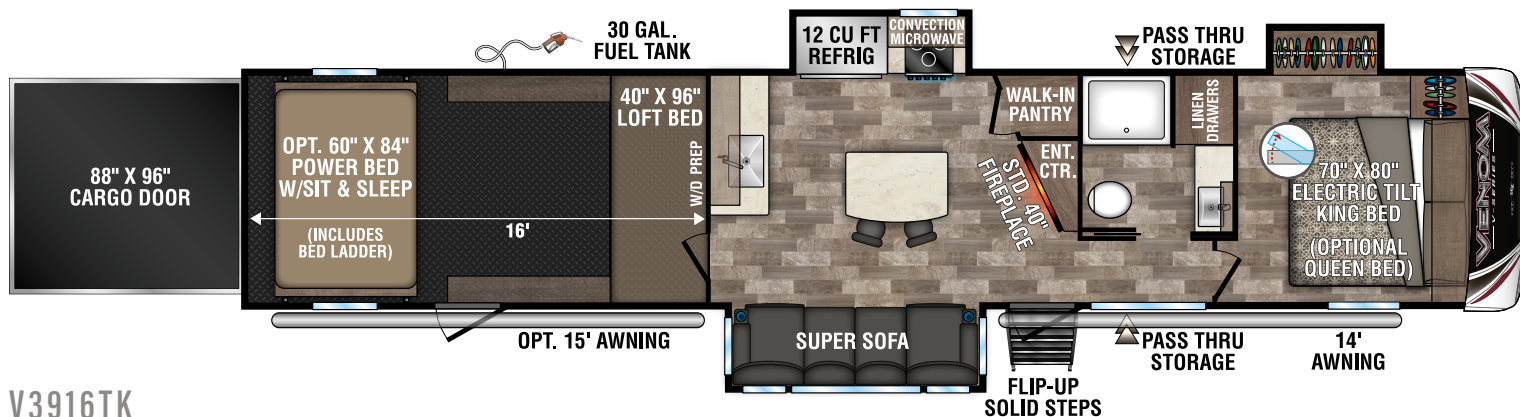

V3916TK

# 2020 VENOM V-SERIES FIFTH WHEELS

## CONSTRUCTION FEATURES

- 101" Wide-Body Construction
- Extra-Reinforced, Heavy Duty, High-Gloss Front Cap
- Radius Aerodynamic Front Cap (provides better turning radius & increased fuel economy)
- 2" x 3" Fully Welded Aluminum Floor Joists
- 2" x 2" Fully Welded Aluminum Sidewall Framing
- Lamilux® Gelcoat Fiberglass
- Double-Insulated & Heated Holding Tanks (R-38 above & below tanks)
- R-11 2" Sidewalls (w/EGS metal backing strips to hold up all interior cabinets)
- 1-Piece, Seamless, Walk-on, Tufflex Roofing Material w/15-Year Warranty
- Fully Vented Attic System
- 3/8" Roof Decking (fully walkable)
- 5/8" Tongue & Groove, Screwed & Glued Plywood Floor Deck
- Pex® In-Floor Heated Waterlines & Kitchen Gray Pipes (all waterlines & drains are located above all insulation)
- Fully-Enclosed & Heated Underbelly w/ Directly Heated Holding Tanks

## EXTERIOR FEATURES

- 7,000# Dexter® Axles w/Auto-Adjusting Brakes
- 8-Lug Heavy-Duty Aluminum Rims w/16" G-Range Nitro-Filled Radial Tires
- 100% Exterior LED Running Lights, Taillights & Backup Lights
- Electric Power Awning w/LED Lights
- Propane Bottles (2 x 30 LBS) on Same Side of Coach for Easy Access
- Side Slam Latch Baggage Doors (where applicable) w/Magnet Catches for Full Access to Storage
- 3" x 14" In-Floor Straight Line Heating System w/35,000 BTU Furnace
- 12 GAL Gas/Electric Hot Water Heater
- Ramp Door LED Lighting
- LED Docking Light & Sewer Hookup Light
- Dual Swing-Away Assist Grab Handle
- Underneath Spare Tire w/Hoist
- Roof Ladder
- Heated Water Convenience Center (includes black tank flush, power fresh tank water fill, winterizing system, outside shower)
- Fully-Finished, Heated & Sealed Basement Storage Compartment (only available w/All-Weather Insulation PKG)
- Heated & Enclosed Dump Valves
- Satellite Pre-Wire in Both the Convenience Center & Roof
- LED Lighted Outside Speakers
- LP Quick Connect

## LIVING ROOM / KITCHEN FEATURES

- Built-In Silverware Drawer
- Storage Shelf under Kitchen Sink
- All Kitchen OH Cabinets have Shelf & Extra-Tall Slide Lips
- Heavy-Duty 100# Drawer Glides on Every Drawer
- Baltic Birch Drawer Boxes
- Decorative Lighting above Many Cabinets
- Window in Kitchen (in most models)
- 5" Stainless Steel Cabinet Hardware
- Window Roller Shades Throughout
- 3/8" Re-Bond Carpet Pad w/22 OZ Residential Carpet
- Stainless Steel Appliances
- Extra-Large Light Switches
- Ceiling Crown Molding
- 100% LED Ceiling & Cabinet Lights w/ Multiple On/Off Switches
- Deluxe Residential-Style Furniture
- Living Room HD Flat Panel TV on Bracket (includes exterior mount)

## GARAGE / RAMP AREA FEATURES

- Built-In Dovetail
- Garage Entry Door (model specific)
- (2) Garage Ceiling Speakers

## BATHROOM / BEDROOM FEATURES

- Skylight Over Shower
- Porcelain Foot-Flush Toilet
- Extra-Wide Hall (going up into bedroom & pocket door from hall into the bathroom - most models)
- Towel Bar in Bathroom (where applicable)
- 12V Fan in Bathroom
- Extra-Large Under-Bed Storage
- Luxurious Bedspread
- Padded Headboard w/Hidden Storage

## OPTIONS (EXTERIOR)

- 3rd 15K BTU Ducted A/C
- Dual Pane Windows (frameless)
- Wireless Backup Camera System - Observation & Vision S
- "Off the Grid" Solar Package\*
- Roto Flex Rubberized Pin Box
- 2nd LED Lighted Power Awning (N/A V2913, V3214)
- Slideout Cover Package (double slides)
- Slideout Cover Package (triple slides)
- Party Patio Package (railing only)
- Three Season Patio Door IPO Screen Wall (N/A V2913)
- 7.0KW Gas Onan Generator
- 32" Exterior TV w/Bracket

## OPTIONS (INTERIOR)

- 32" Bedroom LED TV
- House Residential Refrigerator w/1200W Inverter IPO 12 CU FT Gas/Electric Refrigerator (N/A CSA option) (N/A V2913, V3214)
- Power Vent Fan in Bathroom
- Power Vent Fan in Garage (N/A 3rd A/C option)
- Queen Pillowtop Mattress 60" x 80" (electric tilt)
- Central Vac System
- Happi-Jac Power Bed w/Roll Over Sofas & Table

*\*Cannot get House Residential Refrigerator w/"Off the Grid" Solar Package*

## KZ ADVANTAGE PACKAGE (MANDATORY OPTION)

### EXTERIOR

- 6-Point Electric Auto Leveling
- Polar White Gelcoat Exterior Fiberglass
- Partial Painted Fiberglass Front Cap
- 6-Sided Aluminum Framing
- Zero-G Ramp Door
- Flip-Up Entry Steps (main entry)
- 50 AMP Service
- (2) 15K Ducted A/Cs
- 5/8" Tongue & Groove Plywood Floor
- Key-Alike for Baggage & Entry Doors
- Friction Hinge Entry Door w/Shade Prep
- Screenshot Feature on Entry Door
- X-Large Folding Grab Handle
- Undermount Spare Tire
- Equa-Flex® Suspension
- Nitrogen-Filled Tires
- Battery Disconnect
- Black Tank Flush
- Backup Camera Prep
- Roof Mounted Solar Prep w/Connection
- All Weather Insulation Package (heated, insulated & enclosed underbelly plus foil in floor, roof, front, rear)
- Roof Ladder
- Fully Vented Attic System w/2 Attic Vents

- Toy Lok®
- Generator Prep w/30 GAL Fuel Tank & Pump Station
- Retractable Screen Wall
- Leash Latch w/Bonus Beverage Opener

### INTERIOR

- Maple Glazed Cabinetry
- Glazed Solid Hardwood Slideout Fascia
- Solid Surface Countertops w/Deep Undermount Stainless Steel Kitchen Sink w/Sink Cover
- Trash Can Under Sink
- Drop-In Cooktop w/Glass Cover & Oven
- 30" Convection Microwave
- Kitchen Skylight w/Shade
- Power Vent Fan in Main Area

- Super Sofa (select models)
- (3) Motion Sensor Lights (entry, closet, basement)
- 40" Wideview Fireplace
- LED TV
- Multiple Media Stereo w/DVD/Bluetooth
- 12V Dual USB Charging Station
- Night Roller Shades
- Residential Walk-In Shower
- Porcelain Foot-Flush Toilet
- Stainless Steel Bathroom Sink
- Plywood Bed Base
- Electric Tilt King Bed 70" x 80"
- 12 Gal. Gas/Electric Water Heater
- E-Track Tie-Down System in Cargo Area
- Pocket Door for Bathroom

## KZ CONVENIENCE PACKAGE (MANDATORY OPTION)

### EXTERIOR

- KZ Engage Powered by OneControl w/5" Screen (Control System monitors tank levels & battery levels, controls slide rooms, leveling system, awnings, inside/outside lighting)
- Power Awning w/LED Light Strip
- 16" Tires w/Aluminum Wheels
- Magnetic Catches for Baggage Doors
- Omnidirectional HDTV Antenna w/Wi-Fi Prep
- LED Lights in Exterior Speakers

### INTERIOR

- Residential Grade Linoleum
- 12 CU FT Gas/Electric Refrigerator w/ Temperature Controls (8 CU FT gas/electric refrigerator in 2913, 3214 only)
- Matte Black Residential Kitchen Faucet w/Spring Sprayer
- Surfex Wood Step in FW Hallway
- Wood Accent Trim on Corners/Entry Doors
- (2) Bar Stools (island models)
- Vision S Prep (blind spot monitoring)

## BONUS FEATURES

- 2-year Limited Warranty (see flyer)
- One of the lightest weight high-profile, wide-body, luxury Toy Hauler fifth wheels in the industry
- KZ RV has won the coveted DSI award 19 years.
- KZ RV's 48 years of building experience, coupled with its stable and dedicated Amish workforce and commitment to superb quality, and low overhead, allows us to produce the lowest-priced fully-featured fifth wheel available.



985 N 900 W SHIPSEWANA, IN 46565

E: KZ@KZ-RV.COM

WWW.KZ-RV.COM

Due to continual research and advances, manufacturer reserves the right to change specifications, design, price and equipment without notice, and assumes no responsibility for any error in this literature. Some items shown are not included as standard or optional equipment.

©2019KZ | 1/22/20 | 20M