

SPORTSTER

TRAVEL TRAILER & FIFTH WHEEL TOY HAULERS



RECREATIONAL
VEHICLES

SPORTSTER



SPORTSTER
TRAVEL TRAILER & FIFTH WHEEL TOY HAULERS

PLAY LIKE YOU MEAN IT

Whatever your passion, **SPORTSTER** 102-inch wide-body toy haulers are ready for action, even including a standard Climate Package that extends the camping season. Choose from open-concept or garage floorplans, all with at least 90-inch interior height for taller toys.

Enjoy the residential kitchen and best-in-class entertainment features, or celebrate with friends with the optional Party Patio Package. There's never been a better time to get out there and enjoy the outdoors to its fullest!



Your family will appreciate **SPORTSTER'S 8 CU FT REFRIGERATOR**. Storage abounds in each floorplan. (343TH11 shown)



FLEXIBLE FUNCTIONALITY

Entertainment center with LED TV and 30-inch fireplace. Garage converts to living space featuring optional power bed with Sit-and-Sleep, screen door, washer/dryer prep in fifth wheel garage floorplans, and optional second awning.



343TH11 | Hazelnut décor

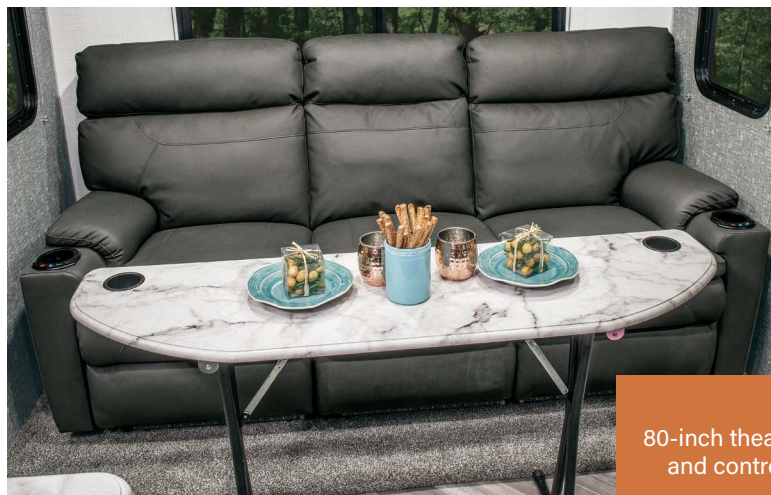

THEATER SEATING

80-inch theater seats with heat, massage, LED accents and controls built into the cup holder. (343TH11 shown)





343TH11 | Hazelnut décor

KITCHEN COMFORT

Slideout kitchen adds spaciousness, with island, hutch and open shelving. Seamless counters with stainless undermount sink, residential-grade linoleum, and Surfex® wood step.

BATHS
offer a shower surround, built-in medicine cabinet with mirror, foot-flush toilet and power vent.



SNORE & STORE

Carpeted flush-floor master bedroom slideout featuring walk-around queen with mirrored his-and-hers full-length closets, four-drawer dresser and additional closet space with the wardrobe slide. (343TH11 shown)



INTERIOR
SPORTSTER

STANDARDS

- 102" Wide Body
- 3/8" Fully Walk-On Roof Decking
- 1-Piece, Seamless, Walk-on, Tufflex Roofing Material w/15-Year Warranty
- Radius Truss Rafter
- 90" Interior Wall Height (TTs)
- Awning w/Drip Rail & Spouts
- Cargo Tie-Down Rings
- Tuff Ply* in Enclosed Cargo Areas
- (2) 20# LP Bottles w/Cover TT
- (2) 30# LP Bottles FW
- 30 AMP Service
- 13,500 BTU A/C
- (2) or (4) Stabilizer Jacks (F/P specific)
- Enclosed Pin Box on FWs
- Tinted Safety Glass Windows
- Self-Adjust Brakes
- Cable & Satellite Hookup
- Radius Entry Door
- Extra-Large, Smooth, Screwless Baggage Doors
- Outside Shower (F/P specific)
- LED Light in Pass-Thru Storage
- Winter Bypass Kit
- Linoleum Throughout
- Acrylic Sink w/High-Rise Faucet
- 3-Burner Cooktop
- Range Hood w/12V Light & Exhaust Fan
- Oven
- Microwave w/Turntable
- Large Overhead Cabinets
- Roller Ball Bearing Drawer Guides

- Super-Sized Panoramic Slideroom Window
- LED Interior Lighting
- Monitor Panel
- Digital TV Antenna w/Booster
- Flush-Floor Bedroom (F/Ws)
- Built-In Medicine Cabinet w/Mirror in Bathroom
- Queen Mattress
- Shower Surround
- Power Vent in Bathroom

OPTIONS

- Color-Infused Titanium Exterior Fiberglass (required)
- 15,000 BTU A/C IPO 13,500 BTU A/C
- 50 AMP Service w/2nd A/C Prep (required FWs) (N/A 280TH)
- 2nd A/C (13,500 BTU)
- Bedroom LED TV w/Inside/Outside Bracket
- Radiant Technology Package (foil in floor, roof, front, rear)
- F/S Dinette Table & Chairs IPO Dinette
- Tri-Fold Hide-A-Bed Sofa IPO Jackknife (331TH, 363TH)
- Theater Seating IPO Dinette (321THR, 311TH)
- Theater Seating IPO Jackknife (331TH, 363TH)
- 10 CU FT 12V Refrigerator IPO 8 CU FT Gas/Electric Refrigerator
- Front & Rear Electric Stabilizer Jacks (TTs)
- Electric Rear Stabilizer Jacks (FWs)
- 30" Fireplace (311TH, 343TH, req'd on 331TH)
- Central Vac System (FWs only)

- 2nd Power Awning w/LED (343TH, 353TH, 363TH)
- MaxxAir Vent Fan (cargo or living room or bath) (required on TTs, 331TH)
- Roof Ladder
- Wireless Backup Camera System - Observation
- Patio Door (363TH12)
- Ramp Extension (N/A w/party patio pkg.)
- Murphy Bed (321THR13)
- Sit-n-Sleep w/Power Bed & Ladder
- Ramp Door Cables (required)
- Party Patio Package (railing only)
- Generator Prep w/30 Gal. Fuel Tank & Pump Station (N/A w/murphy bed option)
- 4.0 Generator (requires generator prep & 30 AMP)
- 5.5 Generator (requires generator prep & 50 AMP)

KZ ADVANTAGE PACKAGE

(MANDATORY OPTION)

EXTERIOR

- New Aerodynamic Front Profile (TTs)
- Flip-Up Entry Steps (main entry)
- 5/8" T&G Plywood Floor
- Key-Alike for Baggage & Entry Doors
- Friction Hinge Entry Door w/Shade Prep
- Large Folding Grab Handle
- Power Front Jack
- Spare Tire
- Equa-Flex® Suspension
- Nitrogen-Filled Tires

- Exterior Speakers
- Battery Disconnect
- Black Tank Flush
- Backup Camera Prep
- Solar Prep
- Climate Package (heated, insulated & enclosed underbelly)
- Leash Latch w/Bonus Beverage Opener

INTERIOR

- Seamless Countertops w/Deep Undermount Stainless Steel Kitchen Sink
- Sink Cover
- Drop-In Cooktop w/Glass Cover & Oven
- Kitchen Skylight
- 36" Storage Bins in Booth Dinette
- Bright White LED Light Strip above Main LR Slideroom(s)
- Jackknife w/Middle Console & Bolster Arms
- (2) Motion Sensor Lights
- LED TV
- Multiple Media Sound Bar Stereo w/Bluetooth, HDMI & USB Charge
- (2) 6.5" Interior Speakers
- (2) 12V USB Ports in Bedroom
- Pleated Shades
- Foot-Flush Toilet
- Plywood Bed Base
- Pillowtop Mattress
- W/D Prep in Garage Models (FWs)
- Wider Pocket/Passage Interior Doors
- Color Accented Shower Walls
- Bathroom Shelf w/Towel Hooks
- King Bed Mattress (TTs)

KZ CONVENIENCE PACKAGE

(MANDATORY OPTION)

EXTERIOR

- 102" Wide Exterior
- Power Awning w/LED Light Strip
- Aluminum Wheels (TTs)
- 16" Tires w/Aluminum Wheels (FWs)
- 12" Diamond Plate on Sidewalls of Enclosed Garages
- Magnetic Catches for Baggage Doors
- LED Light in Storage Area
- Battery Disconnect Switch
- Omnidirectional HDTV Antenna w/Wi-Fi Prep
- LED Lights in Exterior Speakers
- Dual Rear Ramp Lights

INTERIOR

- Residential Grade Linoleum
- 8 CU FT Gas/Electric Refrigerator w/ Temperature Control
- Stainless Steel Residential Kitchen Faucet w/Spring Sprayer
- Surfex® Wood Step in FW Hallway
- Interior Control Switches on OH End Cabinet w/Convenience Center for Switches
- Dark Accent Trim on Corners/Entry Doors
- Soft Snap Curtain in Garage Area
- Woodgrain Door to Garage Area
- Full-Width OH in Enclosed Garage Area
- Stainless Steel Microwave
- Ramp Door Cables

TRAVEL TRAILERS

FIFTH WHEELS

Toy Haulers	301THR	321THR13	342THR13	280TH	311TH10	331TH13	343TH11	353TH13	363TH12
UVW (Unloaded Vehicle Weight)*	8,030	8,070	8,890	8,160	8,750	9,410	10,600	10,550	11,330
Dry Hitch Weight*	1,200	1,160	1,600	1,650	1,610	2,030	2,430	2,410	2,120
Dry Axle Weight*	6,830	6,910	7,290	6,510	7,140	7,380	8,170	8,140	9,210
NCC (Net Carrying Capacity)	1,970	1,930	2,810	1,840	2,250	2,585	2,395	2,950	3,910
GVWR	10,000	10,000	11,700	10,000	11,000	11,995	12,995	13,500	15,240
Interior Height	90"	90"	90"	92"	92"	92"	92"	92"	92"
Exterior Height w/ A/C	12' 3"	12' 3"	12' 3"	12' 3"	12' 3"	12' 5"	12' 7"	12' 7"	12' 7"
Exterior Width	102"	102"	102"	102"	102"	102"	102"	102"	102"
Exterior Length**	35' 9"	37' 3"	39' 1"	32' 8"	34' 2"	38' 8"	38' 8"	40' 8"	42' 1"
Refrigerator (cu. feet)	8	8	8	8	8	8	8	8	8
Water Heater Cap. (gal. G/E w/DSI)	6	6	6	6	6	6	6	6	6
Fresh Water Cap. (gal.)	75	75	75	75	75	75	75	75	75
Waste Water Cap. (gal.)	32	32	32	53	53	32	85	85	53
Gray Water Cap. (gal.)	64	32	32	53	53	32	53	53	53
LP Gas Cap. (lbs.)	40	40	40	60	60	60	60	60	60
Furnace BTUs (1,000s)	30	30	30	30	30	30	30	30	30
Tire Size	15"	15"	16"	16"	16"	16"	16"	16"	16"
Awning	19'	19'	19'	18'	17'	20'	14'/10' opt.	14'/12' opt.	18'/9' opt.

*This weight reflects the rolling average unit weight for each model. Your trailer weight will vary according to optional equipment.

** Fifth Wheel exterior length is measured from the center of the hitch pin to the rear bumper.

2020 DÉCOR

ALMOND

HAZELNUT

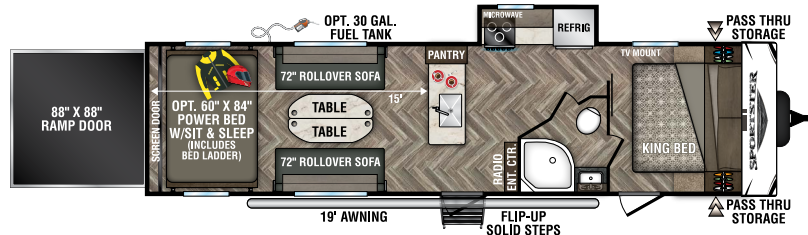

301THR UVW - 8,030 | Exterior Length - 35' 9" | Sleeps 8

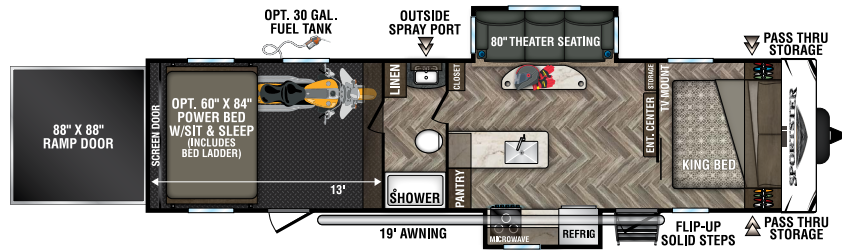

342THR13 UVW - 8,890 | Exterior Length - 39' 1" | Sleeps 6

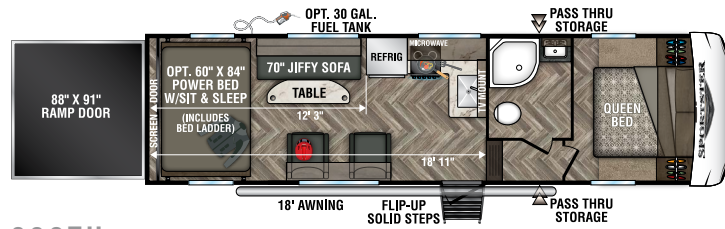

280TH UVW - 8,160 | Exterior Length - 32' 8" | Sleeps 7

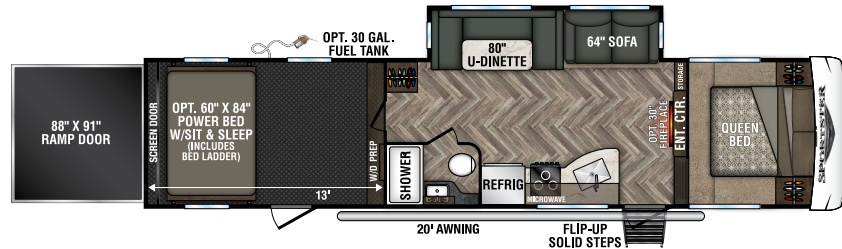

331TH13 UVW - 9,410 | Exterior Length - 38' 8" | Sleeps 8

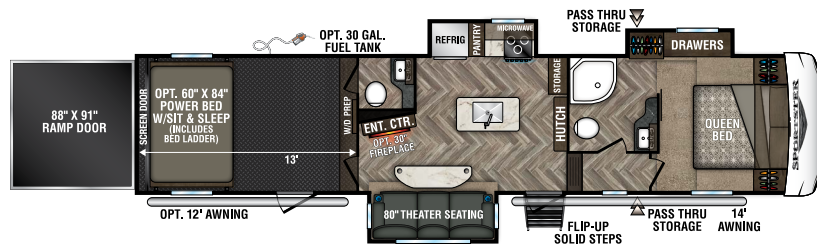

353TH13 UVW - 10,550 | Exterior Length - 40' 8" | Sleeps 6

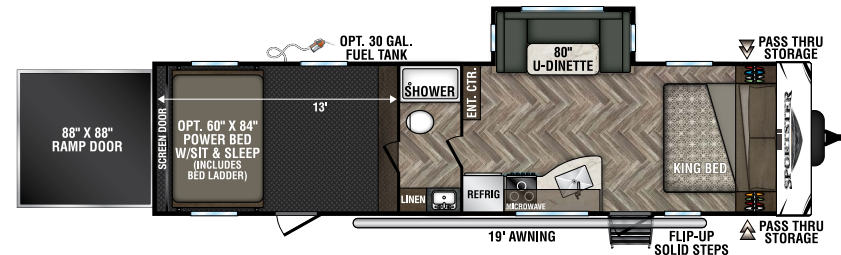

321THR13 UVW - 8,070 | Exterior Length - 37' 3" | Sleeps 7

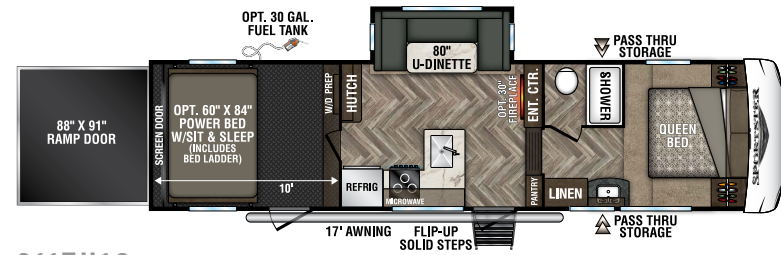

311TH10 UVW - 8,750 | Exterior Length - 34' 2" | Sleeps 7

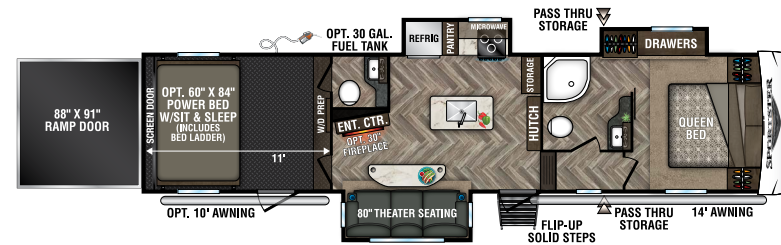

343TH11 UVW - 10,600 | Exterior Length - 38' 8" | Sleeps 6

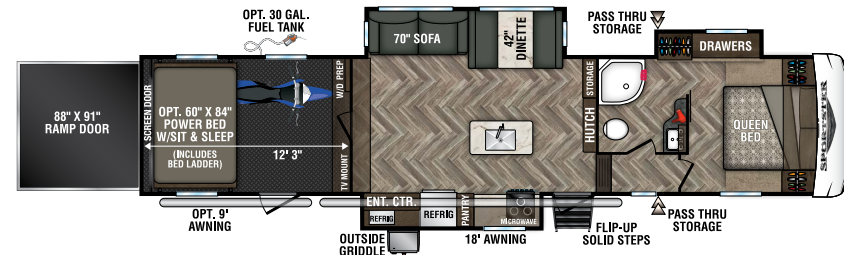

363TH12 UVW - 11,330 | Exterior Length - 42' 1" | Sleeps 8

SPORTSTER EXTERIOR FEATURES



STANDARD FLIP-UP ENTRY STEP

Solid footing, coming and going, plus handy friction hinge door with auto-close feature and large folding grab handle



Added insulation so you can extend the camping season, with a fully-enclosed, insulated and heated underbelly to protect tanks and pipes (R-9 sidewalls, R-20 roof, and R-24 floor).



DOWNLOAD YOUR FREE

KZ RV APP TODAY!

Owning and operating an RV has never been easier. Everything you need is now in the palm of your hand.

- Track RV Maintenance
- Keep RV Service Close
- Set Custom Notifications
- Reference Checklists for RV Trips



DOWNLOAD
NOW!

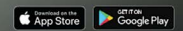

VISIT KZ-APP.COM TO LEARN MORE.

Get the **PARTY** started with Sportster's Illuminated marine-grade **EXTERIOR SPEAKERS.**



LIGHTED BAGGAGE COMPARTMENT
Extra-large, smooth, screwless baggage doors with magnetic catches



Nitrogen-filled 16-inch tires with **ALUMINUM WHEELS**, spare tire and self-adjusting brakes. Equa-Flex rubberized equalizer absorbs road shock and reduces fore-to-aft movement.

Sportster's **FUEL STATION** includes a 30-gallon fuel tank and pump station, and is part of the Generator Prep option.



GENERATOR STORAGE Optional 4.0 or 5.5 generator

SPORTSTER

EXTERIOR FEATURES



POWER AWNING WITH LED LIGHT STRIP provides relaxing nighttime ambience



OPTIONAL PARTY PATIO PACKAGE railing makes the perfect entertainment extension, by allowing you to get the most use out of the rear ramp.



GARAGE CONVERTS EASILY Sportster garages boast Tuff Ply® flooring with 12" protective diamond plate on sidewalls and 90-inch interior height, and feature an optional 60 x 84-inch power bed with Sit-and-Sleep, that folds flat against the walls. (343TH11 shown).

GARAGE
FEATURES

SPORTSTER



RECREATIONAL VEHICLES

HANDCRAFTED TO HIGH STANDARDS

In 1972, Sam King and Daryl Zook built a truck camper—and built a better way to camp. Since then we've built recreational vehicles with a focus on craftsmanship and quality, so you can spend more time adventuring and less time worrying.

When you hitch to a KZ Recreational Vehicle, you can expect adventure, good times, and old-world values. We care about your camping experience. Because your KZ is where the journey starts.

Go. Camp. Live.

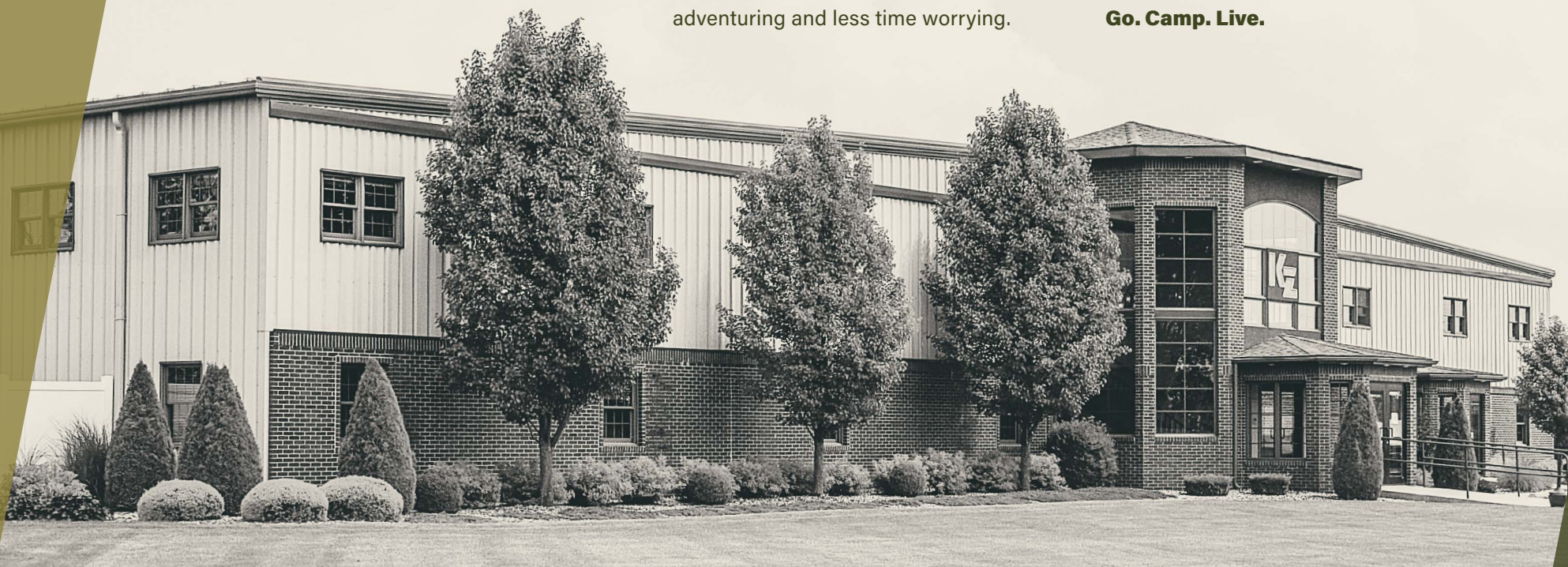

The KZ **True 2 Warranty** is a **2-year hitch-to-bumper limited warranty** that's true to its name. The gold standard in RV protection, True 2 provides double the coverage of the industry norm. Plus, our warranty is backed by the craftsmanship and quality we're known for, so you can Go. Camp. Live. Wherever your adventure takes you, know that you're covered in your KZ.

Dealer:

RVIA