

VENOM

VENOM LUXURY FIFTH WHEEL TOY HAULERS



VENOM

When you get right down to it, all toy haulers have garages and most offer wide-body construction, but that's where the similarities end. They are definitely not created equally. Upon its introduction, Venom raised the bar and all others are taking notice, starting with the industry's only 2-year bumper-to-bumper limited warranty that's approved for fulltime use.

Starting with 6-sided aluminum construction, an all-weather package rated to R38 (including your holding tanks) and Pex in-floor heated waterlines, Venom provides comfort and peace of mind.

Once inside, you quickly notice residential features, well-designed layouts and plush amenities that make Venom more resemble a getaway cottage than your typical RV.

In back, the garage boasts E-Track, one of the best tie-down systems in the industry, comes standard with TV, stereo with speakers and a roll-down screen wall, and offers many options for the recreational enthusiast. Whether you're wanting a toy hauler to transport your toys or just appreciate the extra versatile space, Venom creates the perfect balance between having your cake and eating it, too.



Standard Exterior Steps Lightweight, rustproof aluminum, with strong steel linkages and frame.



Under-Mount Spare Out of the way, easy crank-down.





The kitchen sports an upscale stainless steel appliance package that includes a 30-inch microwave above the range. The deep double stainless steel sink with high arch, pull-out faucet, solid surface countertops, and an abundance of storage and built-in space-saving features make food prep and clean-up easy.



V4111TK | Sandstorm décor



V4013TK | Sandstone décor



50 AMP Service
Satisfies all your electrical needs.



Key-Alike Locks
Increased security and ease of use.

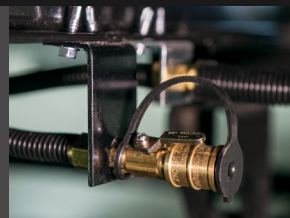

LP Quick-Connect
Allows for additional LP appliances.



Industry's first self-contained, lightweight and adjustable ground-stable step that provides secure footing (optional).



WOW



V4013TK
Nighthawk décor
optional power bed



**Rear Observation
Camera Prep**
Optional backup
camera increases
ease and safety
while backing.



**Exterior Battery
Disconnect** A turn
of the knob keeps
your battery from
discharging.

Rest comfortably in the standard high grade queen size bed that conceals an extra large storage area underneath. Plenty of personal storage is designed into the master bedroom including a spacious closet equipped with a motion light. For late night relaxing, a flat panel TV is mounted on a swing arm for viewing from any angle.

The optional queen size power bed and roll-over sofa turn the garage area into a second bedroom at night. During the day, the power bed raises up and stores near the ceiling to make room for your toys, or fold up the sofas for an additional living area.



all images | V4013TK | Nighthawk décor



Standard on all Venom, the all-weather insulation package includes upgrades to roof, floor, ceiling, endcaps and tanks to R-38, allowing you to enjoy your fifth wheel all year long.



Off The Grid solar package with 160W solar panel offers the freedom to unplug while you're away (optional).



Venom comes standard with 3" x 14" foam-core in-floor straight-line heating system with 35,000 BTU furnace and 15,000 BTU ducted roof air conditioner.



My RV gives you command of your fifth wheel from one location, with the touch of your finger. This allows you to control the awning, landing gear, and slideouts, as well as access to troubleshooting videos and your owners manual.

Outside
Speakers



Heated Water Convenience Center

Includes black tank flush, power fresh tank water fill, winterizing system and outside shower.



Portions of this brochure were used with the expressed authority of Dexter Axle, but Dexter Axle is not responsible for the accuracy of the information contained herein.

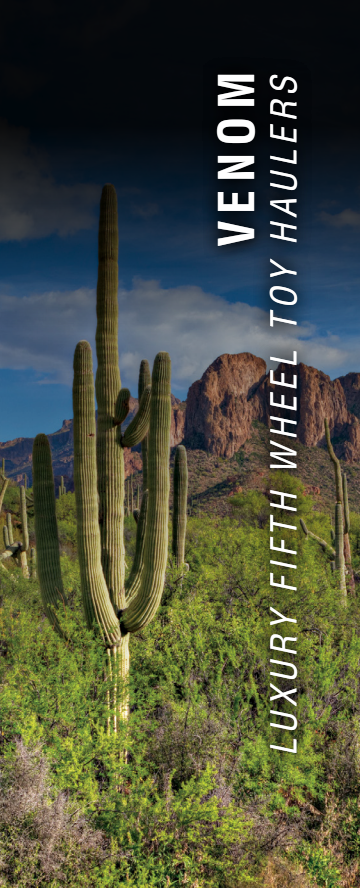

VENOM LUXURY FIFTH WHEEL TOY HAULERS

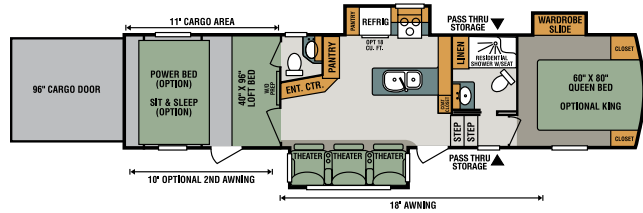

V3411TK

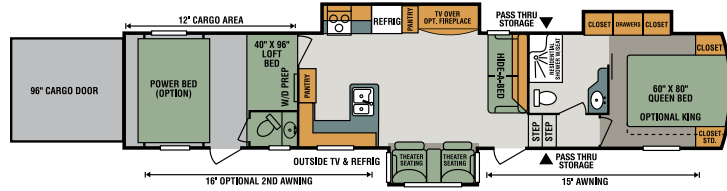

V4012TK

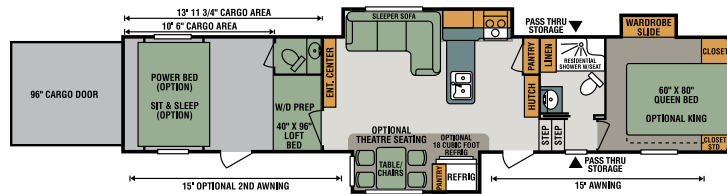

V4111TK

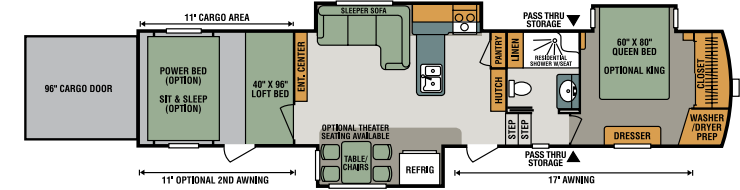

V3911TK

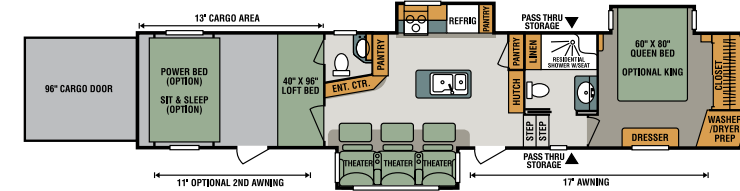

V4013TK

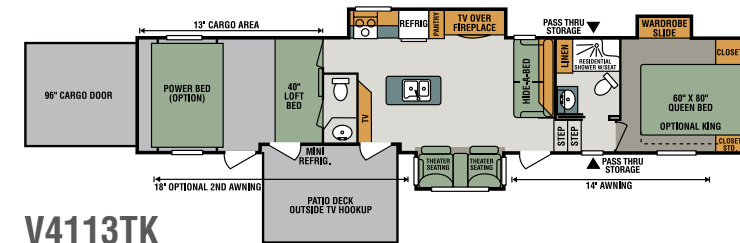

V4113TK

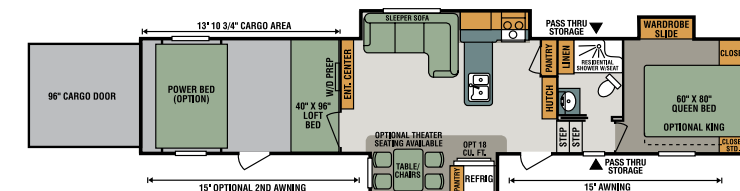

V4114TK



LUXURY FIFTH WHEEL TOY HAULERS	V3411TK	V3911TK	V4012TK	V4013TK	V4111TK	V4113TK	V4114TK
UVW (Unloaded Vehicle Weight)*	13,300	14,050	15,310	15,100	14,700	15,160	14,400
Dry Hitch Weight*	2,520	3,070	3,190	3,100	3,160	2,820	3,130
Dry Axle Weight*	10,780	10,980	12,120	12,000	11,540	12,340	11,270
NCC (Net Carrying Capacity)	2,700	4,950	3,690	3,900	4,300	3,840	4,600
GVWR	16,000	19,000	19,000	19,000	19,000	19,000	19,000
Interior Height	102"	102"	102"	102"	102"	102"	102"
Exterior Height	13' 4"	13' 4"	13' 4"	13' 4"	13' 4"	13' 4"	13' 4"
Exterior Width	101"	101"	101"	101"	101"	101"	101"
Exterior Length**	37' 8"	42' 7"	43' 7"	43' 4"	43' 4"	43' 7"	43' 4"
Refrigerator (cu. feet)	8	8	8	8	8	8	8
Water Heater Cap. (gal. G/E w/DSI)	12	12	12	12	12	12	12
Fresh Water Cap. (gal.)	112	112	112	112	112	112	112
Waste Water Cap. (gal.)	57	57	57	77	57	57	57
Gray Water Cap. (gal.)	57	97	97	97	97	97	97
1/2 Bath Cap. (gal.)	40	N/A	40	N/A	40	40	N/A
LP Gas Cap. (lbs.)	60	60	60	60	60	60	60
Furnace BTUs (1,000s)	35	35	35	35	35	35	35
Tire Size	16"	16"	16"	16"	16"	16"	16"
Awning	18'	17'	15'	17'	15'	14'	15'
Optional 2nd Awning	10'	11'	16'	11'	15'	18'	15'

*This weight reflects the rolling average unit weight for each model. Your trailer weight will vary according to optional equipment.

**Exterior length is measured from the center from the hitch pin to the rear bumper.

CONSTRUCTION STANDARDS

- 101" Wide Body Construction
- 6-Sided aluminum frame, including welded aluminum fore & aft floor joists, sidewall framing, & roof trusses
- Extra Reinforced Heavy-Duty Front Fiberglass Cap
- Radius Aerodynamic Front Cap
- 2" x 3" Fully-Welded Aluminum Floor Framing
- 2" x 2" Fully-Welded Aluminum Sidewall Framing
- 5" Welded Aluminum Roof Trusses
- Lippert® Hydraulic Slide System w/ Selector Valves
- 12" Powder-Coated Steel I-Beam w/ Drop Frame (160 SQ FT pass-thru storage)
- Lamilux 4000® High-Gloss Fiberglass Sidewalls
- All Weather Insulation Package to R38 (roof, floor, garage floor end caps, holding tanks)
- Double Insulated & Heated Holding Tanks (R38 above & below tanks)
- Additional Outside Frame-to-Wall Floor Insulation
- R11 2" Sidewalls (w/EGS metal backing strips)
- One-Piece ABS Slideroom Bottoms
- Superflex® Roof Membrane (TPO/ rubber hybrid, 12-year warranty)
- 45-Degree Radius Aluminum Roof Edge
- Fully Vented Attic System
- 3/8" Fully Walk-On Roof Decking
- 5/8" Tongue & Groove Screwed & Glued Plywood Floor Decking
- Metal Skirt (covering the doorside frame)
- Pex® In-Floor Heated Waterlines & Kitchen Gray Pipes (all waterlines & drains located above all insulation)
- Fully-Enclosed & Heated Underbelly w/Direct-Heated Holding Tanks

EXTERIOR STANDARDS

- 7,000 LB Dexter® Axles w/Self Adjusting Brakes & Height Adjusting Hangers
- 8-Lug Heavy-Duty Aluminum Rims w/16" G-Range Radial Tires
- EZ Flex® Rubberized Suspension
- Aluminum 4-Step Entry w/LED Light

- Roto-Flex® Hitch Pin
- 100% Exterior LED Running & Taillights
- LCI Smart Arm Awning w/Light Strip
- Propane Bottles (2 x 30 lbs.) on Same Side for Easy Access
- Sealed Battery Storage Compartment (no battery boxes required)
- Triple Front Slam-Latch Baggage Doors
- Side Slam-Latch Baggage Doors w/Gas Struts & Dual Locks
- 50 AMP Service w/Detachable Marine Power Cord
- Fully Painted Front Cap w/LED Accent Lights
- Frameless Windows
- 15,000 BTU Ducted Roof AC w/Quiet Cool (prewired for OPT ducted 15,000 BTU bedroom AC w/quiet cool)
- Wired & Framed for OPT 3rd 15,000 BTU AC
- 35,000 BTU Furnace w/3" x 14" In-Floor Straight Line Heating System
- 12 GAL Gas/Electric Hot Water Heater
- LED Entry Door Floodlight
- Ramp Door w/LED Lighting
- LED Docking & Sewer Hookup Lights
- Sewer Hose Storage Tube
- Dual Swing-Away Assist Grab Handle
- Under-Frame Spare Tire w/Hoist
- Roof Ladder
- Heated Water Convenience Center (incl. black tank flush, power fresh tank water fill, winterizing system, outside shower, & dry-camping water siphon)
- Fully-Finished Heated & Sealed Basement Storage Compartment
- Camp Table & Patio Chairs Storage Compartment
- Heated & Enclosed Dump Valves
- Battery Disconnect
- Satellite Pre-Wire in Convenience Center & Roof
- LED Lighted Outside Speakers
- Generator Prep w/ Dedicated 30 GAL Fuel Tank
- 40 GAL Fuel Station w/Electric Pump
- Solar Prep – Roof
- LP Quick Connect
- Rear Camera Prep
- Keyed Alike Baggage Doors

EXTERIOR OPTIONS

- 6-Point Hydraulic Auto Leveling System
- 2nd Lighted Power Garage Entry Door Awning
- Dual Pane Frameless Windows
- Onan® 5500 Gas Generator
- 15,000 BTU Bedroom AC
- 15,000 BTU Garage AC w/Load Management System
- Slideout Cover Package
- Observation Camera
- "Off the Grid" Package (includes 160W solar panel, inverter and monitor)
- Trail Air Flex Air Upgraded Pinbox
- MORryde Flip Out Steps (main entrance only)
- Full-Body Paint Package

KITCHEN STANDARDS

- Solid Surface Countertops, Flush-Mount Stove Covers & Sink Covers w/Large Handholds
- Large Residential Double Bowl Stainless Steel Sink
- High-Arching, Pullout, Residential Faucet
- 30" Microwave above Range
- U.S. Made Large Dining Table w/ Removable Leaf & 2 Heavy-Duty Chairs (2 additional folding chairs V3911TK, 4111TK, 4114TK)
- Power Vent Kitchen Fan w/Wall Controls
- XL Residential Size Pullout Trashcan (where applicable)
- Removable Silverware Tray
- Under-Sink Storage Shelf
- OH Cabinets incl. Shelf & Extra-Tall Slide Lips
- Hidden Cabinet Door Hinges
- 5" Stainless Steel Cabinet Hardware
- Baltic Birch Drawer Boxes
- Heavy-Duty 100 LB Drawer Glides
- LED Kitchen Cabinet Toe-Kicks (where applicable)
- Kitchen Window (most models)

INTERIOR STANDARDS

- 7" Monitor MyRV® Control Panel (monitors tank levels & battery levels, controls slide rooms, leveling system, awnings, inside/outside lighting)

- 22 OZ Residential Carpet w/ 3/8" Re-bond Padding
- XL Ceiling Crown Molding
- Night Roller Shades Throughout
- 100% LED Ceiling & Cabinet Lights w/Multiple On/Off Switches
- LED RGB Entertainment Lights
- Extra-Large Light Switches
- Faux Vinyl Soft Touch Ceiling
- Deluxe Residential-Style Furniture
- Removable Pedestal Tables in Front of Seating (based on model)
- 40" – 48" HD LED TV on Swing Arm w/Behind-TV Storage
- Residential Entertainment System w/ Radio/Bluetooth/Sound Bar & Bass Subwoofer
- USB Charging Station & 12V Power Outlet
- 40" Wide View Fireplace w/Remote (most models)

INTERIOR OPTIONS

- Theater Seat IPO Free-Standing Table & Chairs (V3911TK, V4111TK, V4114TK)
- 18 CU FT 120V Residential Refrigerator w/Inverter (N/A V3411TK, V4013TK, V4113TK)
- 18 CU FT 4-Door RV Refrigerator (LP/Electric)
- 30" OTR Convection Oven/Microwave IPO OTR Microwave
- Power Vent Fan w/Wall Controls (bath, bedroom, garage)
- Day/Night Roller Shades
- Central Vacuum System

BEDROOM STANDARDS

- XL Deep Closet w/Shoe Storage Rack (V3911TK, V4013TK)
- Dual Washer/Dryer Prep (stacked or side-by-side)
- XL Under-Bed Storage
- Luxurious Bedspread & Pillow Shams
- Flat Panel TV on Swing Arm
- 60" x 80" Queen-Size Upgraded Mattress
- Motion Light – Closet

BEDROOM OPTIONS

- 72" x 80" King Size Upgraded Mattress

BATH STANDARDS

- Residential One-Piece FG Shower Stall w/Glass Doors & Built-In Seat
- Shower Skylight
- XL Solid Surface Bath Vanity w/Stainless Steel Sink
- Motion Light
- Porcelain Foot-Flush Toilet
- XL Linen Cabinet
- XL Deep Closet w/Shoe Storage Rack (V3911TK & V4013TK)
- Extra-Wide Hallway & Pocket Door
- Power Vent w/Wall Switch
- Towel Bar & Towel Ring

GARAGE STANDARDS

- Roll-Down Screen Wall
- E-Track Tie-Down System
- Built-In Dovetail
- 24" Diamond Plate Wall Guards
- Garage Entry Door
- HD Flat Panel Garage TV on Swing Arm
- 12V Radio/DVD Player
- (2) Garage Ceiling Speakers
- Speaker On/Off Switches
- Zero Gravity Ramp Door w/Easy-Lift Assist

GARAGE OPTIONS

- HappiJac® Electric Bed & Rollover Sofa w/Table
- Ramp Door Patio w/Entry Steps & Electric Awning
- 3-Season Patio Door IPO Roll-Down Screen Wall
- Toy Lock
- Removable 10' x 8' Edged Garage Carpet Kit

BONUS FEATURES

- 2-Year Limited Warranty (see flyer)
- One of the Lightest, High-Profile, Wide Body, Luxury Toy Hauler Fifth Wheels in the Industry
- K-Z has received the Dealer Satisfaction Index Award for 17 years
- K-Z's 46 years of stable, dedicated manufacturing experience, coupled with its predominant Amish workforce, heritage and commitment to superb quality, allow us to produce the lowest-priced luxury fifth wheel available.

VENOM

LUXURY TOY HAULER *with the* COMFORTS OF HOME



True 2-Year Limited Warranty!
K-Z's 24-month hitch-to-bumper limited warranty umbrella is the best 2-year warranty in the business, covering more than 1,500 operations codes for a full two years (approved for fulltime living), and protects your investment while you enjoy your new RV.



DSI stands for dealer satisfaction index. Our dealer body consistently rates K-Z highly, and the RV Dealer Association has awarded K-Z their top honor Quality Circle Award for excellence of design, reliability, overall quality and value, communications and dealer support. K-Z has been honored with the DSI award for more years in a row than any other towable manufacturer!



K-Z proudly supports our veterans and active military. Thank you for your service!



K-Z is headquartered in Shipshewana, Indiana, and was founded in 1972 on the principles of quality, fairness and integrity. Today, K-Z produces several widely-recognized brands of towables, including Durango, Sidewinder and Venom.

The first RV K-Z offered was a truck camper, and was designed, fabricated and assembled by two employees. Then 12 employees. Then we added travel

trailers. And 20 employees. Then fifth wheels. Over the years, as the product selection grew, so did the headcount. Today, the K-Z campus covers 530,000 square feet, includes over 600 employees (one of the largest employers in our area), and hosts 20 product lines that offer close to 200 floorplans.

People make a difference, and at K-Z, our employees make all the difference in the world. As you'll discover when you communicate with K-Z, you'll always be speaking with someone who takes you seriously and treats you with respect. Quality products and business integrity are a way of life at K-Z. Thank you for considering K-Z, and we'd like to welcome you to our world-wide family of satisfied customers!

RVIA

K-Z strongly encourages our retail customers to purchase from their local dealership whenever possible.



985 N 900 W • Shipshewana, IN 46565
E-mail kz@kz-rv.com • www.kz-rv.com

Due to continual research and advances, manufacturer reserves the right to change specifications, design, price and equipment without notice, and assumes no responsibility for any error in this literature. Some items shown are not included as standard or optional equipment.
©2018KZ | 01/03/18 | 60M

Dealer: