

SPORTSMMEN® *Classic*

Ultra Lightweight Travel Trailers

Standards

- K-Z Exclusive Tough Shield .030 Exterior Metal
- R-7 Insulation
- Front Diamond Plate
- Alum-a-Tough® Roofing w/12-Year Limited Warranty
- Tinted Windows
- Radial Tires
- Self-Adjust Electric Brakes
- Rear Bumper w/Sewer Hose Storage
- Digital TV Antenna
- Cable Hookup
- City Water Fill
- 12V Converter w/Charger
- LP Tank
- 2-Burner LP Hot Plate
- Microwave
- LP/Electric Refrigerator
- Single-Bowl Sink
- 6-Gallon LP DSI Water Heater
- Rail-Style Cabinet Doors w/Modern Handles
- Overhead Cabinets
- LED Interior Lights
- Shower & Toilet
- Tank Monitor Panel

Options

- 13,500 A/C Low Pro (req 180RBT)
- U-Dinette IPO STD Dinette (181BH)
- 6.3 CU FT Refrigerator (req 180RBT & must option roof air) (N/A 130RB, 150RBT)
- 24" TV w/Inside/Outside Bracket (160QB, 180QB, 180TH, 180THT)
- Retractable Screen Wall (toy haulers only)
- Front Window (N/A on toy haulers, 160RBT, 180RBT)
- Wireless Backup Camera System – Observation

Off-Road Package

- Aluminum Rims w/15" Mud Tires
- Extra Ground Clearance
- Electronically-Controlled Heated Holding Tank
- Double Entry Step (select models)

K-Z Advantage Package

(mandatory option)

Exterior

- 5/8" Tongue & Groove Plywood Floor
- New Front Profile w/78" Interior Walls
- 8,000 BTU A/C
- Power Awning w/LED Light Strip
- Key-Alike Program for Baggage & Entry Doors
- Aqualon Edge Tent Material
- Folding Grab Handle

- Exterior Speakers
- Spare Tire & Carrier
- (4) Scissor-Style Stabilizer Jacks
- Two-Toned Exterior Metal
- Solar Prep
- Backup Camera Prep
- Nitrogen-Filled Tires

Interior

- 20,000 BTU Furnace
- Plywood Bed Base
- Foot-Flush Toilet
- (2) 6 ½" Interior Speakers
- 12V Dual USB Port
- Digital Media Stereo W/Bluetooth & USB Port

K-Z Convenience Package

(mandatory option)

Exterior

- Friction Hinge Entry Door
- Double Entry Steps (select models)
- Omnidirectional HDTV Antenna

Interior

- Armstrong® ToughGuard® Linoleum
- Rail-Style Cabinet Doors
- Interior Control Switches on Overhead End Cabinet

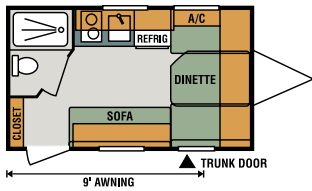

130RB

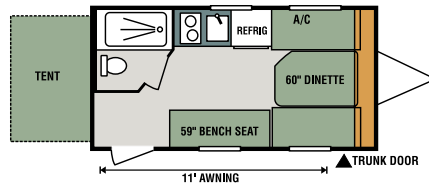

150RBT

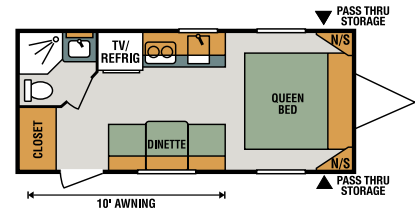

160QB

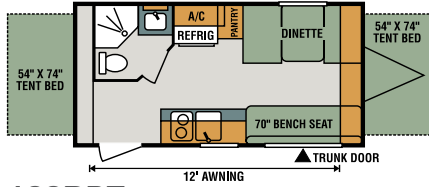

160RBT

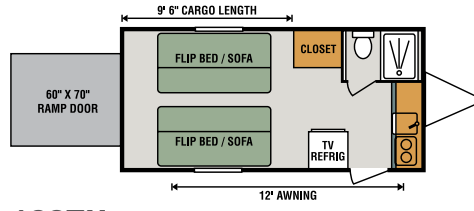

160TH Toy Hauler

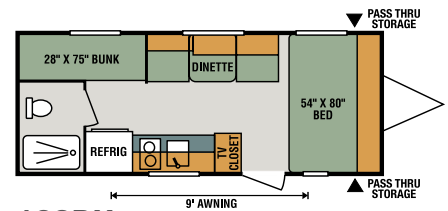

180BH

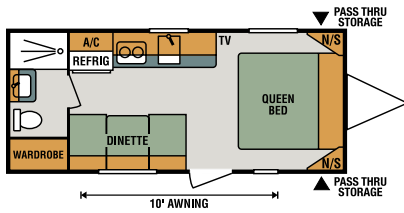

180QB

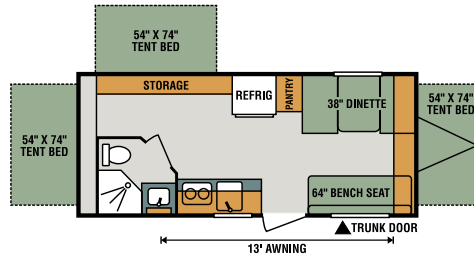

180RBT

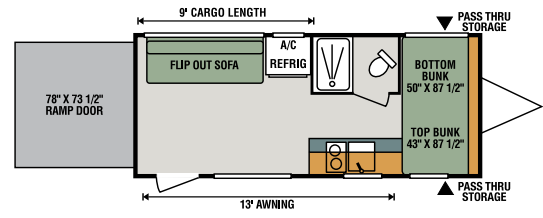

180TH Toy Hauler

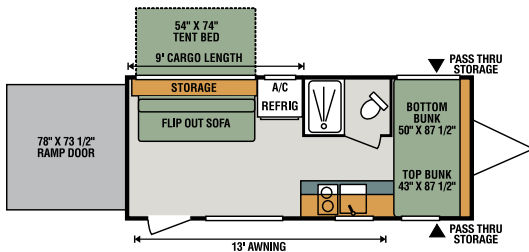

180THT Toy Hauler

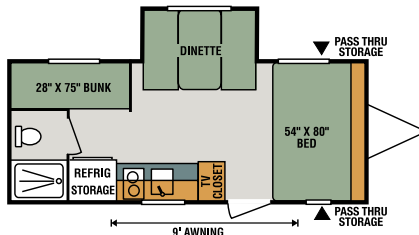

181BH

Travel Trailers

	130RB	150RBT	160QB	160RBT	160TH	180BH	180QB	180RBT	180TH	180THT	181BH
UVW (Unloaded Vehicle Weight)*	2,126	2,300	2,740	2,696	2,530	2,623	2,713	3,116	3,210	3,330	2,840
Dry Hitch Weight*	323	320	376	336	400	346	336	426	440	410	370
Dry Axle Weight*	1,803	1,980	2,364	2,360	2,130	2,277	2,377	2,690	2,770	2,920	2,470
NCC (Net Carrying Capacity)	674	500	760	804	1,470	877	787	1,384	1,790	1,670	660
GVWR	2,800	2,800	3,500	3,500	4,000	3,500	3,500	4,500	5,000	5,000	3,500
Interior Height	78"	78"	78"	78"	78"	78"	78"	78"	78"	78"	78"
Exterior Height w/o Roof A/C (unless noted)**	107"	107"	107"	107"	107"	107"	107"	118"	107"	107"	112"
Exterior Width	84"	84"	90"	90"	90"	84"	90"	90"	90"	90"	84"
Exterior Length	15' 10"	17' 2"	21' 10"	18' 10"	19' 4"	20' 6"	21' 10"	21' 3"	21' 7"	21' 7"	20' 6"
Refrigerator (cu. feet)	3	3	4	4	3	4	4	6	4	4	4
Water Heater Cap. (gal. LP w/DSI)	6	6	6	6	6	6	6	6	6	6	6
Fresh Water Cap. (gal.)	20	20	20	20	38	20	20	20	38	38	20
Waste Water Cap. (gal.)	9	9	32	24	5	9	32	24	32	32	9
Gray Water Cap. (gal.)	15	15	32	32	26	15	32	32	32	32	15
LP Gas Cap. (lbs.)	20	20	20	20	20	20	20	20	20	20	20
Furnace BTUs (1,000s)	20	20	20	20	20	20	20	20	20	20	20
Tire Size	13"	13"	14"	14"	15"	14"	14"	13"	15"	15"	14"
Awning	9'	11'	10'	12'	12'	9'	10'	13'	13'	13'	9'

*This weight reflects the rolling average unit weight for each model. Your trailer weight will vary according to optional equipment. **This exterior height is **with roof A/C**.



985 N 900 W • Shipshewana, IN 46565
E-mail kz@kz-rv.com • www.kz-rv.com

Due to continual research and advances, manufacturer reserves the right to change specifications, design, price and equipment without notice, and assumes no responsibility for any error in this literature. Some items shown are not included as standard or optional equipment. ©2017KZ | 8/30/17 | 15M