

# ESCAPE

Ultra Lightweight Travel Trailers

## 2018 Décor



*Fossil*

### Standards

- Alum-a-Tough® Roofing w/12-Year Limited Warranty
- Tinted Windows
- R-7 Insulation
- Diamond Plate Rock Guard
- Rear Bumper w/Sewer Hose Storage
- Self-Adjust Electric Brakes
- Radial Tires
- 20# LP Bottle
- Cable Hookup
- City Water Fill
- Digital TV Antenna
- 12V Converter w/Charger
- 6 GAL LP DSI Water Heater
- Monitor Panel
- Linoleum Throughout
- 2-Burner Cooktop
- Microwave
- 4 CU FT LP/Electric Refrigerator (E160RBT, E161RB, E180QB, E180TH, E181RB, E191BH)
- 6.3 CU FT Double-Door Refrigerator (E180RBT, E191SS, E201RB, E231BH)
- Amish-Crafted Rustic Maple Cabinets
- Rail-Style Cabinet Doors w/Modern Handles
- Overhead Cabinets
- LED Interior Lighting
- Shower & Toilet

### Options

- 13,500 BTU A/C Low Pro (required on 180RBT, 191SS, 201RB, 231BH)

- U-Dinette IPO STD Dinette (161RB, 181RB, 191BH)
- 6.3 CU FT Refrigerator (required on 180RBT, 191SS, 201RB, 231BH ... must option roof A/C)
- 24" LED TV w/Inside/Outside Bracket (E180QB, E181RB, E191BH)
- (2) Aluminum Wheels (N/A 180RBT, 201RB, 231BH)
- (4) Aluminum Wheels (180RBT, 201RB, 231BH)
- Murphy Bed w/Sofa (patent pending) (E201RB)
- Wireless Backup Camera System - Observation
- Front Window (required, N/A on E160RBT, E180RBT)
- Bedspread (N/A E160RBT, E180RBT)
- Motion Security Sensor for Smart Arm Awning
- Wind Sensor for Smart Arm Awning

### Off-Road Package

- Aluminum Rims w/15" Mud Tires
- Extra Ground Clearance
- Electronically-Controlled Heated Holding Tank
- Double Entry Step (select models)

### K-Z Advantage Package (mandatory option)

#### Exterior

- New Front Profile w/78" Interior Walls
- 5/8" Tongue & Groove Plywood Floor
- 8,000 BTU A/C
- Power Awning w/LED Light Strip
- Key-Alike Program for Baggage & Entry Doors
- Aqualon Edge® Tent Material

- Folding Grab Handle
- Exterior Speakers
- Spare Tire & Carrier
- (4) Scissor-Style Stabilizer Jacks
- Solar Prep
- Backup Camera Prep
- Nitrogen-Filled Tires

#### Interior

- 20,000 BTU Furnace
- Seamless Countertops
- Plywood Bed Base
- (2) 6 ½" Interior Speakers
- Digital Media Stereo w/Bluetooth & 12V Dual USB Ports

### K-Z Convenience Package (mandatory option)

#### Exterior

- Smart Arm Awning w/Exterior Controls
- Friction Hinge Entry Door
- Double entry steps (select models)
- Omnidirectional HDTV Antenna

#### Interior

- Armstrong ToughGuard® Linoleum
- Rail-Style Cabinet Doors
- Interior Control Switches on OH End Cabinet

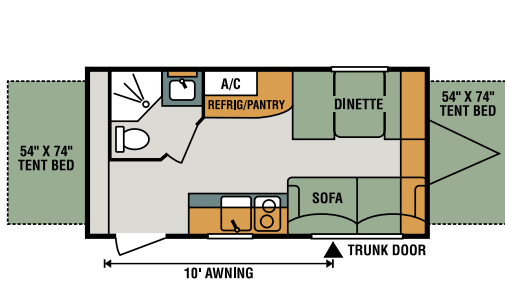

**E160RBT**

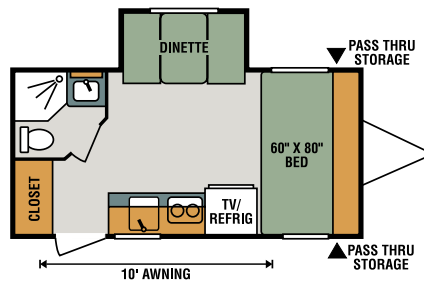

**E161RB**

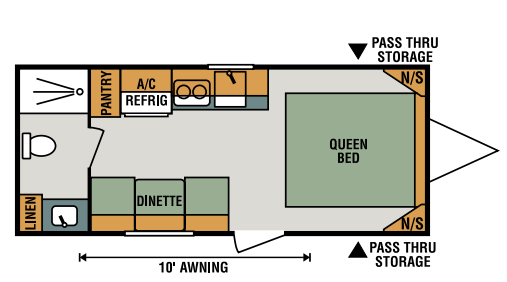

**E180QB**

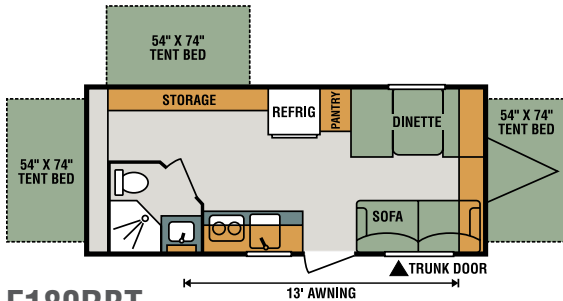

**E180RBT**

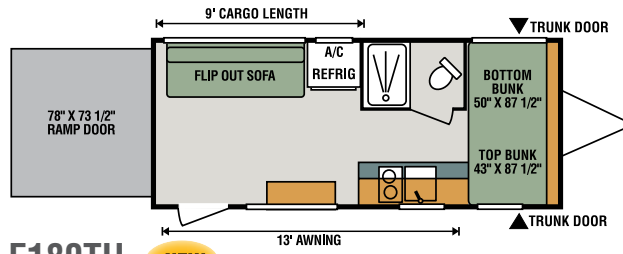

**E180TH** NEW

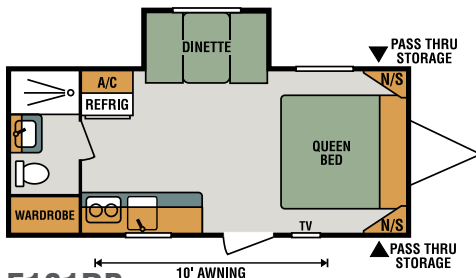

**E181RB**

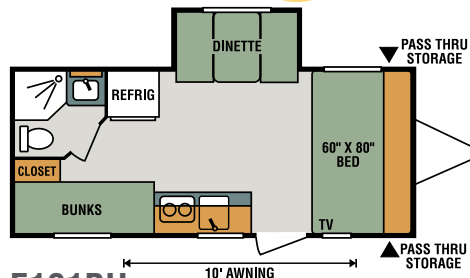

**E191BH**

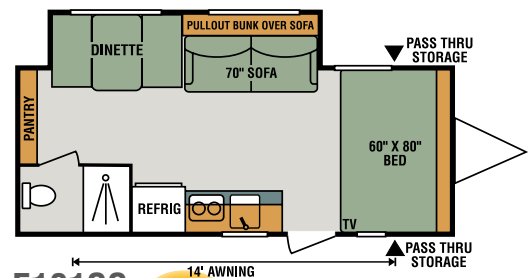

**E191SS** NEW

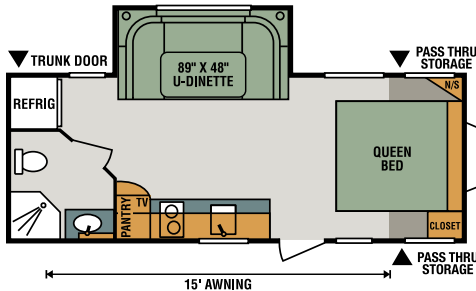

**E201RB**

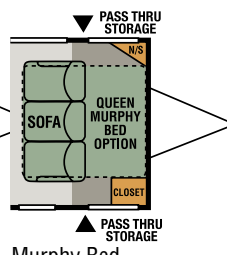

**E231BH**

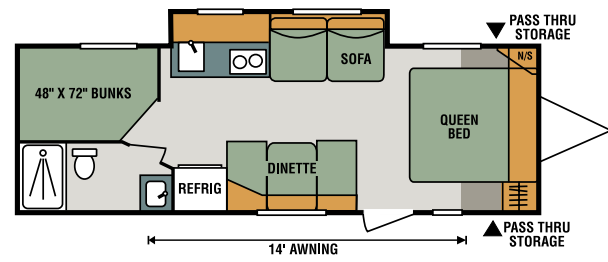

**E231BH**

Murphy Bed  
(patent pending) Opt.

Travel Trailers	E160RBT	E161RB	E180QB	E180RBT	E180TH	E181RB	E191BH	E191SS	E201RB	E231BH
UVW (Unloaded Vehicle Weight) *	2,690	2,735	2,940	3,220	3,290	3,099	3,233	3,530	3,530	3,760
Dry Hitch Weight*	350	385	490	420	460	445	446	490	370	540
Dry Axle Weight*	2,340	2,350	2,450	2,800	2,830	2,654	2,787	3,040	3,160	3,220
NCC (Net Carrying Capacity)	810	765	560	1,280	1,710	901	767	1,470	970	740
GVWR	3,500	3,500	3,500	4,500	5,000	4,000	4,000	5,000	4,500	4,800
Interior Height	78"	78"	78"	78"	78"	78"	78"	78"	78"	78"
Exterior Height w/o A/C (unless noted)**	107"	112"	107"	118"	107"	112"	112"	118"	118"	118"
Exterior Width	90"	90"	90"	90"	90"	90"	90"	90"	90"	90"
Exterior Length	18' 10"	19' 8"	21' 10"	21' 3"	21' 7"	21' 11"	21' 11"	23' 8"	23' 10"	27' 3"
Refrigerator (cu. feet)	4	4	4	6	4	4	4	6	6	6
Water Heater Cap. (gal. LP w/DSI)	6	6	6	6	6	6	6	6	6	6
Fresh Water Cap. (gal.)	20	20	20	20	38	20	20	38	20	20
Waste Water Cap. (gal.)	24	32	32	24	32	32	32	32	31	24
Gray Water Cap. (gal.)	32	32	32	32	32	32	32	32	31	31
LP Gas Cap. (lbs.)	20	20	20	20	20	20	20	20	20	20
Furnace BTUs (1,000s)	20	20	20	20	20	20	20	20	20	20
Tire Size	14"	14"	14"	13"	15"	15"	15"	15"	13"	13"
Awning	10'	10'	10'	13'	13'	10'	10'	14'	15'	14'

\*This weight reflects the rolling average unit weight for each model. Your trailer weight will vary according to optional equipment. \*\*This exterior height is **with A/C**.



985 N 900 W • Shipshewana, IN 46565  
E-mail [kz@kz-rv.com](mailto:kz@kz-rv.com) • [www.kz-rv.com](http://www.kz-rv.com)

Due to continual research and advances, manufacturer reserves the right to change specifications, design, price and equipment without notice, and assumes no responsibility for any error in this literature. Some items shown are not included as standard or optional equipment. ©2017KZ | 8/31/17 | 15M