

# 1500 DURANGO

Lightweight Luxury Fifth Wheels



2017 Décor

Alabaster



Aurora



Driftwood



## CONSTRUCTION FEATURES

- 6-Sided 100% Aluminum Frame
- Steel Powder Coated Frame
- R-11 2" Block Foam Bonded Sidewalls w/EGS Metal Backing Strips (to support all int. cabinets)
- Lamilux® High-Gloss Fiberglass
- One-Piece ABS Slideroom Bottoms; Slideroom Floors Insulated
- Additional Outside Frame-to-Wall Floor Insulation
- Walk-On Superflex® TPO Roof Membrane
- 5/8" Tongue & Groove, Screwed & Glued Plywood Floor Decking
- Fully-Vented Attic System
- Completely Heated Water System
- Pex® In-Floor Heated Waterlines & Kitchen Gray Pipes (all waterlines & drainlines are located above all insulation)
- Fully Heated & Enclosed Underbelly
- Reinforced Heavy-Duty Fiberglass Front Cap (w/maximum turning radius on short bed trucks)
- 6' 2" Tall Main Floor Sliderooms & 4' Tall Bedroom Sliderooms
- Double-Insulated & Heated Holding Tanks (R-38 above & below tanks)
- All Weather Insulation PKG (forced option) (upgrades roof, floor, ceiling, endcaps & tanks to R-38)

## EXTERIOR FEATURES

- Dexter® Axles w/Self Adjusting Brakes & Height Adjusting Hangers
- 6-Lug Heavy-Duty Aluminum Rims w/ Nitro Filled Tires

- Equa-Flex® Rubberized Suspension
- 100% Exterior LED Running Lights & Taillights
- LED Front Docking Light & Sewer Hookup Light
- LED Entry Door Floodlight
- Carefree® Electric Awning w/Directional LED Light Kit (at end of awning, w/ interior reminder switch)
- Electric Front Jacks
- Propane Bottles on Same Side of Coach for Easy Access (2 x 30 lb.)
- Painted Front Cap
- Frameless Windows
- 3" x 14" Foam-Core In-Floor Straight-Line Heating System w/35,000 BTU Furnace
- 15,000 BTU Ducted Roof AC
- Heated Water Convenience Center (incl. black tank flush, power fresh tank water fill, winterizing system, outside shower)
- Fully-Finished, Heated & Sealed Basement Storage Compartment
- Heated & Enclosed Dump Valves
- 6 GAL Gas/Electric/DSI Water Heater
- Swing-Away Assist Grab Handle
- Roof Ladder
- No-Slide Rubberized Basement Flooring
- Dual Lock Basement Storage Slam Latches
- Satellite Pre-Wire (roof & ground)
- Outside Speakers & Pre-Wire for Exterior TV
- Battery Disconnect
- Full-Perimeter Rain Gutter System (incl. rear & additional gutters over sliderooms)

## EXTERIOR OPTIONS

- 50 AMP Service & Pre-Wire for 2nd AC (STD on 281 and 292)
- Generator Prep & OPT Onan® 5500 LP Generator (must add 50 AMP service & 2nd AC pre-wire)
- Tailgate Storage System w/Bike Rack
- Rear Electric Jacks
- Dual-Pane Frameless Windows
- 4-Point Automatic Leveling System (N/A 251) (must OPT multi-function touch panel if leveling system is ordered)
- Reese® Revolution Hitch Pin

## LIVING ROOM/KITCHEN FEATURES

- Solid Surface Kitchen Countertops & Sink Covers w/Large Handholds
- Residential Stainless Steel Double Bowl Sinks
- Pullout Sprayer Faucet
- Storage Shelf under Kitchen Sink
- Heavy-Duty 100 LB Drawer Glides on Every Drawer
- Baltic Birch Drawer Boxes
- 8 CU FT Double-Door Refrigerator
- High-Output Oven w/Broiler
- 22" Microwave
- Kitchen Window (most models)
- All-Wood Lumber Core Screwed Cabinets w/Hardwood Doors
- 5" Stainless Steel Cabinet Hardware
- 3/8" Re-Bond Carpet Pad w/22 OZ Residential Carpet Throughout
- XL Toggle Light Switches
- Faux Vinyl Ceiling

- Large Ceiling Crown Molding
- All LED Ceiling & Cabinet Lights w/Multiple On/Off Switches
- Deluxe Residential-Style Furniture
- 12V Entertainment System (Radio) w/Bluetooth & 2 Zones of Speakers
- HD Flat Panel TV
- Pullout Pantry (where available)
- All Kitchen OH Cabinets have Shelf & Extra-Tall Slide Lips
- Wood-Top Booth Dinette Tables
- 4" High Density Foam Cushions on all Booth Dinettes
- Dual Pots & Pans Drawers in all Booth Dinette Seats

## LIVING ROOM/KITCHEN OPTIONS

- Power Vent Fan w/Wall Controls (kitchen, living room, bath, bedroom)
- Upgraded Wraparound Sofa-Booth (255 & 259)
- Free Standing Table w/Leaf & 4 Chairs (N/A 259, 255)
- Theater Seating (259, 277, STD on 281)
- Dual Recliners IPO Swivel Chairs
- Deluxe Sleeper Sofa IPO Jiffy Sofa (STD on 281)
- Electric Fireplace (N/A 255 & 277, STD on 281)

## BATHROOM/BEDROOM FEATURES

- Angled Shower Stall w/Radius Doors
- Shower Skylight
- Porcelain Foot-Flush Toilet
- All LED Lights in Bed & Bath w/Multiple Large Switches

- 12V Vent Fans in all Baths
- Heavy-Duty 100 LB Drawer Glides on all Drawers
- Bathroom Linen Closet (where available)
- Padded Headboard w/Shelf & Power at the Head of all Beds
- XL Under-Bed Storage
- Luxurious Bedspread & Pillow Shams
- Linen Closet Shelves, Dual Drawers & Hanger Area in all Bedroom Sliderooms
- Bedroom TV Pre-Wire

## BATHROOM/BEDROOM OPTIONS

- Ducted 13,500 BTU Bedroom AC (must add 50 AMP service & 2nd AC pre-wire)
- Upgraded Mattress
- HD Flat Panel Bedroom TV w/Swingout Bracket

## BONUS FEATURES

- 2-Year Limited Warranty (see flyer)
- K-Z has received the Dealer Satisfaction Index Award for 16 years
- K-Z's 44 years of stable, dedicated manufacturing experience, coupled with its predominant Amish workforce, heritage and commitment to superb quality, allow us to produce the lowest-priced luxury fifth wheel available.

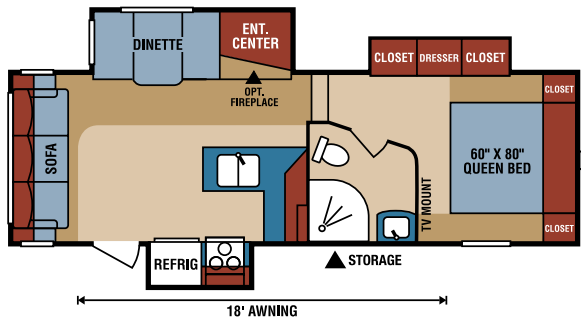

**D251RLT**  
 UVW 7,560  
 Dry Hitch Wt. 1,420  
 NCC 1,940  
 GVWR 9,500  
 Length 27' 10"

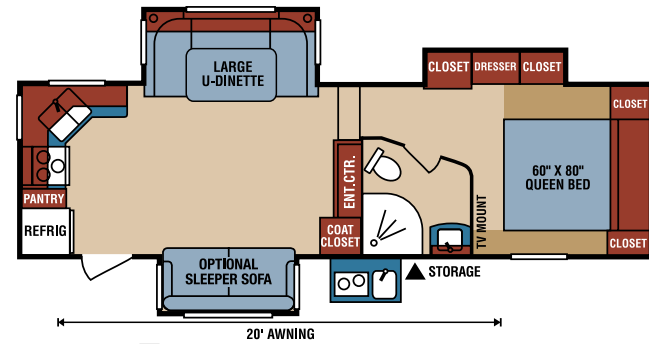

**D255RKT**  
 UVW 8,250  
 Dry Hitch Wt. 1,300  
 NCC 1,750  
 GVWR 10,000  
 Length 29' 11"

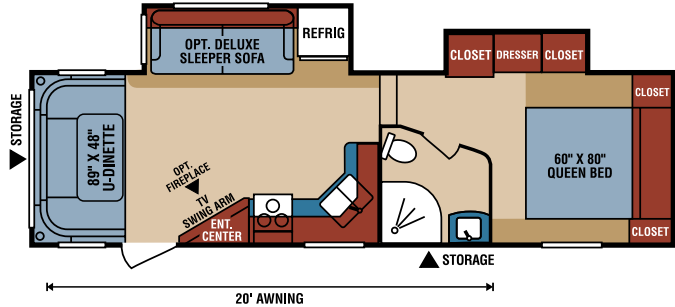

**D259RDD**  
 UVW 7,600  
 Dry Hitch Wt. 1,200  
 NCC 2,400  
 GVWR 10,000  
 Length 29' 11"

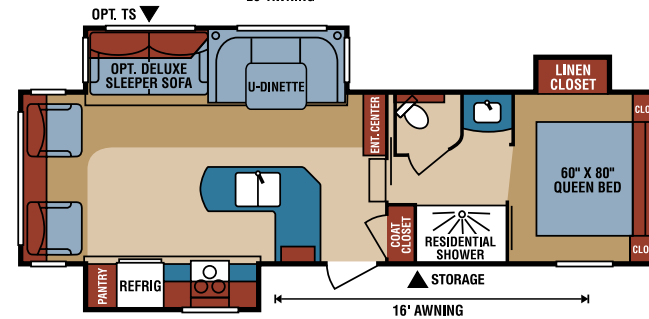

**D277RLT**  
 UVW 8,350  
 Dry Hitch Wt. 1,408  
 NCC 2,150  
 GVWR 10,500  
 Length 31' 8"

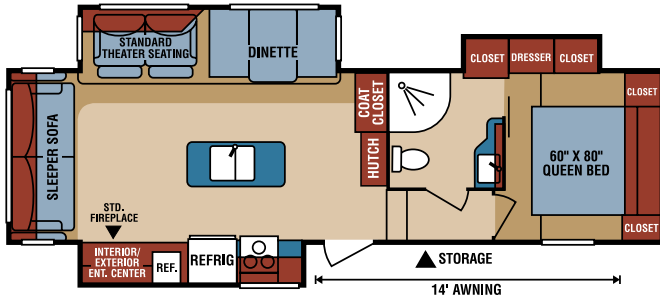

**D281RLT**  
 UVW 8,510  
 Dry Hitch Wt. 1,490  
 NCC 1,990  
 GVWR 10,500  
 Length 32' 8"

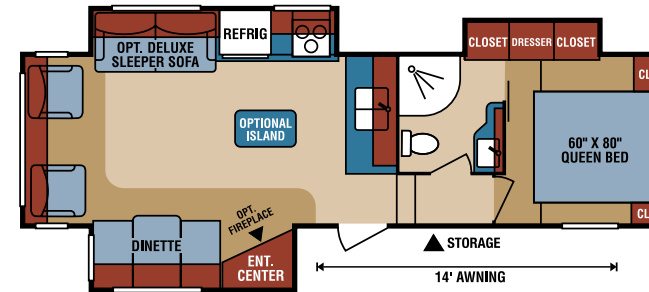

**D284RLT**  
 UVW 8,160  
 Dry Hitch Wt. 1,480  
 NCC 2,340  
 GVWR 10,500  
 Length 31' 11"

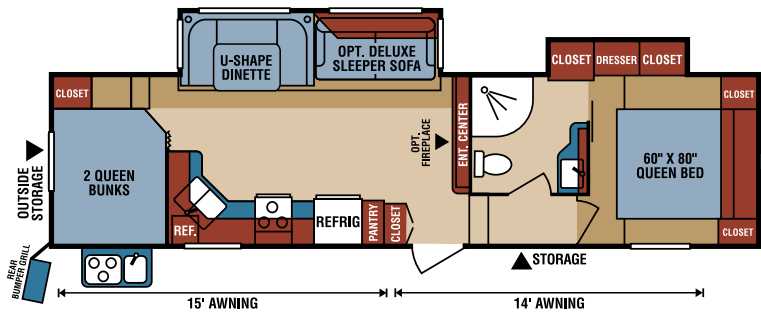

**D286BHD** UVW 8,490 • Dry Hitch Wt. 1,700 • NCC 2,010 • GVWR 10,500 • Length 33' 11"

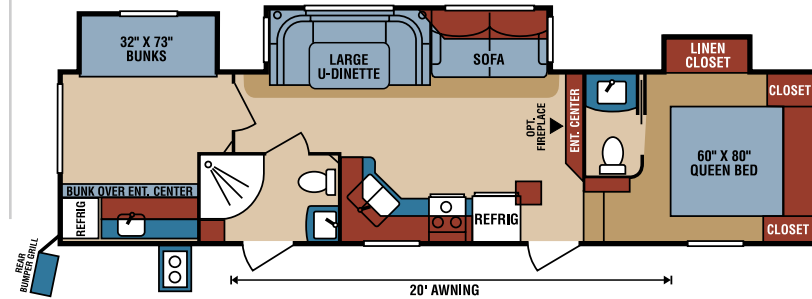

**D292BHT** UVW 9,430 • Dry Hitch Wt. 1,410 • NCC 2,070 • GVWR 11,500 • Length 35' 11"



985 N 900 W • Shpshewana, IN 46565  
 E-mail [kz@kz-rv.com](mailto:kz@kz-rv.com) • [www.kz-rv.com](http://www.kz-rv.com)

**NOTE:**  
 UVW (Unloaded Vehicle Weight) and Dry Hitch Weight reflect the rolling average unit weight for each model. Your trailer weight will vary according to optional equipment.

Due to continual research and advances, manufacturer reserves the right to change specifications, design, price and equipment without notice, and assumes no responsibility for any error in this literature. Some items shown are not included as standard or optional equipment. ©2016KZ | 9/9/16 | 2.5M