

ESCALADE SPORTSTER PREMIUM TOY HAULERS



ESCALADE SPORTSTER

PURSUE YOUR PASSION





LIVING ROOM | **40SBS**
40SBS shown with optional custom dinette.



KITCHEN

Optional ice maker with water dispenser shown.



The spacious kitchen of the 40SBS features an under mount stainless steel sink, swing out storage and Corian® counter tops.

BED & BATH



All Escalade Sportsters feature a bedroom retreat with ample hanging storage, 19" LCD TV and designer bedding package. This bedroom will be your place to get away from it all.

CABERNET



NAPLES



SABLE



INTERIOR

INTERIOR FEATURES

- Glazed Solid Cherry or Maple Wood Choices
- All Cabinets Pre-Drilled and Screwed with Hidden European Style Hinges
- High Gloss Corian® Countertops/Kitchen and Lavatory
- Stainless Steel Recessed Sink with Corian® Sink Covers
- Exclusive "One Touch" Night Shades

APPLIANCES AND ELECTRONICS

- 12 Cu. Ft. Side x Side Refrigerator with Solid Cherry or Maple Wood Front
- 30" Residential Stainless High Line Over the Range Microwave
- Pre-Wired for Satellite System

FURNITURE

- Residential Style Sofa with Air Mattress by Williamsburg
- "Flex Comfort" Bed Spring

ELECTRICAL

- Back-Lit Switches at Entry Door
- Convenient Electrical Command Center
- Fluorescent Lighting in Living Areas
- Halogen Accent Lighting with Dimmer
- Power Eclipse Awning with Alumiquard Protector
- 50 AMP Power Service with Detachable Cord

HEAT/VENTILATION A/C

- 15,000 Low Profile A/C
- 42,000 BTU Furnace
- Preparation for 2nd A/C in Bedroom

PLUMBING SYSTEM

- Large One Piece Fiberglass Corner Shower with Self Storing Shower Door
- Porcelain Toilet with Sprayer

EXTERIOR

BODY AND FRAME CONSTRUCTION

- All Aluminum Double Welded Cage Frame
- Gel Coat High Gloss Fiberglass Exterior Sidewalls
- Premium Quality Painted Exterior Graphics
- 8 Lug HD Aluminum Wheels
- Roof Ladder
- (2) 40 lb. LP Bottles
- Tinted Skylight at Shower Area
- 18" "Box" beam/"I" Beam Stack Chassis

STANDARD EQUIPMENT

- Soft Touch Padded Ceiling
- Mirrored Entry with Grandfather Clock
- Designed Window Treatments with Fabric and Wood Features
- Solid Wood Interior Assist Handle
- Waste Basket Accommodations in all Kitchens
- Designer Inspired Bedding with Deluxe Bedspread and Pillow Shams

- 32" Sony® LCD HDTV in Living Area
- Sony® "Dream System" Surround Sound
- Sony® DVD Player
- 22" Broiler Oven with Stainless Steel Front and 3-Burner Cook Top

- 80" Pillow Top Mattress
- Freestanding Dining Room Table with Fold-Up Leaf, Tilt-Up Storage and Silverware Drawer

- 65 AMP Power Converter
- Recessed Entry Step Light
- Porch Light
- Telephone Jack at Recliners and Entertainment Area
- Designer Accent Light Package
- LED Running/Brake/Turn Signals

- (3) Shur-Flo Thermostat Controlled Ventilation Fans with Rain Sensor
- In Floor Ducted Heat System

- (16) Gallon Gas/Electric Hot Water Heater
- Black Tank Flush System
- Heated Fresh, Grey, and Black Water Tanks

- 16" G-Rated Tires
- G-Rated Spare Tire with Hoist
- Independent Power Front Jacks with Snap Pins
- Power Rear Stabilizer System
- 7,000 lb. Axles with Easy Lube Hubs
- MOR/ryde Suspension System
- Fold-Out Entry Grab Handle
- 30" Entry Door

- Brushed Nickel Cabinet Hardware
- Ball Bearing Full Extension Drawer Guides
- Solid Wood 6 Panel Commode Room and Living Area Door
- Corian® Bi-Fold Range Cover/Flush Mounted
- Solid Wood Crown Molding
- Solid Wood Vanity and Medicine Cabinet in Bath Area

- 19" LCD TV in Bedroom
- Dirt Devil® Central Vacuum with Built-In Dust Pan
- TV Antenna

- Two High Back Solid Wood Dining Chairs and Two Folding Solid Wood Dining Chairs

- High Output Back-Up Lights
- 4 Exterior Security Lights
- 12 Volt Deep Cycle Battery
- 120 Volt Exterior Outlet
- Hitch Light
- 12 Volt Battery Disconnect

- Solid Wood Furnace Return Air Cover
- Ducted A/C Supply and Return

- Exterior "Hook-Up" Center with Cable, Water and Phone Connections Along with an Exterior Shower.
- Winterization Package

- 5/8 Tongue and Groove Plywood Floor Decking
- Fully Enclosed Underbelly
- Tinted Windows with Safety Glass
- 1/2" Plywood Roof Decking
- Fiberglass Front Cap
- Pass-Through "Basement" Storage
- Nev-R-Adjust Brakes

ADDITIONAL OPTIONS

- Stackable Washer Dryer in Cargo Area with Cabinet
- Fireplace (n/a 40SBS)
- 2nd 13.5 A/C in Bedroom
- 3rd A/C in Cargo
- Heat Pump Upgrade (Per Unit)
- Convection Microwave
- Ice Maker (with Water Dispenser in Door)
- King Size Bed
- Infinity Ceiling Light
- Door Bell
- Custom Dinette ILO Table and Chairs (40SBS)
- Voyager Back Up Camera
- Onan 5.5 Generator
- Disc Brakes (Includes 7K Axles with Neverlube)
- Dual-Pane Windows
- Automatic Satellite
- Trail Air Hitch
- Slide Out Cover
- Wind Sensor
- Roll Out Tray
- 2nd Battery
- Full Body Paint Package
- Sony® Xplod Cargo Audio



ESCALADE
SPORTSTER

GARAGE AREA FEATURES

- Fuel Cell with Pump Station
- Generator Prep
- 2nd Entrance Door in Cargo Area
- Tuff-Ply® on Cargo Floor
- 2' Diamond Plate on Sidewalls
- Ramp Extension
- Threshold Ramp
- 3 Tie Down Rails
- Pull Down Screen Wall
- Battery Charger/Power Pack/Air Compressor
- Bedroom Loft
- Fiberglass Rear Cap

CARGO BAY



With the standard pull down screen wall the Escalade garage can be your traveling patio.



The optional Sony® Xplod sound system will bring your favorite tunes to life.

FLOOR PLANS

□ LINOLEUM ■ CARPET ■ FURNITURE

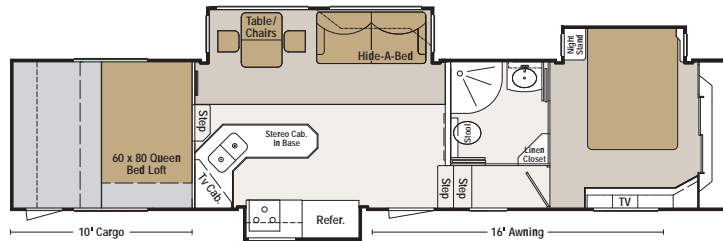

40SBS

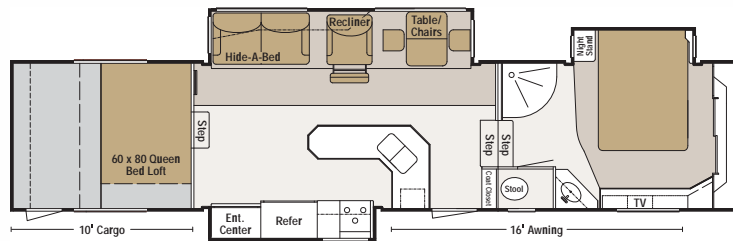

41CKS

	GVWR	Hitch Weight	Axle Weight	NCC	Axle
40SBS	21,000	3,620	12,850	4,530	(3) 7,000
41CKS	21,000	3,759	12,525	4,716	(3) 7,000

For your safety and satisfaction, 2009 Escalade Sportster fifth wheels are weighed during our final inspection process. Beginning with run number 245-6, each coach will have federally mandated NCC (net carrying capacity) placard placed in the coach. The chart above reflects coaches as typically equipped. The options you select will affect the weight of the coach and your carrying capacity.





One **less** thing to **worry** about.

Worry-free protection against unexpected repairs for new or pre-owned travel trailers, fifth wheels and toy haulers

■ Comprehensive coverage

■ Professional claims administration with over 25 years of experience

■ Protection throughout the United States and Canada

■ Special coverages

■ 24-hour roadside assistance benefits

■ Trip interruption benefits

■ Service call benefits

Administered by:

United Service Protection Corp. • **United Service Protection Inc. (In FL only)**
P.O. Box 20899, St. Petersburg, FL 33742-0899 • Toll-Free: 1-800-685-3034
Florida License #60016000 • © Assurant, Inc. 2008

ESCALADE SPORTSTER



0985 N 900 W • Shipshewana, IN 46565

E-Mail kz@kz-rv.com

www.kz-rv.com

Due to continual research and advances, manufacturer reserves the right to change specifications, design, price and equipment without notice, and assumes no responsibility for any error in this literature. Some items shown are not included as standard or optional equipment. ©2009KZ

1/1/09



Dealer:

Ask about our
2/5 Warranty

