

DURANGO GOLD



Full Time Luxury Fifth Wheels



Curry Décor



Earthen Décor



Espresso Décor

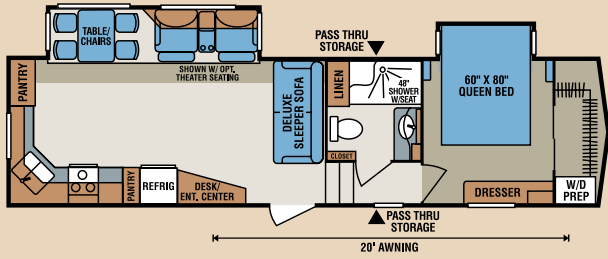

G353RKD UVW TBD • Dry Hitch Wt. TBD
NCC TBD • Length TBD

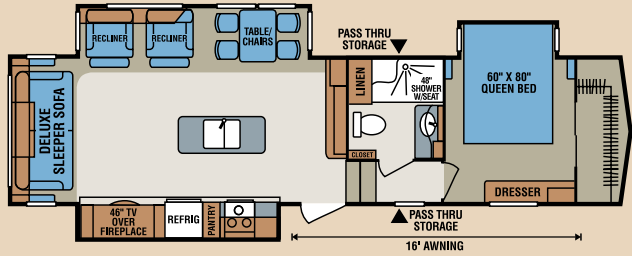

G355RLT UVW TBD • Dry Hitch Wt. TBD
NCC TBD • Length TBD

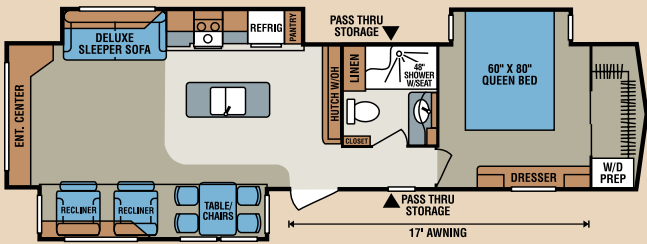

G359RET UVW TBD • Dry Hitch Wt. TBD
NCC TBD • Length TBD

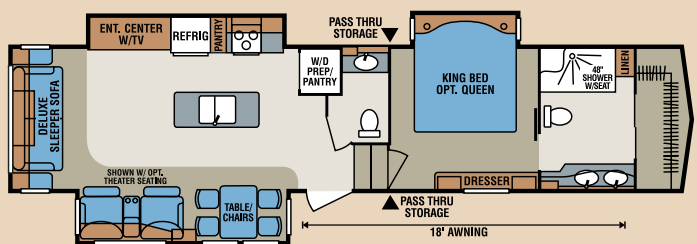

G366FBT UVW TBD • Dry Hitch Wt. TBD
NCC TBD • Length 39' 6"

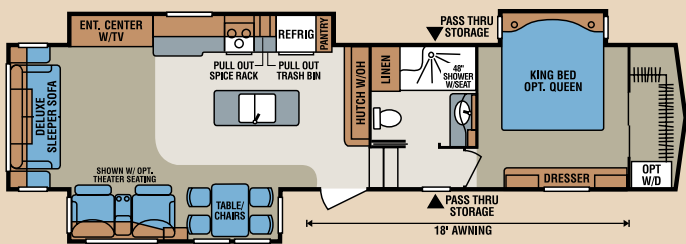

G370RLT UVW 11,686 • Dry Hitch Wt. 2,250
NCC 2,814 • Length 39' 6"

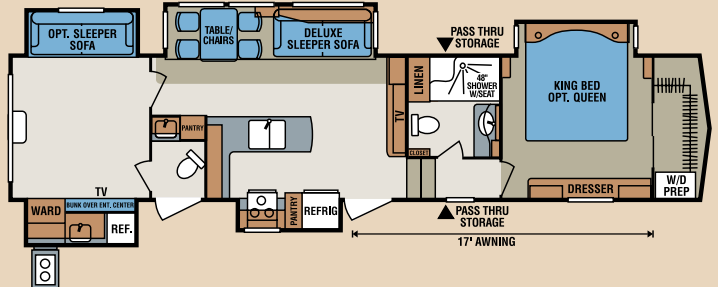

G372BHF UVW 13,040 • Dry Hitch Wt. 2,360
NCC 2,460 • Length 40' 5"

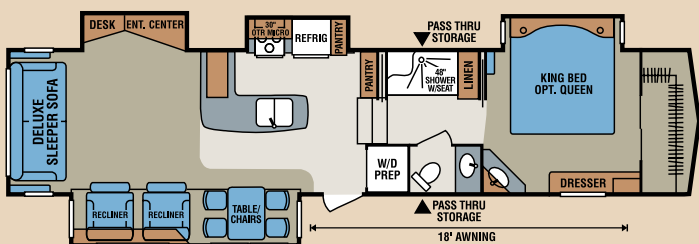

G374RLQ UVW TBD • Dry Hitch Wt. TBD
NCC TBD • Length TBD

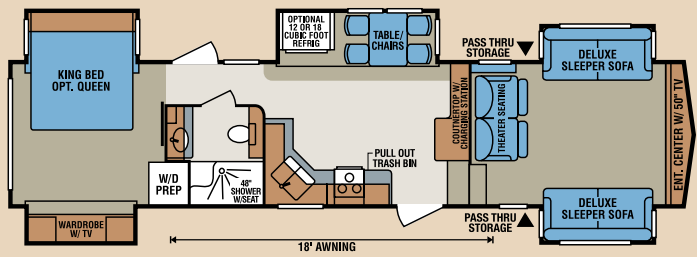

G380FLF UVW 12,136 • Dry Hitch Wt. 2,173
NCC 2,364 • Length 40' 6"

Construction Features

- 101" Wide body construction
- 6-Sided 100% aluminum frame
- Extra reinforced heavy duty front fiberglass cap
- Radius front cap for maximum turning radius on short bed trucks
- 2" x 3" Welded aluminum floor joist running fore & aft
- 2" x 2" Welded aluminum sidewall framing
- 5" Welded aluminum roof trusses
- Lippert® hydraulic slide system w/selector valves
- Steel powder coated I-beam w/drop-frame pass-through storage (160 CU FT of storage)
- Lamilux® gelcoated high-gloss ivory-colored fiberglass, including sides of all slides
- ALL WEATHER INSULATION PACKAGE (roof, floor, end caps, & tanks to R-38)
- R-11 2" sidewalls (w/EGS metal backing strips to hold up all interior cabinets)
- One-piece ABS slide room bottoms, slide room floors
- Walk-on Superflex® TPO roof membrane
- 45 Degree aluminum roof edge & fully vented attic system
- Additional outside frame-to-wall floor insulation
- 3/8" Roof deck decking, 5/8" tongue & groove screwed & glued plywood floor deck
- Full drop frame aluminum skirt on door side
- Pex® in-floor heated waterlines & kitchen gray pipes (note: all waterlines & drains are located above all insulation)
- Fully enclosed & heated underbelly
- Double insulated & heated holding tanks (R-38 above & below tanks)

Exterior Features

- 6-Point hydraulic auto leveling system (optional)
- 7000 LB Dexter® axles w/auto adjusting brakes & height adjusting hangers
- 8-Lug heavy-duty aluminum rims w/16" E-range radial tires
- EZ Flex® rubberized suspension

- 4-Step entry step w/LED light
- Roto-Flex® hitch pin
- 100% exterior LED running lights & tail lights (note: all running lights are on fiberglass walls, not in metal lower wrap)
- Carefree® electric awning w/LED light bar at end of awning w/lit interior reminder switch
- Touch remote for slides, awnings, exterior lighting & leveling
- Propane bottles on same side of coach for easy access
- Sealed battery storage compartment on side of coach (no battery boxes required)
- Dual front baggage doors w/slam latches
- Side slam baggage doors w/gas shock lifts & dual locks
- 50A Service w/marine power cord
- Painted front cap w/LED accent lights
- Frameless windows
- 15,000 BTU ducted roof AC w/prewire for optional ducted 13,500 BTU bedroom AC
- 3" x 14" Foam core in-floor straight line heating system w/35,000 BTU furnace
- 12 GAL gas/electric hot water heater
- Dual function LED bug & floodlight by entry door
- Led docking light & sewer hookup light
- Swing-away assist grab handle
- Underneath spare tire w/hoist
- Roof ladder
- Heated water convenience center (includes black tank flush, power fresh tank water fill, winterizing system, outside shower)
- Fully finished, heated & sealed basement storage compartment
- Camp table & patio chairs storage compartment
- Heated & enclosed dump valves & heated low point drains
- Battery disconnect
- Outside speakers & prewire for exterior TV
- Dedicated generator compartment
- Optional 2nd lighted power awning on door side slide room
- Optional tailgate storage system w/bike rack

- Optional dual pane frameless windows
- Optional Generator Prep & optional Onan® 5500 LP generator
- Optional 13,500 BTU ducted bedroom AC

Living Room/Kitchen Features

- Solid surface countertops w/flush-mounted sink covers
- Large residential stainless steel sinks
- Pullout high arching faucet
- Residential-style extra-large pullout kitchen trashcan (most models)
- Pullout spice rack (most models)
- Dual pullout pots & pans drawers
- Built-in silverware drawer
- Storage shelf under kitchen sink
- Adjustable shelves in pantry (most models)
- All kitchen overhead cabinets have shelve & extra-tall slide lips
- Heavy-duty 80 LB drawer glides on every drawer
- Baltic Birch drawer boxes
- LED lighted toe kicks on kitchen cabinets
- Flush-mount glass folding stove cover
- U.S. made large dining table w/removable leaf & 2 heavy-duty storage seat chairs/2 folding chairs
- Window in kitchen (most models)
- Hidden hinges on cabinet doors
- 5" stainless steel cabinet hardware
- Nightshades throughout coach
- 3/8" Re-bond carpet pad w/22 OZ residential carpet
- 30" Over the range microwave
- Extra-large light switches & ceiling fan
- Faux vinyl soft touch ceiling
- Maxxair® fan in kitchen w/wall controls
- Maxxair® fan in 2nd bath (366 & 372)
- Extra-large ceiling crown molding
- All LED ceiling & cabinet lights w/multiple on/off switches
- Deluxe residential style furniture w/throw pillows
- 39" – 50" HD LED TV on swing arm (w/built-in storage behind TV, most models)
- 12V Jensen® entertainment system (DVD/radio) w/Bluetooth, 4 living room speakers w/bass speaker

- Satellite prewire both in the convenience center & roof
- Dual residential swivel rocker recliners
- Deluxe hide-a-bed sofa in living room
- Optional 12 CU FT side-by-side RV refrigerator
- Optional theater seat IPO dual recliners
- Optional 18 CU FT 120V residential refrigerator w/1000 inverter
- Optional Maxxair® fan w/wall controls (bath & bedroom)
- Optional central vacuum system
- Optional fireplace w/remote
- Optional slide room awning cover package
- Optional 2nd lighted power awning on DS slide room

Bathroom/Bedroom Features

- One-piece fiberglass shower stall w/ built-in seat & glass doors

- Extra-large solid surface bathroom vanity w/stainless steel sink
- Porcelain foot flush toilet
- Extra-wide hall going up into bedroom & pocket door from hall to bathroom (most models)
- Multiple towel bars in the bathroom
- Power vent fans in all bathrooms w/power switch on wall
- Extra-large linen closet in every bathroom
- Extra-large, deep walk-in closet in bedroom
- 2-Piece washer & dryer prep in every model
- Extra-large under-bed storage
- Luxurious bedspread & pillow shams
- 32" HD flat panel bedroom TV & bedroom speakers
- 70" x 80" King size Cotton Cloud® memory foam mattress w/gel top

Bonus Features

- 2 year limited warranty (see flyer)
- Lightest high profile, wide body, luxury fifth wheel in the industry (average weight is 11,500 LBS)
- K-Z RV has won the coveted DSI award 14 years
- K-Z's 42 years of building experience, coupled with its stable and dedicated Amish workforce and commitment to superb quality and low overhead, allow us to produce the lowest-priced luxury fifth wheels available

** Due to continual research and advances, manufacturer reserves the right to change specifications, design, price and equipment without notice, and assumes no responsibility for any error in this literature.*

ALUMINUM SUPER STRUCTURE

6 SIDED ALUMINUM FRAMING

Total Aluminum Frame ... Plus Structure on ALL Durango Fifth Wheels! 100% 6-Sided Aluminum Framing – Tongue-&-Groove Plywood Roof & Floor Decking

- 2" x 2" Welded Aluminum Sidewalls
- 14" On-Center 2" x 3" Welded Aluminum Floor Joists
- 14" On-Center Welded Aluminum Roof Trusses
- Aluminum-Framed Bathroom Door Jams
- 5/8" Tongue & Groove Plywood Floor Decking
- 3/8" Roof Decking



Dealer Satisfaction Index: Ratings of manufacturers, by dealers, have consistently awarded K-Z top honors for excellence of design, reliability, overall quality and value, communications and dealer support.



Dealer:

ASK ABOUT OUR 2-YEAR LIMITED WARRANTY!



Join our Family Forum at www.kzfamilyforum.com

For more product details and in-depth information, visit us at www.kz-rv.com



985 N 900 W • Shipshewana, IN 46565
E-mail kz@kz-rv.com • www.kz-rv.com



Due to continual research and advances, manufacturer reserves the right to change specifications, design, price and equipment without notice, and assumes no responsibility for any error in this literature. Some items shown are not included as standard or optional equipment. ©2014KZ | 12/19/14 | 20M